



## AL-X3 Alarm contact

### 1. Compliant standards

IEC60947-5-1

### 2. Compliant certification

CE, RoHS

### 3. Major function

To be assembled with the circuit breaker to achieve signal indication over long distance for open/close status of the circuit breaker and alarm.

### 4. Technical data

Rated operation currents under different working voltages:

Table 1

Utilization category	Rated operating voltage V	Rated operating current A
AC-12	AC 415	3
	AC 240	6
DC-12	DC 130	1
	DC 48	2
	DC 24	6

Figure 1

Action characteristics: Figure 1 shows the wiring diagram for alarm contact.

When the alarm contact is open, terminals 91 and 94 is connected; When the alarm contact is closed, terminals 91 and 92 is connected. When the alarm contact is closed, and manually open with the handle, terminals 91 and 92 shall still be connected; when the alarm contact is closed, and the assembled circuit trip open due to error, terminals 91 and 92 shall be open, and terminals 91 and 94 shall be connected;

Life: Operating life of alarm contact is 10000 cycles.

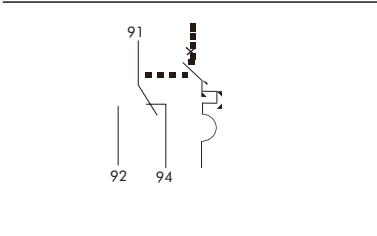

## 5. Assembly and installation of the product

AL-X3 can be assembled with NXB-125 series circuit breaker, with the assembly diagram shown below:

Figure 2

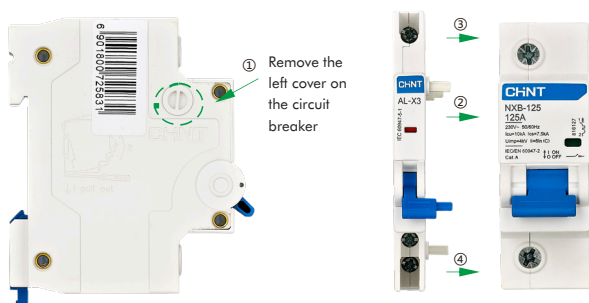

After AL-X3 is assembled with the circuit breaker, mount them on the TH3.5-7.5 steel mounting rail.

## 6. Dimensions and installation sizes

Figure 3

