

Beyond™

Susol MCCB

Molded Case Circuit Breakers

TS 1000, 1250, 1600A
Front Type



LSELECTRIC

TS 1000, 1250, 1600A

Front Type

[mm]

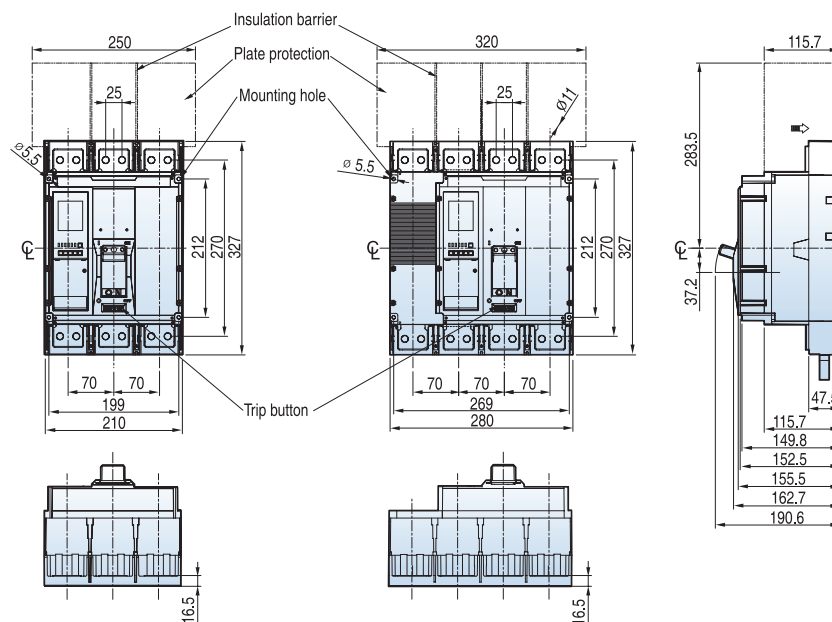

Panel drilling

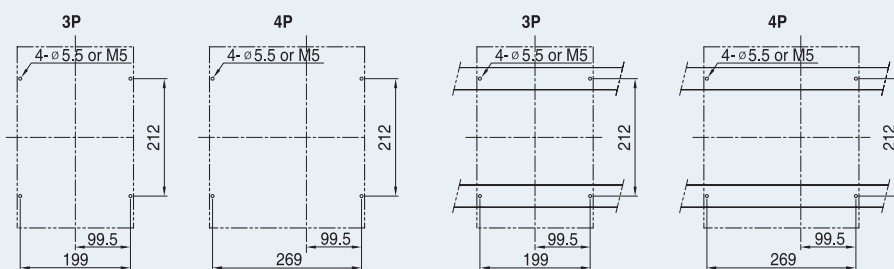

Front panel cutting

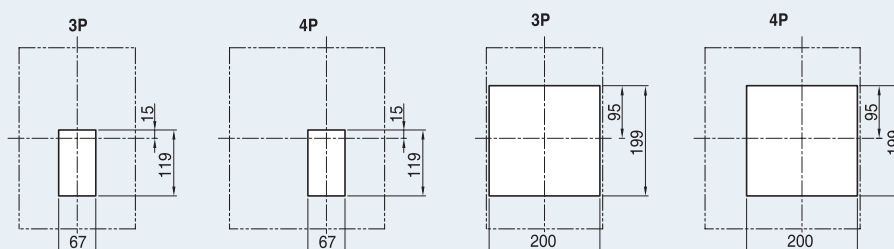

Overall dimensions

TS 1000, 1250, 1600A

Front Type Busbar

[mm]

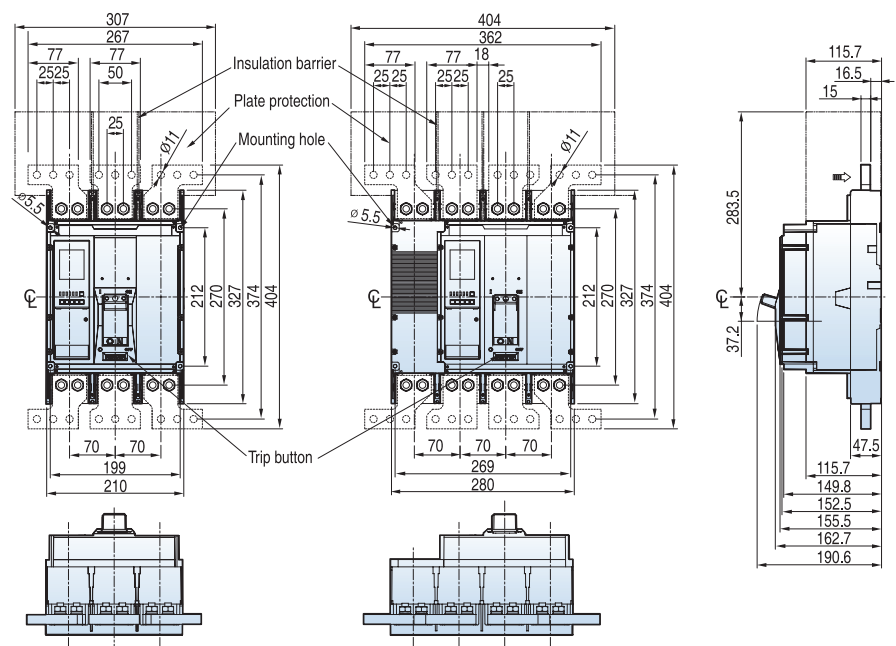

Panel drilling

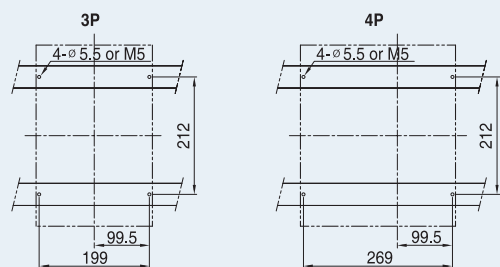

Front panel cutting

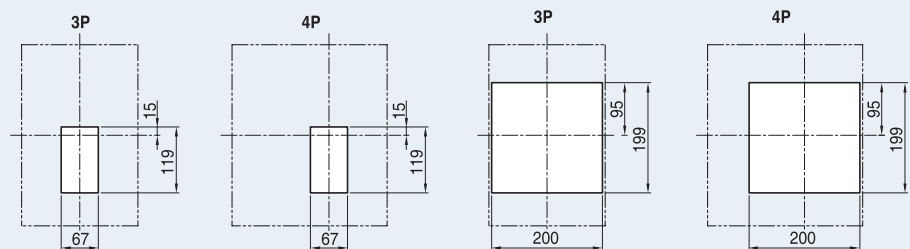

TS 1000, 1250, 1600A

Rear Type

[mm]

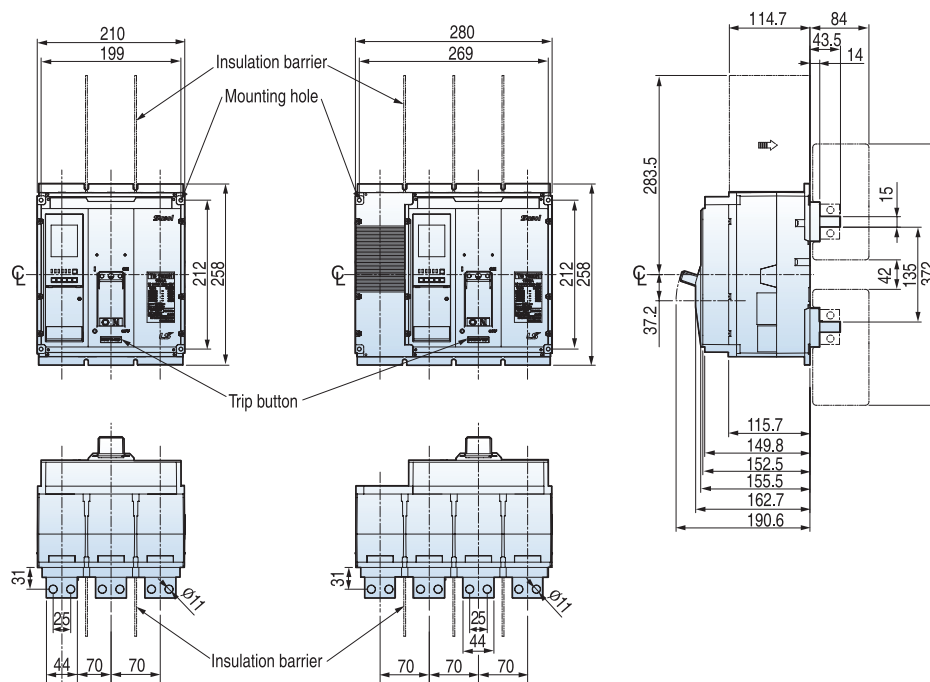

Panel drilling

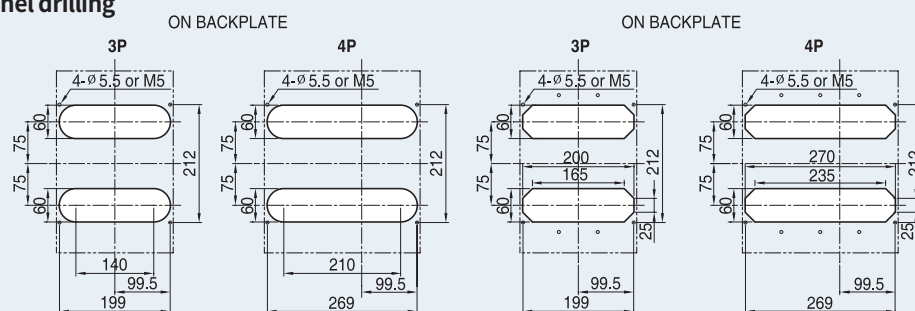

Front panel cutting

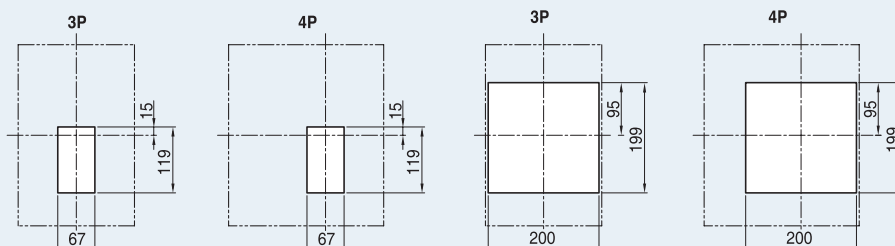

Direct rotary handles for TS 1600AF

110

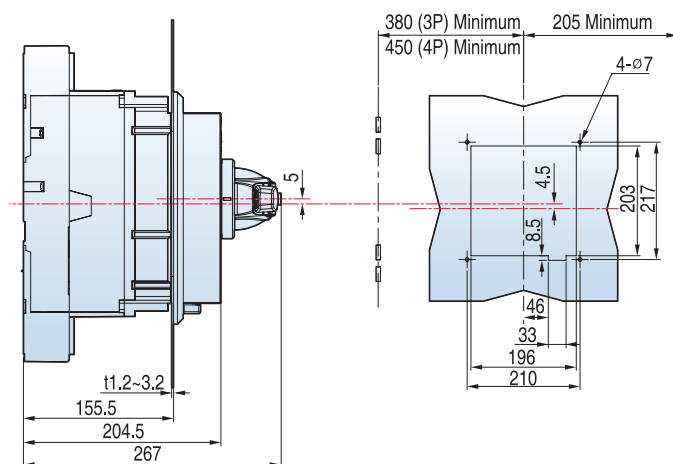

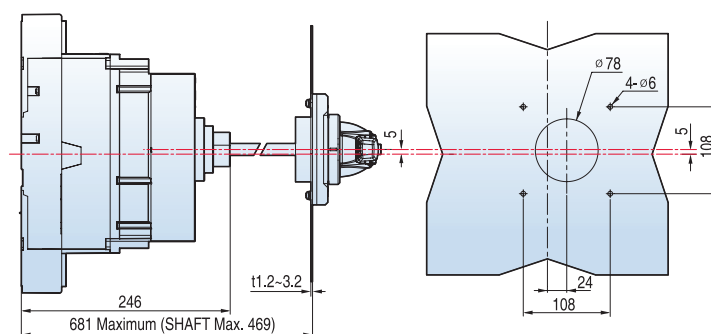
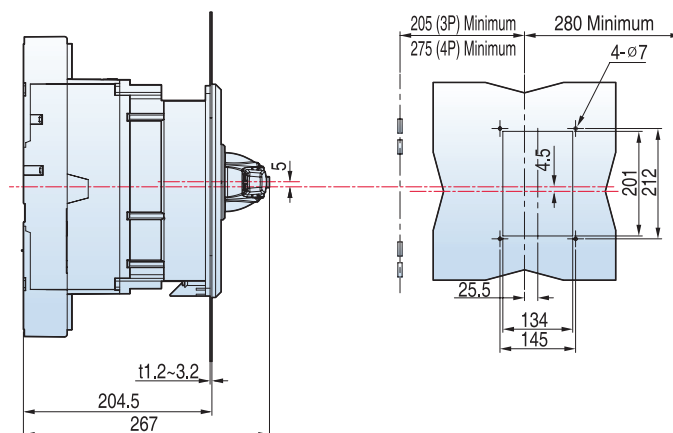

Locking devices

Mechanical interlock for TS 1600AF

[mm]

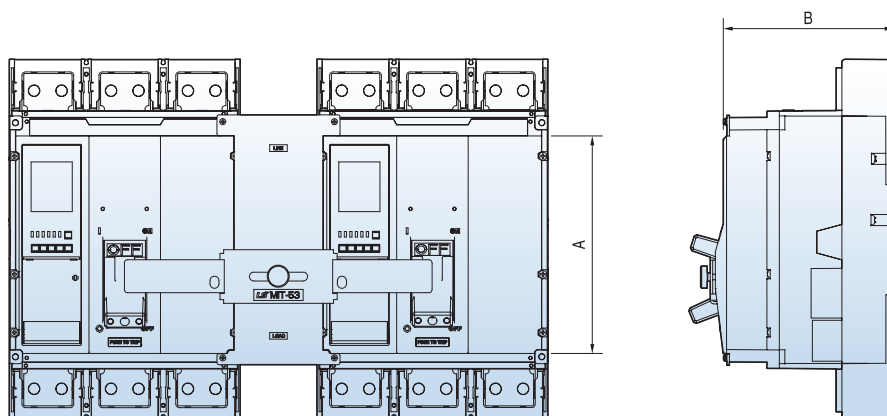

The cutting of Panel

3P	C	D	E
TS1600	212	81	199

4P	D	E
TS1600	11	269

The dimension of installation holes

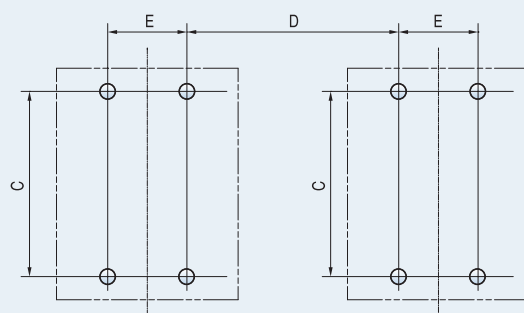

The cutting of Panel

3P	C	D	E
TS1600	212	81	199

4P	D	E
TS1600	11	269

[mm]

2-M10 Bolts

44

25

15

15

Technical drawing of a mechanical part showing front and side views with dimensions:

- Front View (Left):**
 - Overall width: 44
 - Distance between hole centers: 25
 - Hole diameter: $2 \times \varnothing 11$
 - Distance from top edge to hole center line: 18.5
 - Overall height: 60
 - Distance from bottom edge to hole center line: 12.8
 - Bottom flange width: 15
 - Bottom flange outer diameter: $\varnothing 38$
- Side View (Right):**
 - Overall width: 50
 - Distance from center line to hole center: 25
 - Hole diameter: $\varnothing 12 \text{ max.}$
 - Distance from bottom edge to hole center: 12.3

Left or right busbar for 4P

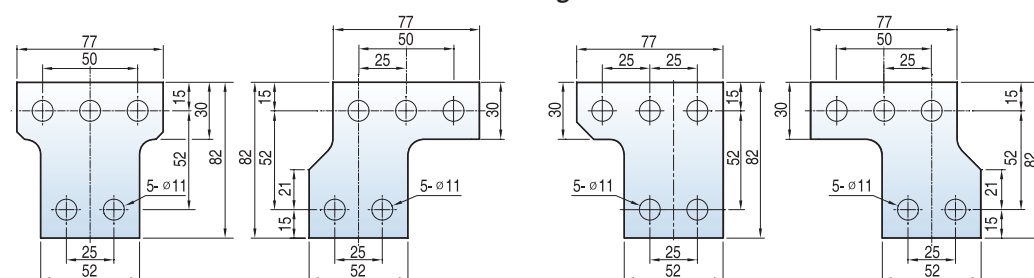

Terminals

Front or Rear connection with vertical busbar for TS1600

[mm]

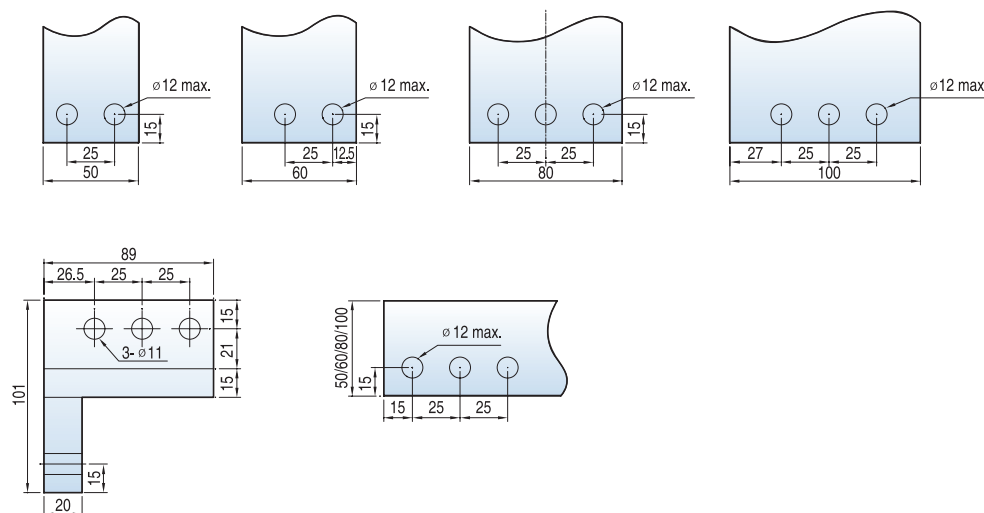

Extension Busbar

