

Turn Light

## RLA-WX/WXB

## INSTRUCTION MANUAL

Thank you for purchasing HANYOUNG product.  
Please check whether the product is the exactly same as you ordered.  
Before using the product, please read this instruction manual carefully.  
Please keep this manual where you can view at any time

HEAD OFFICE

INDONESIA  
FACTORY

## HANYOUNGNUX CO.,LTD

28, Gilpa-ro 71beon-gil, Nam-gu, Incheon, Korea  
TEL : (82-32)876-4697 FAX : (82-32)876-4696  
http://www.hynux.com

## PT. HANYOUNG ELECTRONIC INDONESIA

JL. CEMPAKA BLOK F 16 NO.02 DELTA SILICON II INDUSTRIAL PARK  
LIPPO CIKARANG CICALI, CIKARANG PUSAT, BEKASI INDONESIA 17550  
TEL : 62-21-8911-8120~4 FAX : 62-21-8911-8126

HANYOUNG NUX



## Safety information

Before using the product, please read the safety information thoroughly and use it properly. Alerts declared in the manual are classified to Danger, Warning and Caution by their criticality

<b>⚠ DANGER</b>	DANGER indicates an imminently hazardous situation which, if not avoided, will result in death or serious injury
<b>⚠ WARNING</b>	WARNING indicates a potentially hazardous situation which, if not avoided, could result in death or serious injury
<b>⚠ CAUTION</b>	CAUTION indicates a potentially hazardous situation which, if not avoided, may result in minor or moderate injury

**⚠ Danger**

- Be sure to turn off power before connecting wires or changing a bulb. It can cause a electric shock.

**⚠ Warning**

- If there is a concern about a serious accident caused by a malfunction or abnormality of this product, please install a protection circuit outside to prevent from accident.
- Overvoltage will cause a product to be broken down.
- You must use the rated voltage. Overvoltage can cause a product to be broken down and it can also makes the product and the xenon lamp unit to be fragile.
- If you are concerned about serious accident due to the malfunction of products, please install the external safety equipment.

**⚠ Caution**

- The contents of this manual may be changed without prior notification.
- If the user does not follow the methods specified by manufacturing company, it will cause a bodily injuries or property damage.
- This product is only suitable for indoor use. Please use it in a place where there is no water.
- Please refer to the "Wiring Diagram" when you wire it to the product. Incorrect wiring will cause a product to be broken down.
- When applying a strong shock to the product, it may cause the product to be broken down.
- Please be cautious that contacting with chemicals such as thinner or benzene can cause the product's color to be changed and it can also cause a product to be broken down.
- End of unused lead wire must be insulated.
- When installing, choose a place that has sufficient strength and low vibration.
- Please use a fuse (250 V 0.2 A) for the power line.
- When separating from a product or connecting to a product, you must block the power that is connected to a main equipment and then operate it.
- When user does not follow the methods specified by manufacturing company, it will cause a product to be broken down so, please follow the manual.
- The warning symbol for safety is attached to the main product and wiring.
- Do not use it when a covering is separated from the product.
- Do not use when a cover is separated from the product.

## Suffix code

Model	Code	Information
RLA-	□ □ □	Signal light (XENON Lamp)
Function	WX	Strobe light
	WXB	Strobe light and buzzer built in type
Power supply voltage and Installation method	01	12 V DC
	02	24 V DC
	10	110 V AC
	20	220 V AC
	10M	110 V AC
	20M	220 V AC
	01A	12 V DC
	02A	24 V DC
Cap color	R	Red
	B	Blue

## Usage method

- The way to install it is easy and for automotive type, it can prevent from the scratch because a permanent magnet is covered by a rubber covering and it is attached to the car.
- For 12 V DC 24 V DC, it is easy to use power supply by using the automotive cigar jack
- Never separate a covering from the product while the power is on. Since high voltage is charged, it can cause an electric shock.
- For direct installing type, it is comfortable if supporter is used. (Option)

## Specification

Model	RLA-WX □ □	RLA-WXB □ □
Function	Strobe only	Strobe only-Buzzer
Dimension	Ø118 rectangular cap (Direct installation, Magnet attachment type supporter, Magnet attachment type supporter and cigar jack)	
Power supply voltage	12 V DC, 24 V DC, 110 V AC, 220 V AC 50/60 Hz, Selected by the suffix code	
Power consumption	7.2 W (when power supply voltage is 24 V DC), 12 W (when power supply voltage is 220 V AC)	
Strobe speed	Approx 60 times/min	
Light source	Xenon tube Strobe light	
Buzzer volume	—	Buzzer built in (approx 90 dB from distance 1m)
Material	Cap : acryl resin, Body : ABS resin	
Cap color	Red, Blue, White	
Degree of protection	IP54	

## Dimension and panel cutout

[Unit : mm]

## ■ RLA-WX □ □ (Normal type)

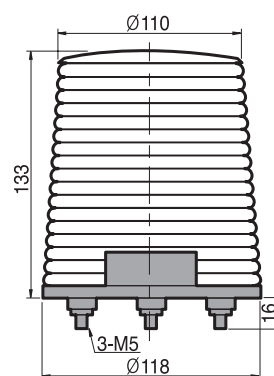

## ■ RLA-WXB □ □ (Automotive type)

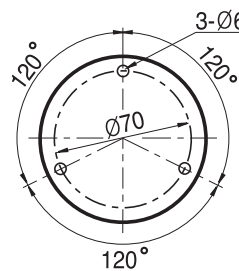
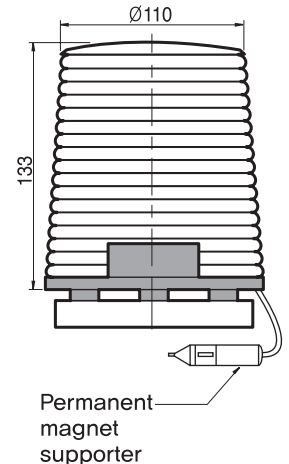

## Connection diagram

Buzzer (buzzer built in type) is connected to the power wire

Model	Power supply voltage	Wire color
RLA-□01□	12 V DC	Blue (+), Brown (-)
RLA-□01A□		Cigar jack
RLA-□02□	24 V DC	Blue (+), Brown (-)
RLA-□02A□		Cigar jack
RLA-□10□	110 V AC 50/60 Hz	Blue - Brown (2P)
RLA-□10M□		
RLA-□20□	220 V AC 50/60 Hz	Blue - Brown (2P)
RLA-□20M□		

# Đèn Cảnh Báo

## RLA-WX/WXB

### Thông số kỹ thuật

Mã hàng	RLA-WX□□	RLA-WXB□□
Hình dạng ngoài		
Chức năng	Xoay sáng liên tục	Xoay sáng liên tục, còi báo
Kích thước	Ø118 Nắp vuông (gắn trực tiếp, đế đỡ nam châm, đế đỡ nam châm và giắc cắm)	
Điện áp nguồn	12 V D.C, 24 V D.C, 110 V A.C 50/60 Hz, 220 V A.C 50/60 Hz	
Công suất tiêu thụ	● 7.2 W (Khi nguồn cấp là 24 V D.C), ● 12 W (Khi nguồn cấp là 220 V A.C)	
Tốc độ nhấp	Khoảng 60 lần/ phút	
Nguồn sáng	Đèn Xenon nhấp nháy	
Còi báo	-	Tích hợp còi báo (khoảng 90 dB từ khoảng cách 1m)
Vật liệu	● Nắp : nhựa acryl, ● Phần thân : nhựa ABS	
Màu nắp	Đỏ, Xanh dương, Trắng	
Cấp độ bảo vệ	IP54 (IEC 60529)	

### Mã đặt hàng

Mã hàng	Ký hiệu	Thông tin
RLA-	□ □ □	Đèn báo hiệu (Ø118)
Chức năng	WX	Nhấp nháy
	WXB	Đèn xoay liên tục và còi được tích hợp sẵn
Điện áp nguồn	01	12 V D.C
	02	24 V D.C
	10	110 V A.C
	20	220 V A.C
	10M	110 V A.C
	20M	220 V A.C
	01A	12 V D.C
	02A	24 V D.C
Màu nắp	R	Đỏ
	B	Xanh dương



[www.npower.com.vn](http://www.npower.com.vn)

Tài liệu được tổng hợp bởi đội ngũ kỹ thuật của **NPOWER**

Bản quyền nội dung thuộc về công ty **Hanyoung Nux**

Powered by **NAVITECH** | [www.navitech.co](http://www.navitech.co)