

Product Information

73 72 180

KNIPEX TwinForce®

High Performance Diagonal Cutters

- The superior High-Leverage Diagonal Cutter with patented double joint
- Ideal transmission of force due to double-hinged design
- Reliably cuts all types of wire, including steel tape
- For rough or very fine cutting
- Low cutting impact: gentle on hands. The tension on muscles and tendons is relieved
- For comfortable cutting, repetitive cutting or extremely hard cutting jobs
- High degree of stability and zero-backlash due to precisely milled forged-in axles
- Cutting edges additionally induction-hardened, cutting edge hardness approx. 64 HRC



General	
Article No.	73 72 180
EAN	4003773074779
pliers	black atramentized
Head	polished
Handles	with multi-component handles
Weight	280 g
Dimensions	180 x 53 x 22 mm
Standard	DIN ISO 5749
REACH compliant	does not contain SVHC
RoHS compliant	not applicable
Technical details	
Cutting capacities soft wire (diameter)	Ø 5 mm
Cutting capacities medium hard wire (diameter)	Ø 4.6 mm
Cutting capacities hard wire (diameter)	Ø 3.2 mm
Cutting capacities piano wire (diameter)	Ø 3.0 mm

Technical changes and errors excepted

www.npower.com.vn

Tài liệu được tổng hợp bởi đội ngũ kỹ thuật của **NPOWER**
Bản quyền nội dung thuộc về công ty **KNIPEX**



Powered by **NAVITECH** | www.navitech.co

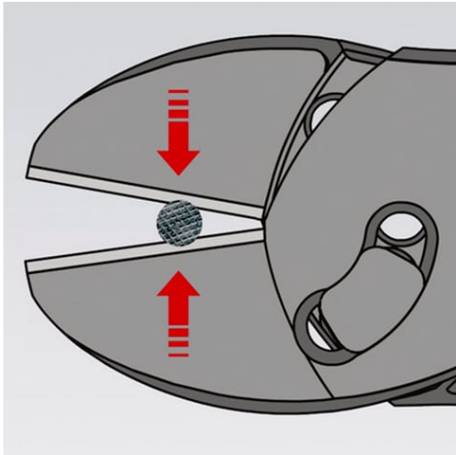
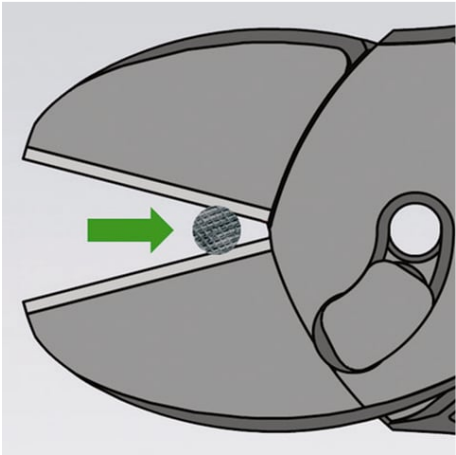
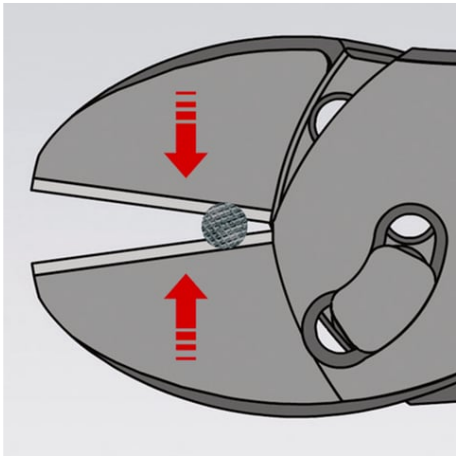
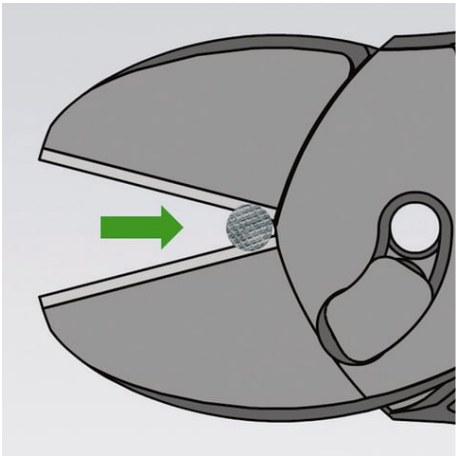



Product Information

73 72 180 F

KNIPEX TwinForce®

High Performance Diagonal Cutters

With opening spring

- The superior High-Leverage Diagonal Cutter with patented double joint
- Ideal transmission of force due to double-hinged design
- Reliably cuts all types of wire, including steel tape
- For rough or very fine cutting
- Low cutting impact: gentle on hands. The tension on muscles and tendons is relieved
- For comfortable cutting, repetitive cutting or extremely hard cutting jobs
- High degree of stability and zero-backlash due to precisely milled forged-in axles
- Cutting edges additionally induction-hardened, cutting edge hardness approx. 64 HRC
- With opening spring to simplify reapplication and for repetitive cutting



General

Article No.	73 72 180 F
EAN	4003773077657
pliers	black atramentized
Head	polished
Handles	with multi-component handles
Weight	280 g
Dimensions	180 x 54 x 21 mm
Standard	DIN ISO 5749
REACH compliant	does not contain SVHC
RoHS compliant	not applicable

Technical details

Cutting capacities soft wire (diameter)	Ø 5 mm
Cutting capacities medium hard wire (diameter)	Ø 4.6 mm
Cutting capacities hard wire (diameter)	Ø 3.2 mm
Cutting capacities piano wire (diameter)	Ø 3.0 mm

Technical changes and errors excepted

