

Operating Instructions

EN KNIPEX Tethered Tools Lanyards and Adapter Straps

www.npower.com.vn

Tài liệu được tổng hợp bởi đội ngũ kỹ thuật của **NPOWER**
Bản quyền nội dung thuộc về **KNIPEX**



Powered by **NAVITECH** | www.navitech.co

00 50 01 T

00 50 02 T

00 50 03 T

00 50 05 T

00 50 06 T

00 50 10 T

00 50 11 T

00 50 12 T

00 50 13 T



CONTENTS

1	General information	3
1.1	Notes on operating instructions	3
1.2	Symbols used	3
1.3	Copyright	3
1.4	Guarantee and warranty	3
2	Safety	4
2.1	Intended use	4
2.2	Safety Instructions for operation	4
2.3	Certified safety	5
3	Structure and function	6
3.1	Design of the Lanyard and Adapter Strap, 1.5 kg (3.3 lbs)	6
3.2	Design of the Lanyard and Adapter Strap, 6 kg (13 lbs)	6
3.3	Function	7
3.4	Product Overview and Technical Data	7
3.5	Compatibility to KNIPEX Tools with Tethering	8
4	Operation	9
4.1	Connecting the Lanyard to the tool	9
4.1.1	To use the loop end	9
4.1.2	To use the carabiner end	10
4.2	Connecting the Lanyard to primary anchoring locations (body, lifting device, or structure)	10
4.3	Connecting Adapter Straps	11
4.4	Using the tethering system	11
5	Inspection	12
6	Storage and Care	13
7	Disclaimer	13

1 General information

1.1 Notes on operating instructions

These operating instructions are for use with KNIPEX Tethered Tools Lanyards and Adapter Straps. The illustrations and descriptions contained in these operating instructions may differ slightly from the Lanyards and Adapter Straps actually delivered.

KNIPEX-Werk C. Gustav Putsch KG is not liable for damage caused by failure to observe these operating instructions.

1.2 Symbols used

All safety instructions in this operating instructions are indicated by corresponding symbols. The signal words at the beginning of each safety instruction express the extent of the hazard.



Risk of serious to fatal injuries

This combination of symbol and signal word indicates an imminently hazardous situation that will result in death or serious injury if not avoided.



Warning of potentially serious fatal injuries

This combination of symbol and signal word indicates a possibly hazardous situation that may result in death or serious injury if not avoided.



Caution

Indicates a hazardous situation that, if not avoided, could result in minor or moderate injury.

1.3 Copyright

These operating instructions and all documents supplied with the KNIPEX Tethered Tools Lanyards and Adapter Straps are protected by copyright and remain the property of KNIPEX.

The reprinting of these instructions, even in part, is only permitted with the written consent of KNIPEX Werk C. Gustav Putsch KG.

1.4 Guarantee and warranty

The manufacturer grants a statutory warranty in accordance with the current sales and delivery conditions. No further warranties or assurances are granted.

Within the warranty period, the warranty covers the rectification of all defects that can be traced back to material faults or manufacturing errors.

Wearing parts are excluded from the warranty.

Warranty is voided if any of the conditions exist:

- Damage is caused through improper operation, use for purposes other than those specified by the manufacturer, or poor maintenance.

2 Safety

2.1 Intended use

The products are intended for the following uses:

- All elements of the KNIPEX Tethered Tools System are designed to be used for tool tethering only. The weight of the tool must not exceed the permitted capacity for any tethering system component.
- Only connect KNIPEX Tethered Tools Lanyards or Adapter Straps to tools with captive tethering points that are engineered as tether points.

Any use beyond the intended purpose or any unauthorized modification shall be considered improper. The operator shall be liable for damages resulting from improper use.

Intended use also includes adhering to these operating instructions. They must be read and understood in full before use.

The users must be trained regarding to tool securing and the safe use of tools at heights. In order to reduce the hazards of **working at heights with tools**, the following instructions must be followed to avoid the risk of serious injury or death.

2.2 Safety Instructions for operation

DANGER

Risk of falling from slipping, stumbling, twisting and from people falling onto a lower surface or an object!

KNIPEX Tethered Tools Lanyards and Adapter Straps are for tool tethering only. They are not for human or animal support, nor are they intended to be part of a human fall protection system.

DANGER

Risk of injury from moving parts!

Do not use around machinery with exposed turning or moving parts.

DANGER

Risk of falling due to falling heavy tools

Heavy, falling tools can make you loose your balance and falls can occur.

Only connect tools to your body that are **lighter than 2.26 kg (5 lbs)**. Secure heavier tools to a suitable, fixed anchor point.

WARNING

Risk of injury from falling parts!

Observe the following safety instructions when using KNIPEX Tethered Tools Lanyards and Adapter Straps.

- Never exceed the permitted capacity for any tethering system component.
- Never attach more than one tool to the KNIPEX Lanyards or Adapter Straps at the same time.
- Each KNIPEX Tethered Tools Lanyard or Adapter Strap **MUST** be inspected prior to each use in accordance with the Instruction Manual.
- If a KNIPEX Tethered Tools Lanyard or Adapter Strap has been subject to fall arrest forces, it must be immediately inspected for damage by a competent person prior to continued use. If any doubt it must be removed from service.

- Do not make modifications to KNIPEX Tethered Tool Lanyards, Adapter Straps and KNIPEX Tools with Tethering.
- Never make attachments to tools or equipment in a manner that would allow the KNIPEX Tethered Tools Lanyard or Adapter Strap to be unintentionally disconnected.
- Do not tie or knot the KNIPEX Tethered Tools Lanyard or Adapter Strap. Only attach KNIPEX Tethered Tools Lanyard or Adapter Strap per manufacturer instructions.
- Do not lengthen a KNIPEX Tethered Tools Lanyard by connecting multiple Lanyards together.
- Do not connect more than one KNIPEX Tethered Tools Adapter Strap to the Lanyard.
- Do not connect more than two KNIPEX Tethered Tools Adapter Straps together.
- Ensure the KNIPEX Tethered Tools Lanyard or Adapter Strap is kept free from any and all obstructions including, but not limited to, entanglement with other workers, yourself, and surrounding objects.
- Do not wrap KNIPEX Tethered Tools Lanyards or Adapter Straps around sharp or abrasive edges.
- Do not use a KNIPEX Tethered Tools Lanyard or Adapter Strap if it will interfere with the safe working condition, or operation of the tool or equipment it is attached to.
- Only connect KNIPEX Tethered Tools Lanyards or Adapter Straps to Anchor Points that are suitable and reliable for tool tethering.
- Only connect KNIPEX Tethered Tools Lanyards or Adapter Straps to tools with captive tethering points that are engineered as tether points.
- Ensure there is adequate clearance in the event of a tool drop. Tool fall/swing path must not endanger yourself, other personnel, or any surrounding equipment or materials.
- Do not use KNIPEX Tethered Tools Lanyards or Adapter Straps in temperatures below -35 °C / -30 °F or above 45 °C / 113 F.
- Do not use the loop for abridged connection to tether tools (Figure 10).

⚠ CAUTION

General notes

- All procedures shown in these instructions are for KNIPEX Tethered Tools Lanyards or Adapter Straps only.
- All incidents of dropped tools should be reported to your supervisor or safety coordinator. Involved KNIPEX Tethered Tools Lanyards or Adapter Straps must be inspected for damage immediately (see chapter "Inspection").
- KNIPEX Tethered Tools Lanyards or Adapter Straps should not be used at full extension.

2.3 Certified safety



The products are tested and conform according to ANSI ISEA 121-2018.

The usability and loading capacity of the Lanyards have been independently tested and certified.

(VPA TESTED by VPA Prüf- und Zertifizierungs GmbH, 42859 Remscheid Germany)

STRUCTURE AND FUNCTION

3 Structure and function

3.1 Design of the Lanyard and Adapter Strap, 1.5 kg (3.3 lbs)

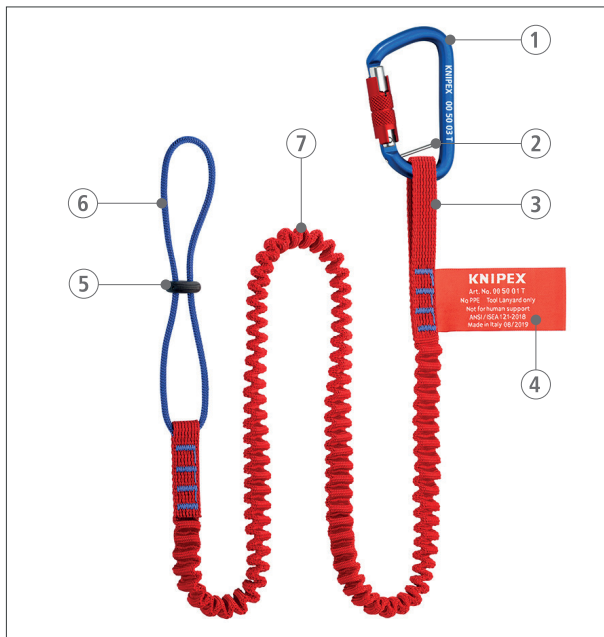

Figure 1: Terms and definitions - Lanyard, 1.5 kg (3.3 lbs)

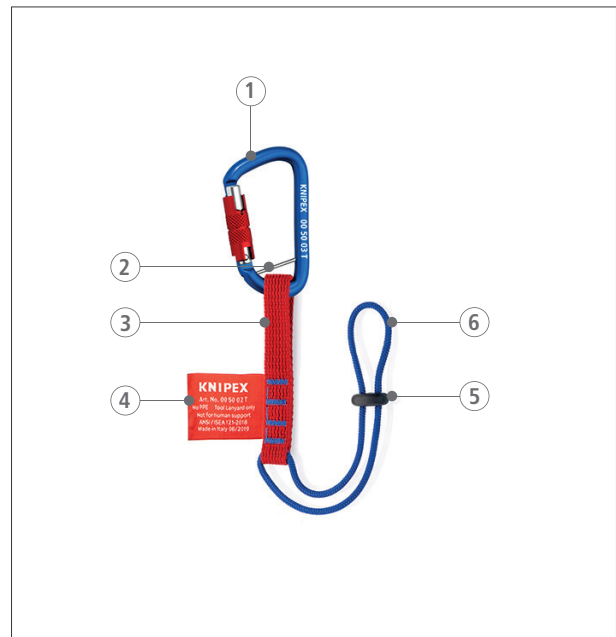

Figure 2: Terms and definitions - Adapter Strap 1.5 kg (3.3 lbs)

3.2 Design of the Lanyard and Adapter Strap, 6 kg (13 lbs)



Figure 3: Terms and definitions - Lanyard 6 kg (13 lbs)



Figure 4: Terms and definitions - Adapter Strap 6 kg (13 lbs)

- 1 Carabiner
- 2 Captive eye
- 3 Carabiner end
- 4 Label
- 5 Cord stop
- 6 Loop end
- 7 Lanyard
- 8 Flat belt loop for abridged connection (only for 6 kg (13 lbs) Lanyard)

3.3 Function

Tools that do not exceed the permitted capacity for any tethering system component and have a captive tethering point engineered into them can be tethered with the KNIPEX Tethered Tools Lanyards and Adapter Straps.

3.4 Product Overview and Technical Data

Product No.	Type	Relaxed length	Stretched length	Load rating
00 50 01 T	Lanyard	1000 mm (38")	1500 mm (59")	1.5 kg (3.3 lbs)
(Not available in the US)				
00 50 02 T	Adapter Strap	260 mm (10")	260 mm (10")	1.5 kg (3.3 lbs)
(Not available in the US)				
00 50 03 T	Carabiner with captive eye	82 mm (3.2")	82 mm (3.2")	200 kg (440 lbs)
(Not available in the US)				
00 50 05 T	Lanyard with Carabiner Item consists of 00 50 01 T and 00 50 03 T	1080 mm (38")	1580 mm (60")	1.5 kg (3.3 lbs)
00 50 06 T	Adapter Strap with Carabiner with captive eye Item consists of 00 50 02 T and 00 50 03 T	340 mm (13")	340 mm (13")	1.5 kg (3.3 lbs)
00 50 10 T	Lanyard	900 mm (36")	1490 mm (59")	6 kg (13 lbs)
(Not available in the US)				
00 50 11 T	Adapter Strap	400 mm (16")	400 mm (16")	6 kg (13 lbs)
(Not available in the US)				
00 50 12 T	Lanyard with Carabiner with captive eye Item consists of 00 50 10 T and 00 50 03 T	980 mm (38.6")	1570 mm (61.8")	6 kg (13 lbs)
00 50 13 T	Adapter Strap with Carabiner with captive eye Item consists of 00 50 11 T and 00 50 03 T	480 mm (16")	480 mm (16")	6 kg (13 lbs)

STRUCTURE AND FUNCTION

3.5 Compatibility to KNIPEX Tools with Tethering

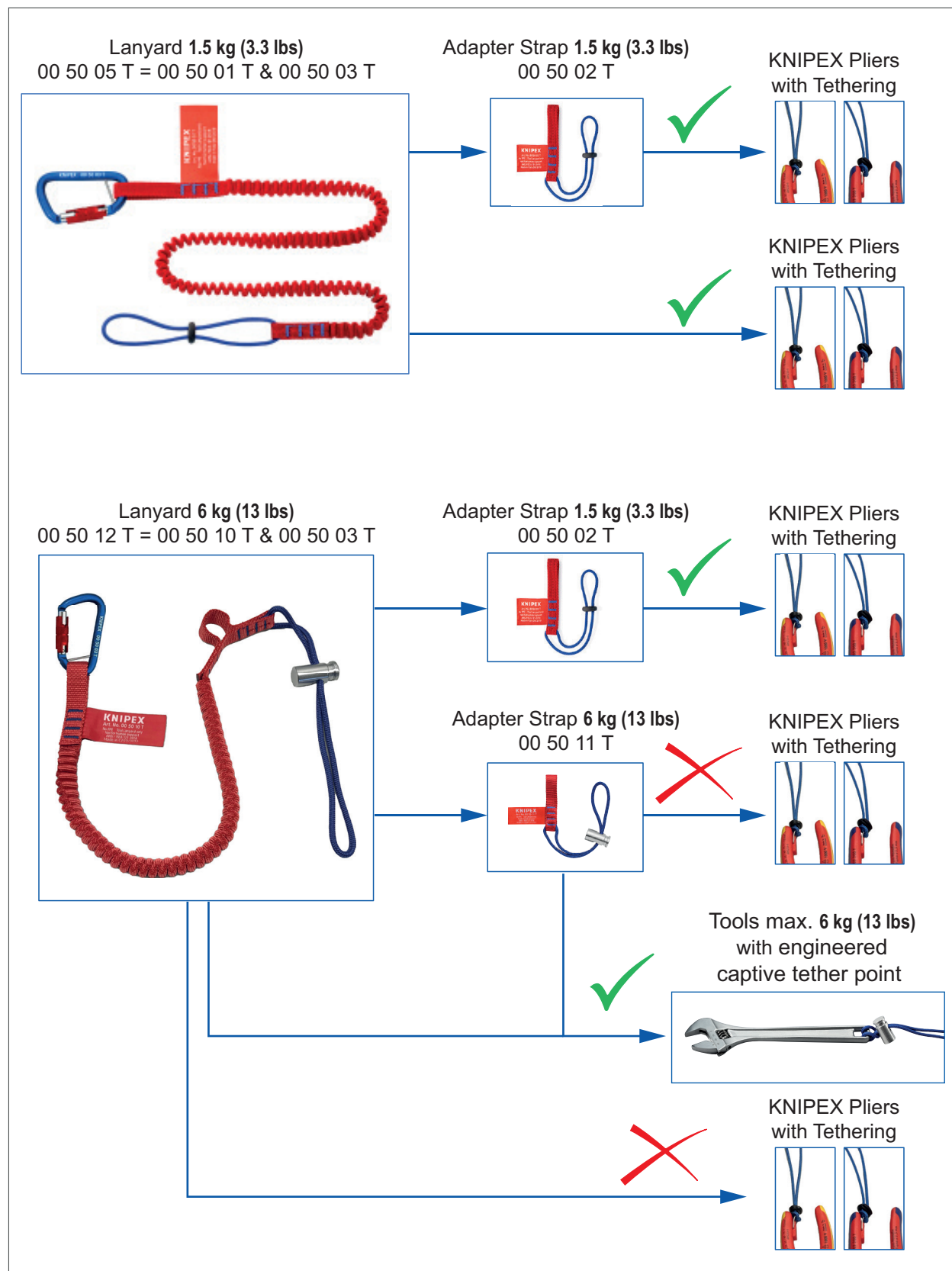

Figure 5: Compatibility to KNIPEX Tools with Tethering

4 Operation

4.1 Connecting the Lanyard to the tool

- When connecting a KNIPEX Tool equipped with a tethering point to your Lanyard or Adapter Strap, check (Figure 5), to see if your Lanyard or Adapter Strap is compatible.
- To connect a KNIPEX Tool with tethering to the 6 kg (13 lbs) Lanyard (KNIPEX 00 50 10 T) you must use the 1.5 kg (3.3 lbs) Adapter Strap (KNIPEX 00 50 02 T) (Figure 5)
(The cord of the 6 kg (13 lbs) version is too thick to thread through the tether point on the tool).
- KNIPEX Tools with a tethering point should only be connected by loop (Figure 6).
- Never use the flat belt loop for abridged connection for tethering (Figure 10).

Attach an end of the Lanyard or Adapter Strap to a tool. Either the loop end of the Lanyard or the carabiner end may be used.

4.1.1 To use the loop end

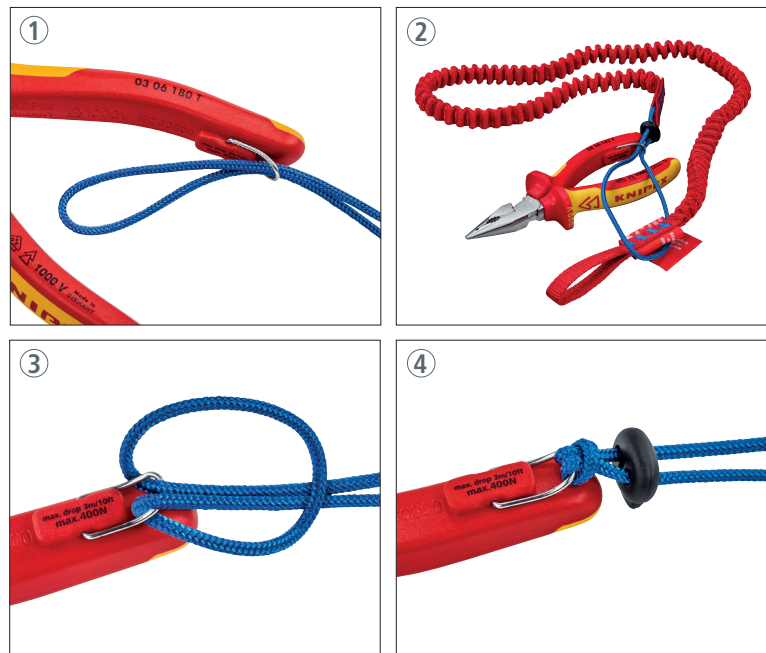

Figure 6: Connection via loop

1. Pass the loop end through the captive engineered tether point on the tool.
2. Take the end of the Lanyard, which can be with or without a carabiner, and pass it through the loop.
3. Pull tightly to cinch and create a secure connection.
4. Push the cord stopper tightly to the cinch.

OPERATION

4.1.2 To use the carabiner end

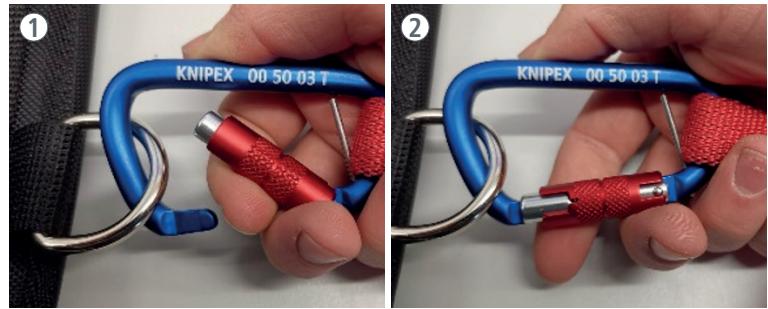

Figure 7: Connection via carabiner

1. Open the self-locking carabiner by rotating the red locking gate and pushing the latch inside and connect it to the captive engineered tether point on the tool.
2. Make sure there is clearance for the locking gate of the carabiner to close.

4.2 Connecting the Lanyard to primary anchoring locations (body, lifting device, or structure)

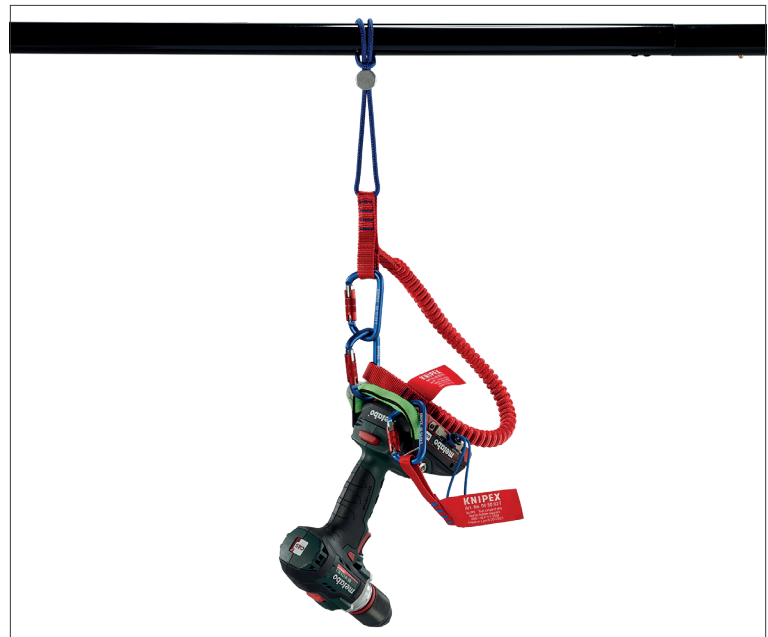

Figure 8: Lanyard anchored to a structure

1. Tools that exceed 2.26 kg (5 lbs) must be anchored to a structural anchor or lifting device, not to the users body.
2. The best practice is to always anchor your Lanyard to a structure other than the users body. If the user does anchor the Lanyard to their body, take great care selecting the anchor location and always be sure to have a secure stand, because falling tools can make you loose your balance.
3. For any questions or concerns about selecting appropriate anchor points, consult a qualified person.

Attach the other end of the Lanyard to an anchor point that is suitable and reliable for tool tethering either by loop or by a carabiner (see Chapter 4.1.1, figure 6 and 4.1.2).

4.3 Connecting Adapter Straps

To connect a KNIPEX Adapter Strap:

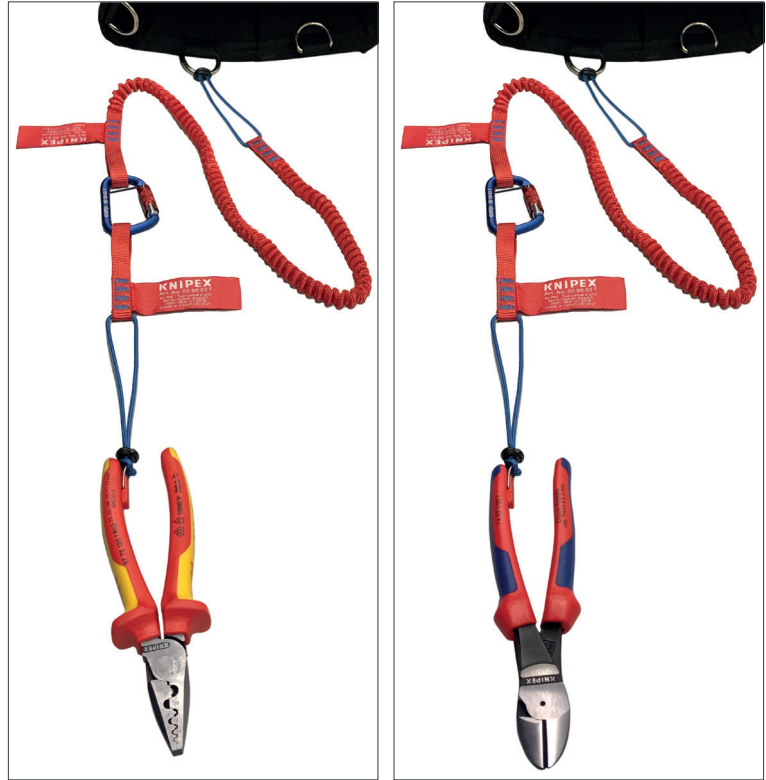

Figure 9: Connecting Adapter Straps

1. Connect the Adapter Strap to the tool via loop as described in chapter 4.1.1.
2. Connect the Adapter Strap to the Lanyard or anchor point via carabiner as described in chapter 4.1.2.

4.4 Using the tethering system

- Always keep tools tethered while working at heights. When exchanging tools, use a 100 % tie-off by ensuring the tool is tethered to a secondary anchor before disconnecting from the initial anchor point.
- When using KNIPEX Tool Lanyards and Adapter Straps, determine the fully stretched length of the Lanyard used, plus the length of the Adapter Strap if used, plus the tool itself. Add an additional safety factor to ensure an adequate clearance between where the Lanyard is anchored and the nearest person or object.

The 6 kg (13 lbs) version of the Lanyard is equipped with a second flat belt loop for abridged connection (see figure 3, Pos. 8). A second carabiner, which is hooked into this additional flat belt loop, can bridge the elastic part of the Lanyard. This prevents the tool from hanging down far and the abridged connection keeps the tool closer to the attachment point when the tool is not in use.

Attention!

This flat belt loop for abridged connection must never be used to secure a tool for fall protection (figure 10).

OPERATION

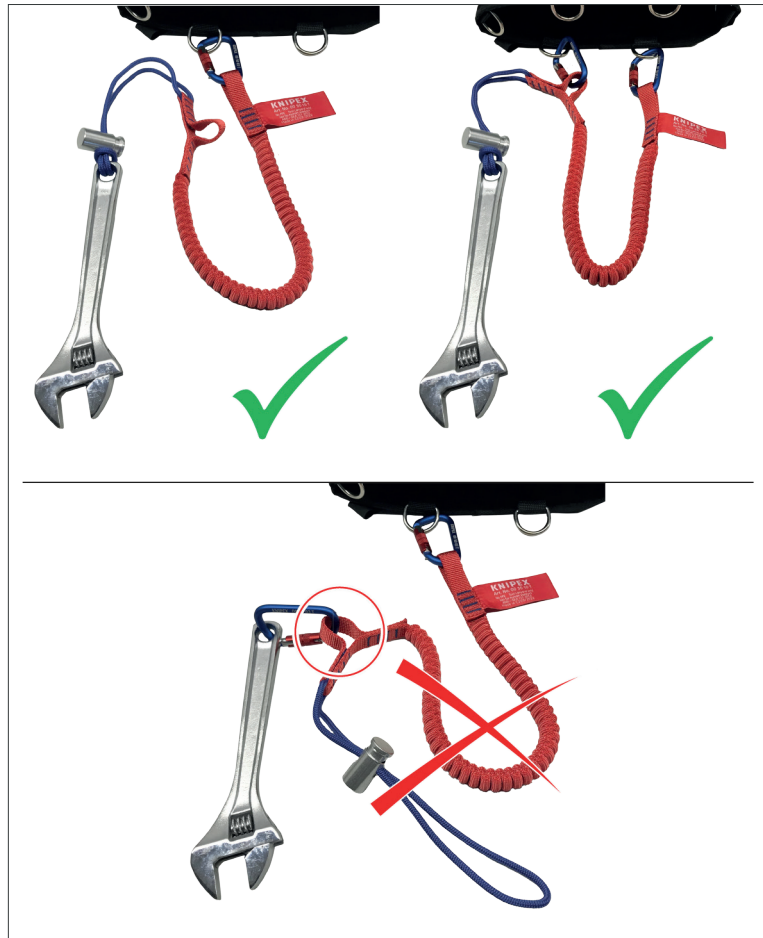

Figure 10: Abridge connection

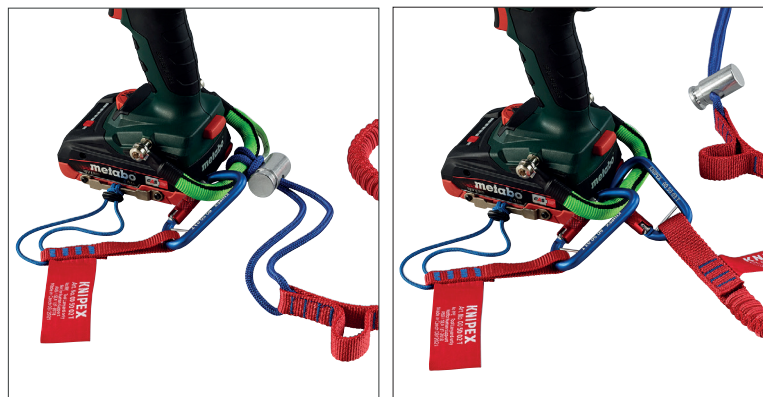

Figure 11: Attachment to a battery tool (over the loop or via carabiner)

Attention!
Also attach the battery.

5 Inspection

KNIPEX Tethered Tools equipment and components must be thoroughly inspected before each use. Any KNIPEX Tethered Tools component that has deformities, unusual wear or deterioration must be immediately removed from service and destroyed.

Inspect the entire surface of the component, carefully rotating it while visually inspecting for damage or wear that might affect its usability and dependability. Inspect material and stitching, hardware, Carabiners, D-Rings and connectors all operate. In any doubt, please ask your supervisor for help.

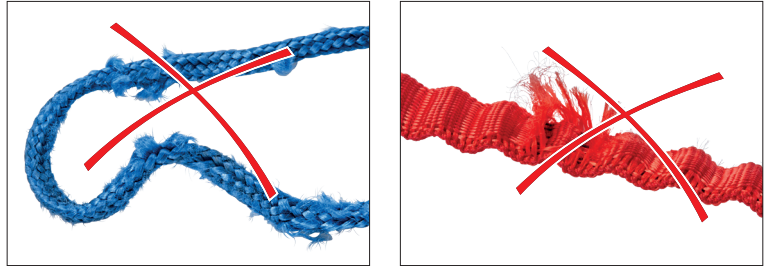

Figure 12: Remove KNIPEX Tethered Tools components from service if damaged

6 Storage and Care

- Store tool Lanyards and Adapter Straps in a clean, dry location away from direct sunlight.
- To clean, use mild soap and water. Allow Lanyards and Adapter Straps to air dry only.

7 Disclaimer

In no event, shall KNIPEX-WERK C. Gustav Putsch KG be liable for any direct, indirect, punitive, incidental, special, or consequential damages arising out of, or associated with the misuse of KNIPEX Tethered Tools Lanyards and Adapter Straps.



KNIPEX-Werk
C. Gustav Putsch KG

42337 Wuppertal

Tel.: +49 202 – 47 94-0
Fax: +49 202 – 47 74 94

info@knipex.com
www.knipex.com

Operating Instructions

EN KNIPEX TetheredTools Lanyards and Adapter Straps

00 50 01 T
00 50 02 T
00 50 03 T
00 50 05 T
00 50 06 T
00 50 10 T
00 50 11 T
00 50 12 T
00 50 13 T
00 62 10 TR
00 63 06 TCR

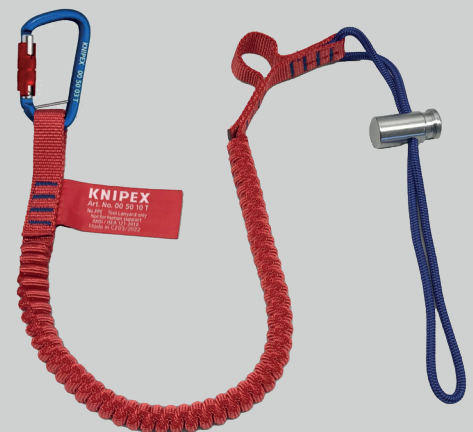

CONTENTS

1	General information	3
1.1	Notes on operating instructions	3
1.2	Symbols used	3
1.3	Copyright	3
1.4	Guarantee and warranty	3
2	Safety	4
2.1	Intended use	4
2.2	Safety Instructions for operation	4
2.3	Certified safety	5
3	Structure and function	6
3.1	Design of the Lanyard and Adapter Strap, 1.5 kg (3.3 lbs)	6
3.2	Design of the Lanyard and Adapter Strap, 6 kg (13.2 lbs)	6
3.3	Function	7
3.4	Product Overview and Technical Data	7
3.4.1	TetheredTool Clips (TTC) and ColorCode Clips	7
3.4.2	Lanyards, Adapter Straps and Carabiner	7
3.5	Compatibility to KNIPEX Tools with Tethering	9
4	Operation	10
4.1	Connecting the Lanyard to the tool	10
4.1.1	Attaching the clip (TTC) to the tool	10
4.1.2	Connecting the Lanyard and / or Adapter Strap 1.5 kg when using the TTC	11
4.1.3	To use the loop end	12
4.2	To use the carabiner end	12
4.3	Connecting the Lanyard to primary anchoring locations (body, lifting device, or structure)	13
4.4	Connecting Adapter Straps	14
4.5	Using the tethering system	14
5	Inspection	16
6	Storage and Care	16
7	Disclaimer	16

1 General information

1.1 Notes on operating instructions

These operating instructions are for use with KNIPEX TetheredTools Lanyards and Adapter Straps. The illustrations and descriptions contained in these operating instructions may differ slightly from the Lanyards and Adapter Straps actually delivered.

KNIPEX-Werk C. Gustav Putsch KG is not liable for damage caused by failure to observe these operating instructions.

1.2 Symbols used

All safety instructions in this operating instructions are indicated by corresponding symbols. The signal words at the beginning of each safety instruction express the extent of the hazard.



Risk of serious to fatal injuries

This combination of symbol and signal word indicates an imminently hazardous situation that will result in death or serious injury if not avoided.



Warning of potentially serious fatal injuries

This combination of symbol and signal word indicates a possibly hazardous situation that may result in death or serious injury if not avoided.



Caution

Indicates a hazardous situation that, if not avoided, could result in minor or moderate injury.

1.3 Copyright

These operating instructions and all documents supplied with the KNIPEX TetheredTools Lanyards and Adapter Straps are protected by copyright and remain the property of KNIPEX.

The reprinting of these instructions, even in part, is only permitted with the written consent of KNIPEX Werk C. Gustav Putsch KG.

1.4 Guarantee and warranty

The manufacturer grants a statutory warranty in accordance with the current sales and delivery conditions. No further warranties or assurances are granted.

Within the warranty period, the warranty covers the rectification of all defects that can be traced back to material faults or manufacturing errors.

Wearing parts are excluded from the warranty.

Warranty is voided if any of the conditions exist:

- Damage is caused through improper operation, use for purposes other than those specified by the manufacturer, or poor maintenance.

2 Safety

2.1 Intended use

The products are intended for the following uses:

- All elements of the KNIPEX TetheredTools System are designed to be used for tool tethering only. The weight of the tool must not exceed the permitted capacity for any tethering system component.
- Only connect KNIPEX TetheredTools Lanyards or Adapter Straps to tools with captive tethering points that are engineered as tether points.

Any use beyond the intended purpose or any unauthorized modification shall be considered improper. The operator shall be liable for damages resulting from improper use.

Intended use also includes adhering to these operating instructions. They must be read and understood in full before use.

The users must be trained regarding to tool securing and the safe use of tools at heights. In order to reduce the hazards of **working at heights with tools**, the following instructions must be followed to avoid the risk of serious injury or death.

2.2 Safety Instructions for operation

DANGER

Risk of falling from slipping, stumbling, twisting and from people falling onto a lower surface or an object!

KNIPEX TetheredTools Lanyards and Adapter Straps are for tool tethering only. They are not for human or animal support, nor are they intended to be part of a human fall protection system.

DANGER

Risk of injury from moving parts!

Do not use around machinery with exposed turning or moving parts.

DANGER

Risk of falling due to falling heavy tools

Heavy, falling tools can make you loose your balance and falls can occur.

Only connect tools to your body that are **lighter than 2.26 kg (5 lbs)**. Secure heavier tools to a suitable, fixed anchor point.

WARNING

Risk of injury from falling parts!

Observe the following safety instructions when using KNIPEX TetheredTools Lanyards and Adapter Straps.

- Never exceed the permitted capacity for any tethering system component.
- Never attach more than one tool to the KNIPEX Lanyards or Adapter Straps at the same time.
- Each KNIPEX TetheredTools Lanyard or Adapter Strap **MUST** be inspected prior to each use in accordance with the Instruction Manual.
- If a KNIPEX TetheredTools Lanyard or Adapter Strap has been subject to fall arrest forces, it must be immediately inspected for damage by a competent person prior to continued use. If any doubt it must be removed from service.

- Do not make modifications to KNIPEX TetheredTool Lanyards, Adapter Straps and KNIPEX Tools with Tethering.
- Never make attachments to tools or equipment in a manner that would allow the KNIPEX TetheredTools Lanyard or Adapter Strap to be unintentionally disconnected.
- Do not tie or knot the KNIPEX TetheredTools Lanyard or Adapter Strap. Only attach KNIPEX TetheredTools Lanyard or Adapter Strap per manufacturer instructions.
- Do not lengthen a KNIPEX TetheredTools Lanyard by connecting multiple Lanyards together.
- Do not connect more than one KNIPEX TetheredTools Adapter Strap to the Lanyard.
- Do not connect more than two KNIPEX TetheredTools Adapter Straps together.
- Ensure the KNIPEX TetheredTools Lanyard or Adapter Strap is kept free from any and all obstructions including, but not limited to, entanglement with other workers, yourself, and surrounding objects.
- Do not wrap KNIPEX TetheredTools Lanyards or Adapter Straps around sharp or abrasive edges.
- Do not use a KNIPEX TetheredTools Lanyard or Adapter Strap if it will interfere with the safe working condition, or operation of the tool or equipment it is attached to.
- Only connect KNIPEX TetheredTools Lanyards or Adapter Straps to Anchor Points that are suitable and reliable for tool tethering.
- Only connect KNIPEX TetheredTools Lanyards or Adapter Straps to tools with captive tethering points that are engineered as tether points.
- Ensure there is adequate clearance in the event of a tool drop. Tool fall/swing path must not endanger yourself, other personnel, or any surrounding equipment or materials.
- Do not use KNIPEX TetheredTools Lanyards or Adapter Straps in temperatures below -35 °C / -30 °F or above 45 °C / 113 F.
- Do not use the loop for abridged connection to tether tools (Figure 10).

CAUTION

General notes

- All procedures shown in these instructions are for KNIPEX TetheredTools Lanyards or Adapter Straps only.
- All incidents of dropped tools should be reported to your supervisor or safety coordinator. Involved KNIPEX TetheredTools Lanyards or Adapter Straps must be inspected for damage immediately (see chapter "Inspection").
- KNIPEX TetheredTools Lanyards or Adapter Straps should not be used at full extension.

2.3 Certified safety



The products are tested and conform according to ANSI ISEA 121-2018.

The usability and loading capacity of the Lanyards have been independently tested and certified.

(VPA TESTED by VPA Prüf- und Zertifizierungs GmbH, 42859 Remscheid Germany)

STRUCTURE AND FUNCTION

3 Structure and function

3.1 Design of the Lanyard and Adapter Strap, 1.5 kg (3.3 lbs)

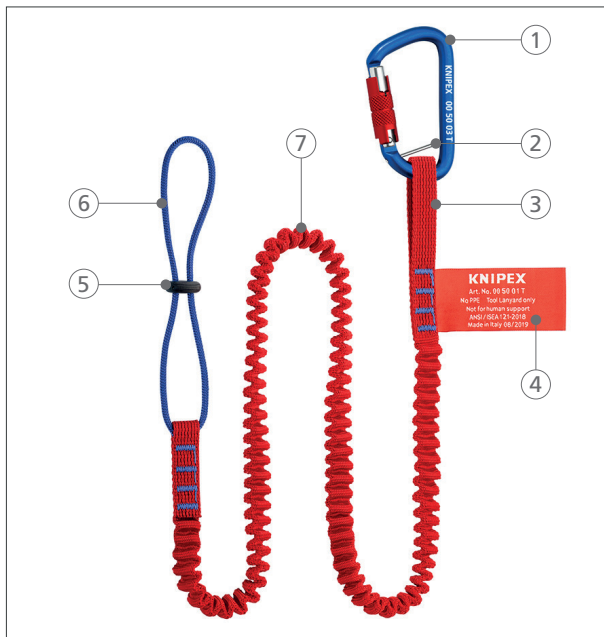

Figure 1: Terms and definitions - Lanyard, 1.5 kg (3.3 lbs)

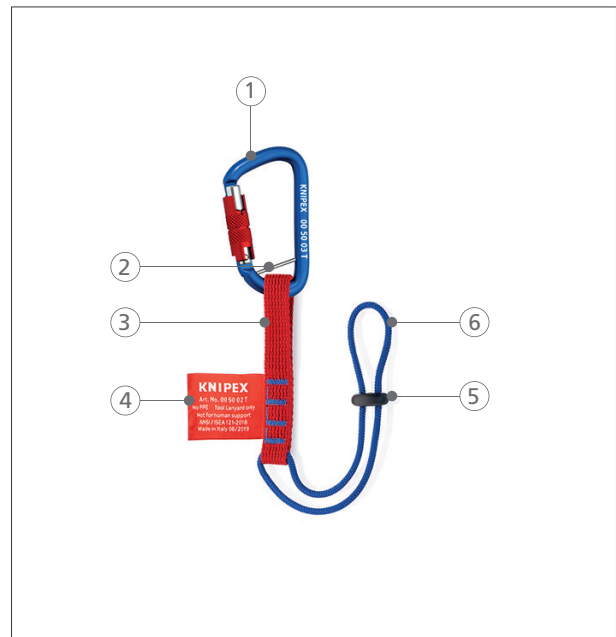

Figure 2: Terms and definitions - Adapter Strap 1.5 kg (3.3 lbs)

3.2 Design of the Lanyard and Adapter Strap, 6 kg (13.2 lbs)



Figure 3: Terms and definitions - Lanyard 6 kg (13.2 lbs)



Figure 4: Terms and definitions - Adapter Strap 6 kg (13.2 lbs)

- 1 Carabiner
- 2 Captive eye
- 3 Carabiner end
- 4 Label
- 5 Cord stop
- 6 Loop end
- 7 Lanyard
- 8 Flat belt loop for abridged connection (only for 6 kg (13.2 lbs) Lanyard)

STRUCTURE AND FUNCTION

3.3 Function

Tools that do not exceed the permitted capacity for any tethering system component and have a captive tethering point engineered into them can be tethered with the KNIPEX TetheredTools Lanyards and Adapter Straps.

3.4 Product Overview and Technical Data

3.4.1 TetheredTool Clips (TTC) and ColorCode Clips



Product No.	Type	Quantity	Color
00 62 10 TR	TetheredTool Clips	10	red
00 63 06 TCR	TetheredTool Clips + ColorCode Clips	3 each	red

3.4.2 Lanyards, Adapter Straps and Carabiner



Product No.	Type	Relaxed length	Stretched length	Load rating	Compatible with TTC
00 50 01 T (Not available in the US)	Lanyard	1000 mm (38")	1500 mm (59")	1.5 kg (3.3 lbs)	•
00 50 02 T (Not available in the US)	Adapter Strap	260 mm (10")	260 mm (10")	1.5 kg (3.3 lbs)	•
00 50 03 T (Not available in the US)	Carabiner with captive eye	82 mm (3.2")	82 mm (3.2")	200 kg (440 lbs)	•
00 50 05 T	Lanyard with Carabiner Item consists of 00 50 01 T and 00 50 03 T	1080 mm (38")	1580 mm (60")	1.5 kg (3.3 lbs)	•
00 50 06 T	Adapter Strap with Carabiner with captive eye Item consists of 00 50 02 T and 00 50 03 T	340 mm (13")	340 mm (13")	1.5 kg (3.3 lbs)	•

STRUCTURE AND FUNCTION



Product No.	Type	Relaxed length	Stretched length	Load rating	Compatible with TTC
00 50 10 T	Lanyard	900 mm (36")	1490 mm (59")	6 kg (13.2 lbs)	—
(Not available in the US)					
00 50 11 T	Adapter Strap	400 mm (16")	400 mm (16")	6 kg (13.2 lbs)	—
(Not available in the US)					
00 50 12 T	Lanyard with Carabiner with captive eye Item consists of 00 50 10 T and 00 50 03 T	980 mm (38.6")	1570 mm (61.8")	6 kg (13.2 lbs)	—
00 50 13 T	Adapter Strap with Carabiner with captive eye Item consists of 00 50 11 T and 00 50 03 T	480 mm (16")	480 mm (16")	6 kg (13.2 lbs)	—

STRUCTURE AND FUNCTION

3.5 Compatibility to KNIPEX Tools with Tethering

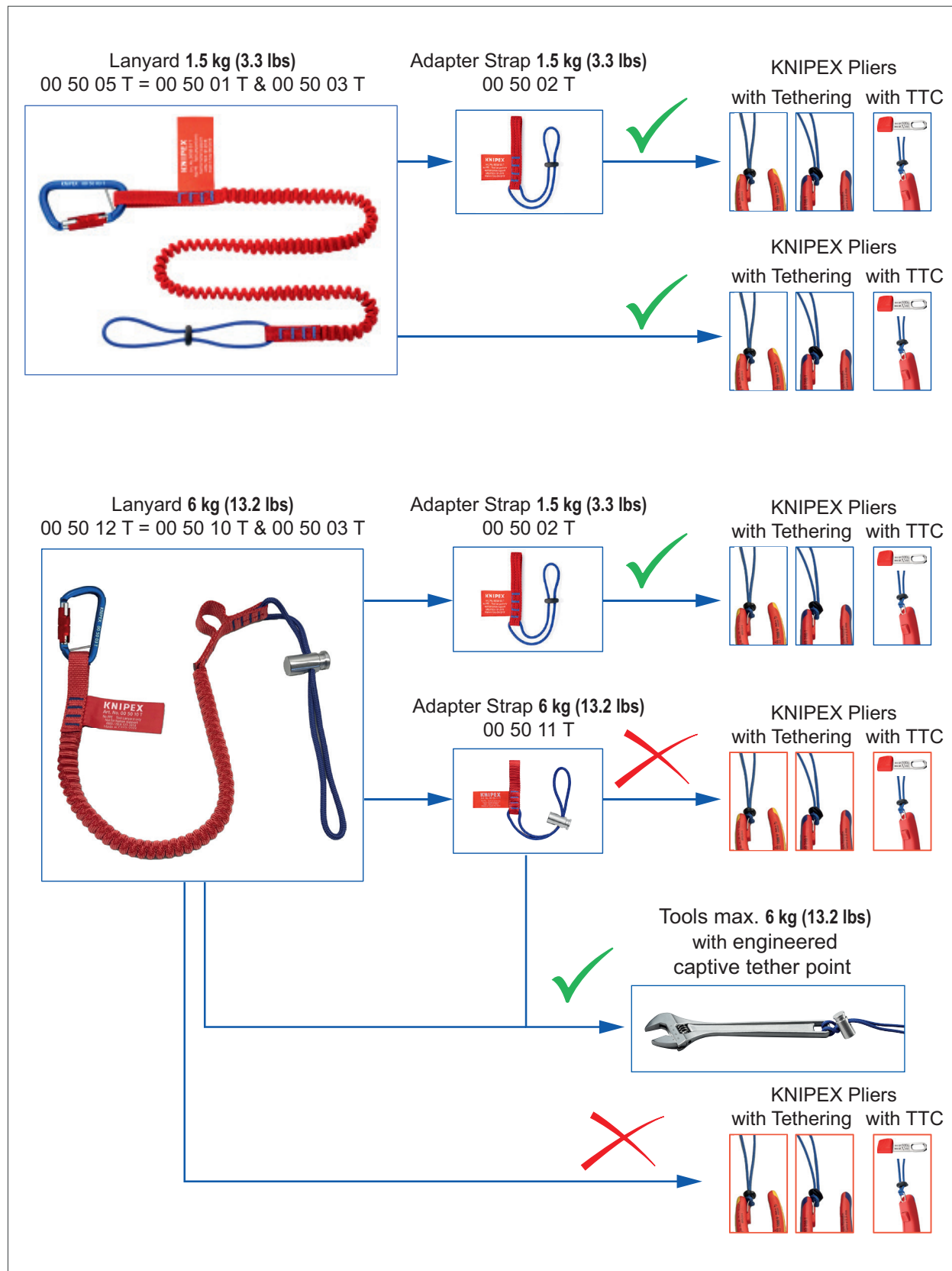

Figure 5: Compatibility to KNIPEX Tools with Tethering

4 Operation

4.1 Connecting the Lanyard to the tool

- When connecting a KNIPEX Tool equipped with a tethering point to your Lanyard or Adapter Strap, check (Figure 5), to see if your Lanyard or Adapter Strap is compatible.
- To connect a KNIPEX Tool with tethering to the 6 kg (13.2 lbs) Lanyard (KNIPEX 00 50 10 T) you must use the 1.5 kg (3.3 lbs) Adapter Strap (KNIPEX 00 50 02 T) (Figure 5)
(The cord of the 6 kg (13.2 lbs) version is too thick to thread through the tether point on the tool).
- KNIPEX Tools with a tethering point should only be connected by loop (Figure 8).
- Never use the flat belt loop for abridged connection for tethering (Figure 12).

Attach an end of the Lanyard or Adapter Strap to a tool. Either the loop end of the Lanyard or the carabiner end may be used.

4.1.1 Attaching the clip (TTC) to the tool

! WARNING

Warning of defective product!

Before each use, visually inspect the clip and interface on the tool for integrity (e.g. cracks, sharp edges or deformation).

! WARNING

Warning of use with unsuitable products!

Only connect the TTCs with KNIPEX accessories.

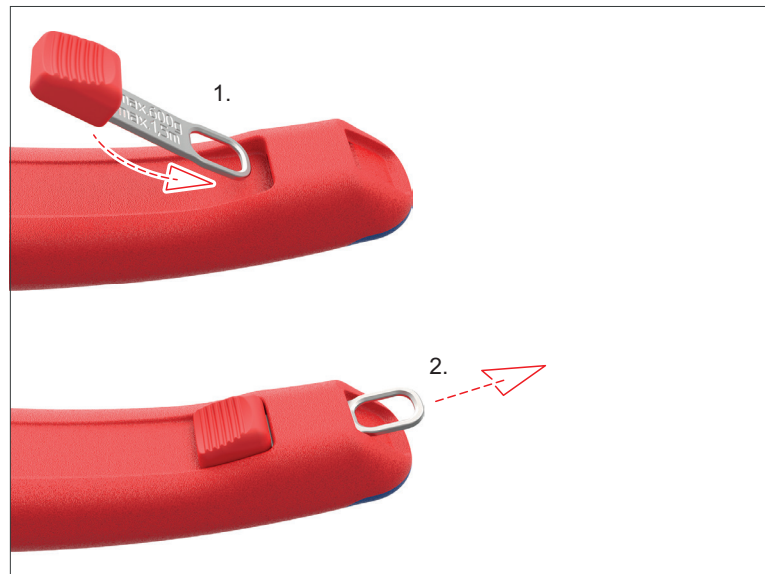

Figure 6: Attach the TTC

1. Push the clip from the inside into the interface on the tool handle.
2. Push the clip all the way into the interface to create a fixed connection.

OPERATION

4.1.2 Connecting the Lanyard and / or Adapter Strap 1.5 kg when using the TTC

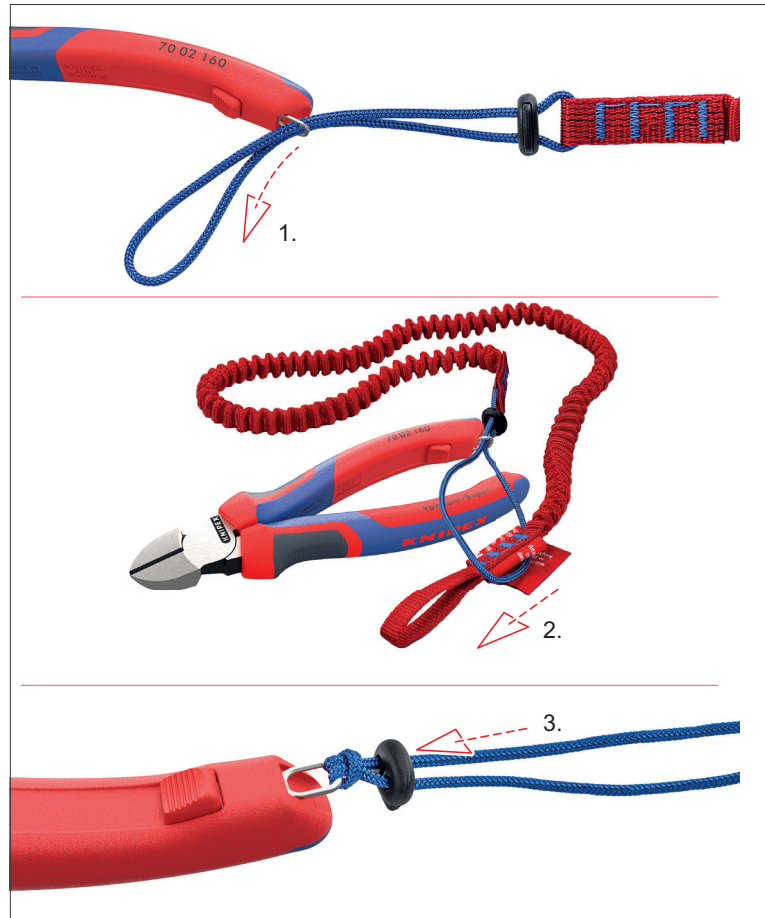

Figure 7: Connection to the TTC via loop

1. Pass the loop end through the interface of the TetheredTool Clip (TTC).
2. Take the end of the Lanyard, which can be with or without a carabiner, and pass it through the loop and pull tightly to cinch and create a fixed connection.
3. Push the cord stopper tightly to the cinch.

4.1.3 To use the loop end

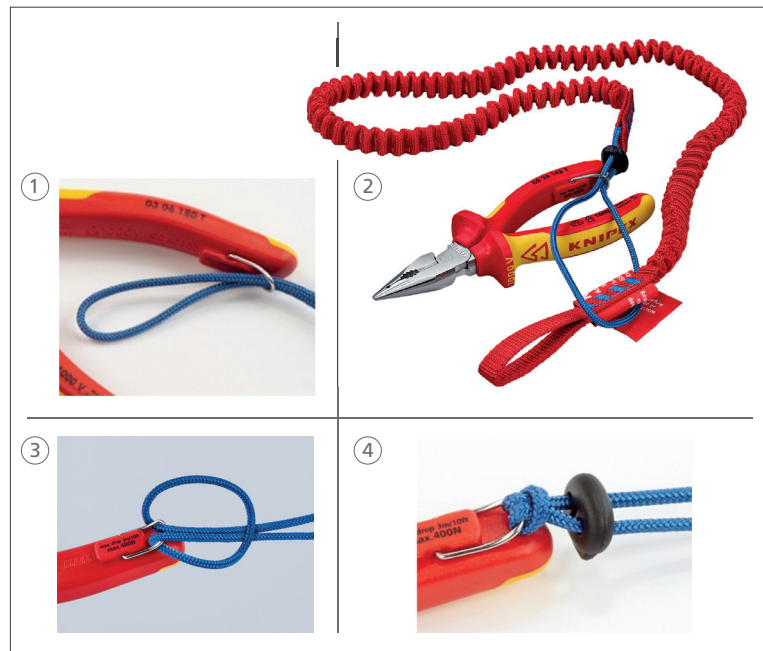

Figure 8: Connection via loop

1. Pass the loop end through the captive engineered tether point on the tool.
2. Take the end of the Lanyard, which can be with or without a carabiner, and pass it through the loop.
3. Pull tightly to cinch and create a fixed connection.
4. Push the cord stopper tightly to the cinch.

4.2 To use the carabiner end

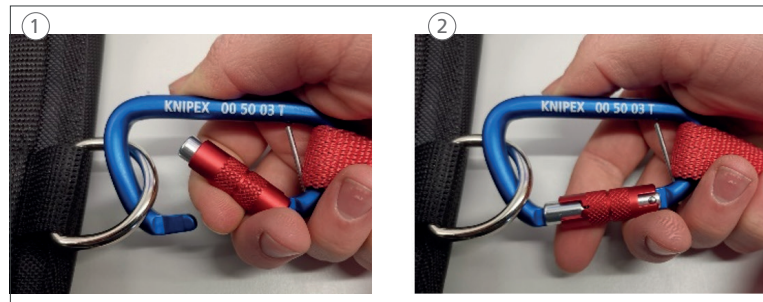

Figure 9: Connection via carabiner

1. Open the self-locking carabiner by rotating the red locking gate and pushing the latch inside and connect it to the captive engineered tether point on the tool.
2. Make sure there is clearance for the locking gate of the carabiner to close.

4.3 Connecting the Lanyard to primary anchoring locations (body, lifting device, or structure)

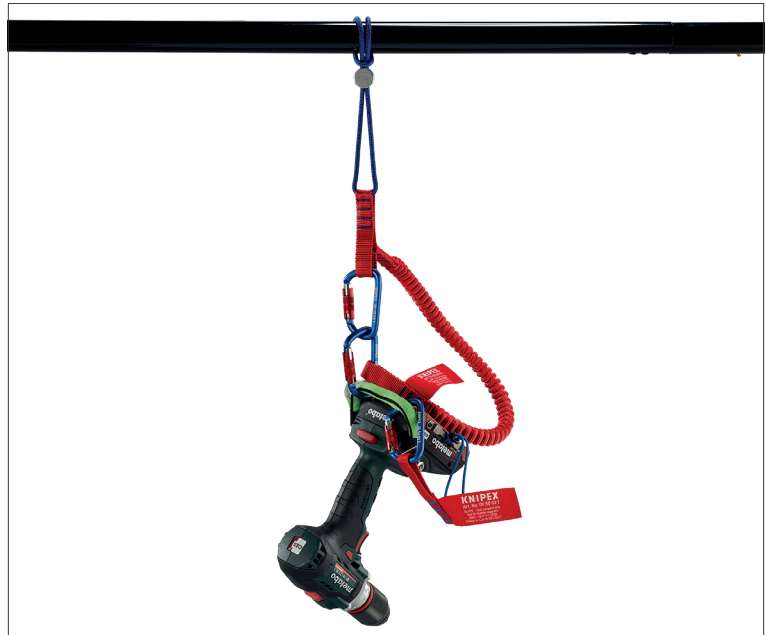

Figure 10: Lanyard anchored to a structure

1. Tools that exceed 2.26 kg (5 lbs) must be anchored to a structural anchor or lifting device, not to the users body.
2. The best practice is to always anchor your Lanyard to a structure other than the users body. If the user does anchor the Lanyard to their body, take great care selecting the anchor location and always be sure to have a secure stand, because falling tools can make you loose your balance.
3. For any questions or concerns about selecting appropriate anchor points, consult a qualified person.

Attach the other end of the Lanyard to an anchor point that is suitable and reliable for tool tethering either by loop or by a carabiner (see Chapter 4.1.3, figure 8 and 4.1.4).

4.4 Connecting Adapter Straps

To connect a KNIPEX Adapter Strap:

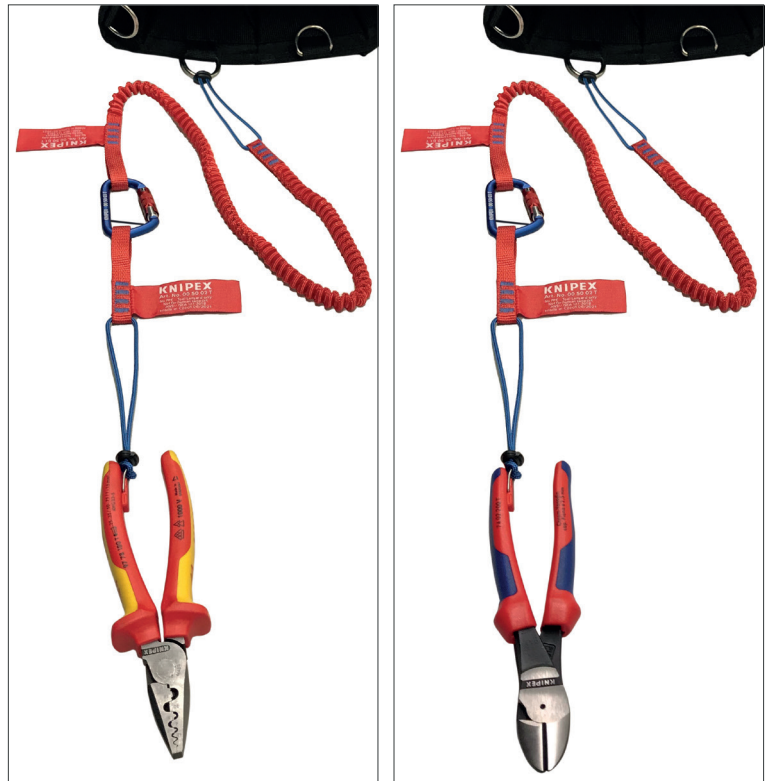

Figure 11: Connecting Adapter Straps

1. Connect the Adapter Strap to the tool via loop as described in chapter 4.1.3.
2. Connect the Adapter Strap to the Lanyard or anchor point via carabiner as described in chapter 4.1.4.

4.5 Using the tethering system

- Always keep tools tethered while working at heights. When exchanging tools, use a 100 % tie-off by ensuring the tool is tethered to a secondary anchor before disconnecting from the initial anchor point.
- When using KNIPEX Tool Lanyards and Adapter Straps, determine the fully stretched length of the Lanyard used, plus the length of the Adapter Strap if used, plus the tool itself. Add an additional safety factor to ensure an adequate clearance between where the Lanyard is anchored and the nearest person or object.

The 6 kg (13.2 lbs) version of the Lanyard is equipped with a second flat belt loop for abridged connection (see figure 3, Pos. 8). A second carabiner, which is hooked into this additional flat belt loop, can bridge the elastic part of the Lanyard. This prevents the tool from hanging down far and the abridged connection keeps the tool closer to the attachment point when the tool is not in use.

Attention!

This flat belt loop for abridged connection must never be used to secure a tool for fall protection (figure 12).

OPERATION

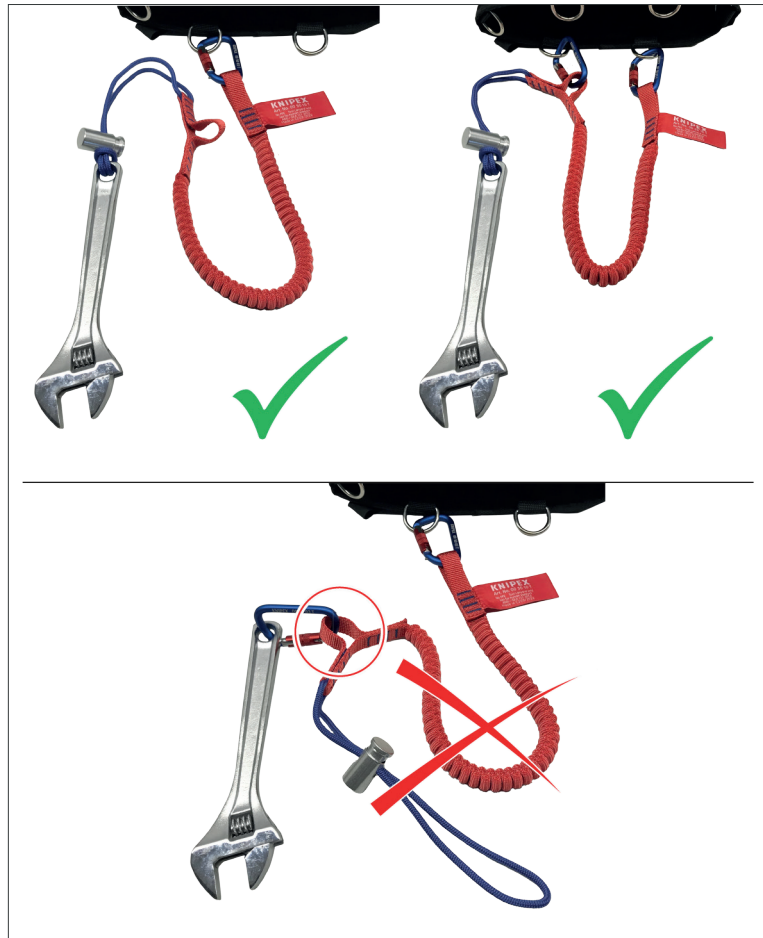

Figure 12: Abridge connection

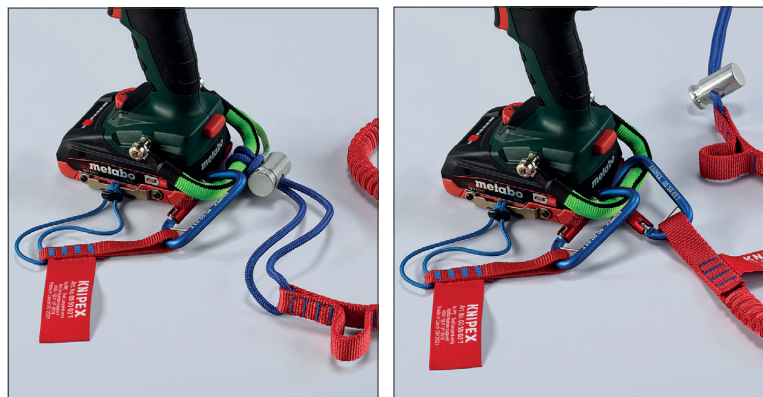

Figure 13: Attachment to a battery tool (over the loop or via carabiner)

Attention!
Also attach the battery.

5 Inspection

KNIPEX TetheredTools equipment and components must be thoroughly inspected before each use. Any KNIPEX TetheredTools component that has deformities, unusual wear or deterioration must be immediately removed from service and destroyed.

Inspect the entire surface of the component, carefully rotating it while visually inspecting for damage or wear that might affect its usability and dependability. Inspect material and stitching, hardware, Carabiners, D-Rings and connectors all operate. In any doubt, please ask your supervisor for help.

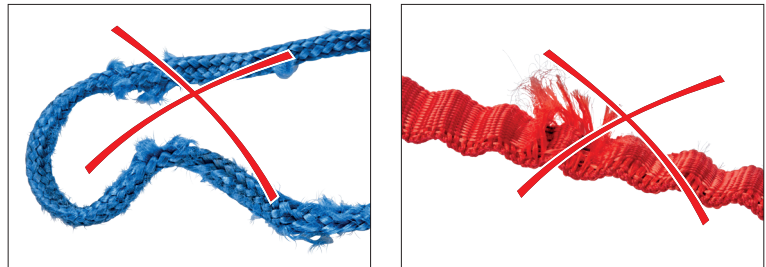

Figure 14: Remove KNIPEX TetheredTools components from service if damaged

Do not use tools with TetheredTool Clip if the clip is deformed or has sharp edges.

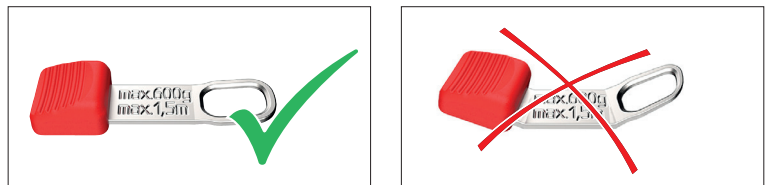

Figure 15: Do not use tools when clip is deformed or has sharp edges

Do not use the TetheredTool Clip if the handle of the tool is damaged (e.g. due to cracks).



Figure 16: Do not use the TetheredTool Clip if the handle of the tool is damaged

6 Storage and Care

- Store tool Lanyards and Adapter Straps in a clean, dry location away from direct sunlight.
- To clean, use mild soap and water. Allow Lanyards and Adapter Straps to air dry only.

7 Disclaimer

In no event, shall KNIPEX-WERK C. Gustav Putsch KG be liable for any direct, indirect, punitive, incidental, special, or consequential damages arising out of, or associated with the misuse of KNIPEX TetheredTools Lanyards and Adapter Straps.



KNIPEX-Werk
C. Gustav Putsch KG

42337 Wuppertal

Tel.: +49 202 – 47 94-0
Fax: +49 202 – 47 74 94

info@knipex.com
www.knipex.com



Operating instructions

en **TetheredTool Clip (TTC)**
for attaching tools to the KNIPEX
tethering system

00 62 10 TR

00 63 06 TCR



CONTENTS

1	General	3
1.1	Notes on operating instructions	3
1.2	Symbols used	3
1.3	Copyright	3
1.4	Guarantee and warranty	3
2	Safety	4
2.1	Intended use	4
3	Products and accessories	5
3.1	TetheredTool Clips (TTC) and ColorCode Clips	5
3.2	Possible accessories	5
4	Operation	6
4.1	Attaching the clip to the tool	6
4.2	Attaching the tether and/or adapter strap (3.3 lbs)	7
5	Maintenance	8
6	Technical data	8
6.1	Technical data	8
7	Disposal	8

1 General

1.1 Notes on operating instructions

These operating instructions are designed to enable you to use your tool safely and efficiently.

The tool may only be used if it is in technically perfect condition.

As a consequence of technical developments, the illustrations and descriptions contained in these operating instructions may differ slightly from the tool actually delivered.

We do not accept any liability for damage caused by failure to observe these operating instructions.

1.2 Symbols used

All safety instructions in these operating instructions are indicated by corresponding symbols. The signal words at the beginning of each safety instruction express the extent of the Hazard.



Danger!

Level 1 risk source

This combination of symbol and signal word indicates an imminently hazardous situation that will result in death or serious injury if not avoided.



Warning!

Level 2 risk source

This combination of symbol and signal word indicates a possibly hazardous situation that may result in death or serious injury if not avoided.



Caution!

Level 3 risk source

This combination of symbol and signal word stands for important information that helps to prevent damage to property or the environment.

1.3 Copyright

These operating instructions and all documentation supplied with this tool are protected by copyright and remain the property of KNIPEX.

The reprinting of these instructions, even in extract form, is only permitted with the written consent of KNIPEX C. Gustav Putsch KG.

1.4 Guarantee and warranty

The manufacturer grants a statutory warranty in accordance with the current sales and delivery conditions. No further warranties or assurances are granted.

Within the warranty period, the warranty covers the rectification of all defects that can be traced back to material faults or manufacturing errors.

Wearing parts are excluded from the warranty.

The repair or replacement of a tool shall not result in an extension of the warranty period. Tools shall only be repaired or replaced with „as new“ parts, whose function corresponds to that of the old parts. All defective and hence replaced parts are the property of the manufacturer.

Warranty claims shall expire in particular if:

- Damage is caused through improper operation, use for purposes other than those specified by the manufacturer, or poor maintenance.
- Repairs or conversions are carried out by unauthorized persons.
- Original accessories or spare parts from KNIPEX are not used.
- Defective components are not repaired immediately to minimise the extent of the damage and so as not to impair the safety of the tool (obligation to repair).

For the rest, reference is made to the liability and warranty regulations of the current sales and delivery conditions.

2 Safety

2.1 Intended use

The tool is intended for the following uses:

- The TetheredTool clips (TTCs) are intended as elements of the KNIPEX tethering systems for attaching tools. The weight of the tool must not exceed the permissible load capacity of the individual tethering system components.
- Only connect KNIPEX TetheredTool clips, tethers or adapter straps to tools that have a structural attachment point.

Any use beyond the intended purpose or any unauthorized modification shall be considered improper. The operator shall be liable for damages resulting from improper use.

Intended use also includes adhering to these operating instructions. They must be read in full before use.

Users must be trained in tethering tools and using tools safely at height. To reduce the hazards of working with tools at height, the following instructions must be followed to avoid the risk of property damage, serious injury or death.



Danger!

Fall hazard from slipping, stumbling, twisting and people falling onto a lower surface or object!

Do not use the product for supporting people or animals or as part of a fall arrest system for people.



Danger!

Risk of injury from moving parts!

Do not use the product near machines with unprotected rotating or moving parts!

3 Products and accessories

3.1 TetheredTool Clips (TTC) and ColorCode Clips



Article number	Designation	Number of pieces	Colour
00 62 10 TR	TetheredTool Clips	10	red
00 63 06 TCR	TetheredTool Clips + ColorCode Clips	3 pieces each	red

3.2 Possible accessories



Article number	Designation	Unstretched length	Stretched length	Load capacity
00 50 01 T	Lanyard	1000 mm (38")	1500 mm (59")	1.5 kg (3.3 lbs)
00 50 02 T	Adapter Straps	260 mm (10")	260 mm (10")	1.5 kg (3.3 lbs)
00 50 05 T	Tether with carabiner	1080 mm (38")	1580 mm (60")	1.5 kg (3.3 lbs)
00 50 06 T	Adapter straps with carabiner with captive eyelet	340 mm (13")	340 mm (13")	1.5 kg (3.3 lbs)

You can find more accessories at the following link:
<https://www.knipex.de/produkte/griffhuellen-zubehoer>

4 Operation



Warning!

Defective product warning!

Before each use, visually inspect the clip and the interface on the tool for intactness (e.g. cracks, sharp edges or deformation).



Warning!

Warning against use with unsuitable products!

Only connect the TTCs to KNIPEX accessories.

4.1 Attaching the clip to the tool



Attaching the TTC

1. Slide the clip into the interface on the tool handle from the inside.
2. Push the clip into the interface as far as it will go to create a secure connection.

4.2 Attaching the tether and/or adapter strap (3.3 lbs)

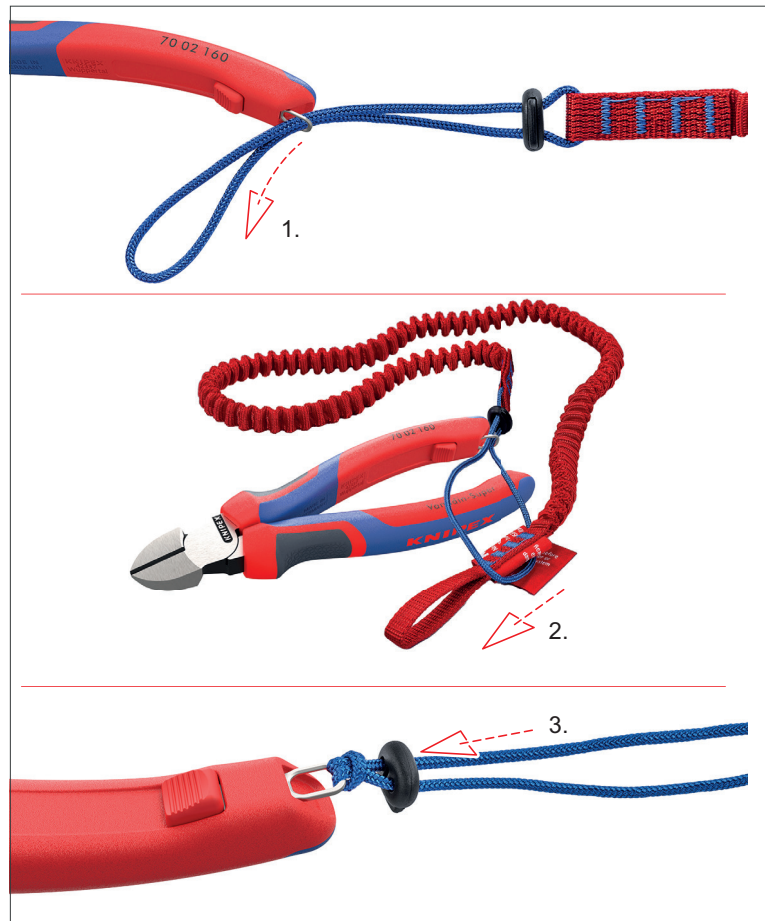

Attaching the tether

1. Pass the end of the strap through the interface of the TetheredTool clip (TTC).
2. Thread the carabiner end of the tether or adapter strap through the strap and pull tight to create a secure connection.
3. Press the rope stopper firmly onto the cinch.

5 Maintenance

The tool is maintenance-free.

To better check the product visually for damage, clean it with lukewarm soapy water if necessary.

6 Technical data

6.1 Technical data

Technical data	Unit	
Article number TTC	–	00 62 10 TR
Length	mm	30
width	mm	9
Weight approx.	g	4.5
Max. tool weight approx.	g	600
Max. tether length	m	1.5
Temperature operating range	°C	-35 – +45

7 Disposal

The product can be disposed of as household waste.



KNIPEX-Werk
C. Gustav Putsch KG

42337 Wuppertal

Tel.: +49 202 – 47 94-0
Fax: +49 202 – 47 74 94

info@knipex.com
www.knipex.com