

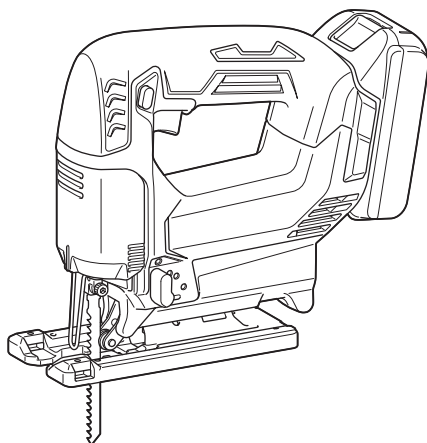

<b>EN</b>	<b>Cordless Jig Saw</b>	<b>INSTRUCTION MANUAL</b>	<b>8</b>
<b>ZHCN</b>	<b>充电式曲线锯</b>	<b>使用说明书</b>	<b>17</b>
<b>ID</b>	<b>Gergaji Jig Tanpa Kabel</b>	<b>PETUNJUK PENGGUNAAN</b>	<b>27</b>
<b>MS</b>	<b>Gergaji Jig Tanpa Kord</b>	<b>MANUAL ARAHAN</b>	<b>37</b>
<b>VI</b>	<b>Máy Cưa Lọng Cầm Tay Hoạt Động Bằng Pin</b>	<b>TÀI LIỆU HƯỚNG DẪN</b>	<b>47</b>
<b>TH</b>	<b>เลื่อยฉลุไร้สาย</b>	<b>คู่มือการใช้งาน</b>	<b>56</b>

**DJV186**

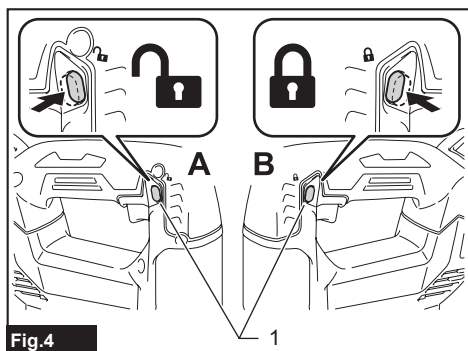

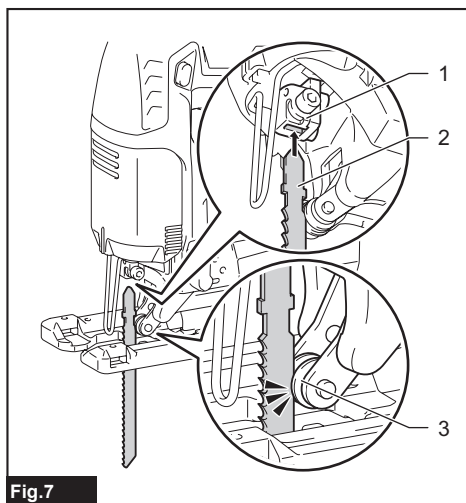
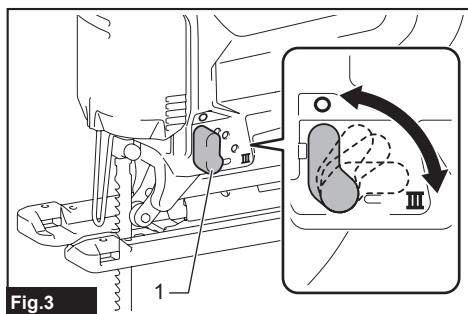
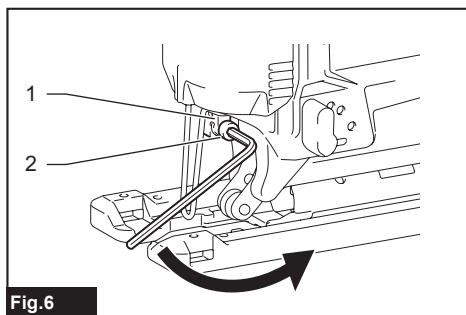
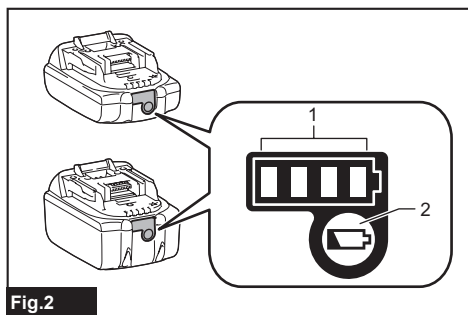
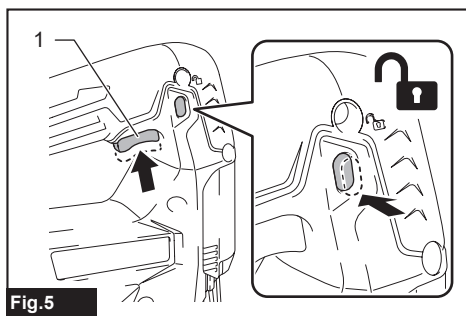
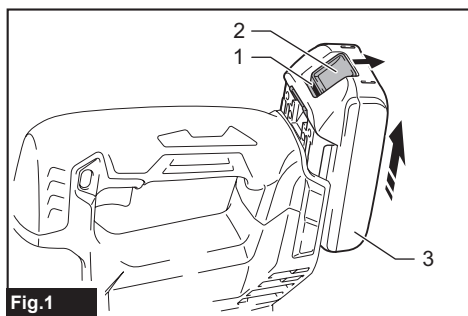

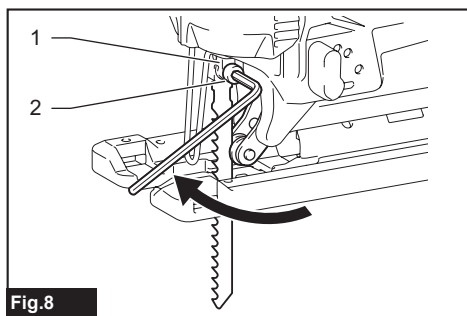

Fig.8

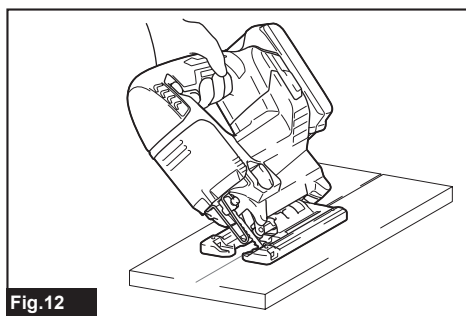

Fig.12

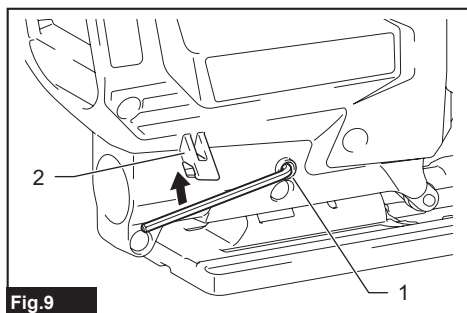

Fig.9

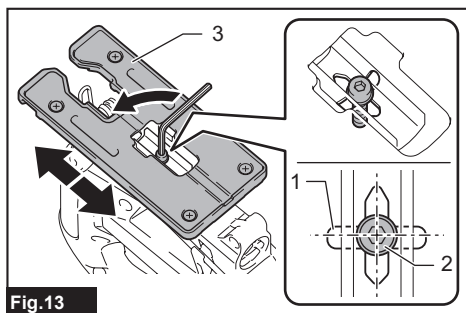

Fig.13

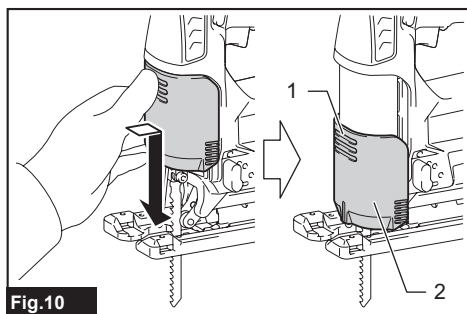

Fig.10

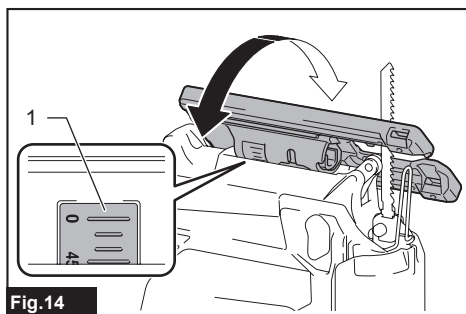

Fig.14

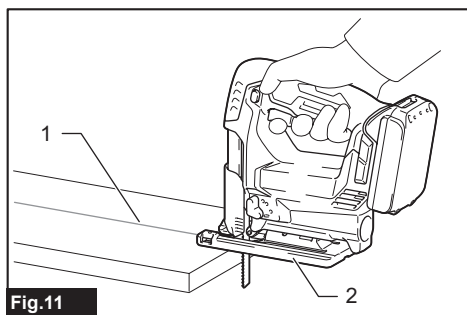

Fig.11

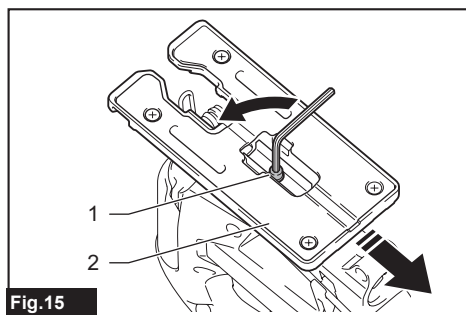

Fig.15

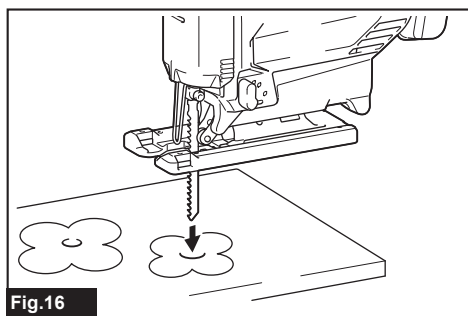

Fig.16

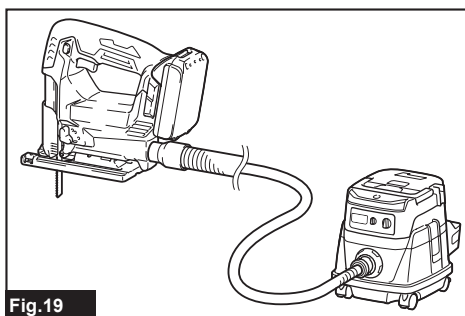

Fig.19

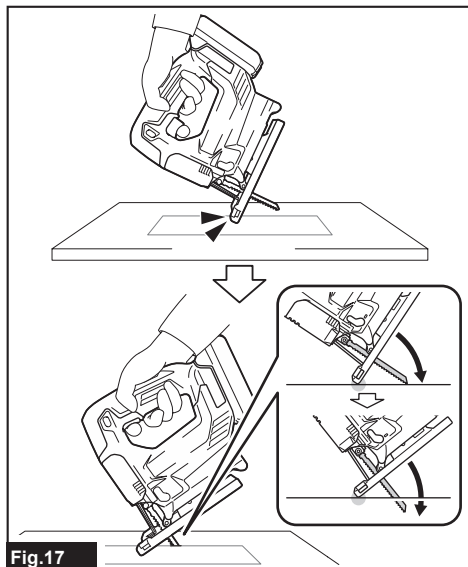

Fig.17

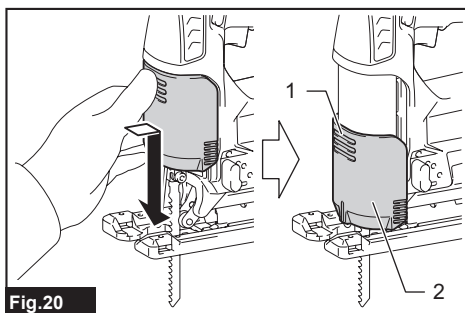

Fig.20

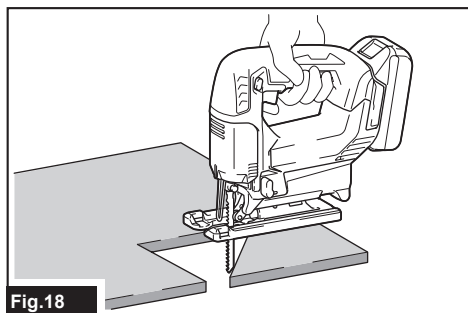

Fig.18

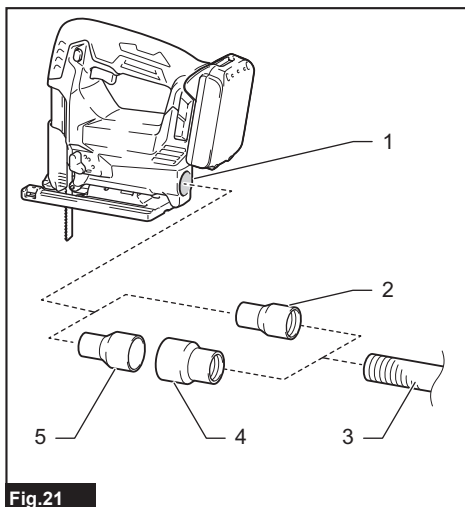

Fig.21

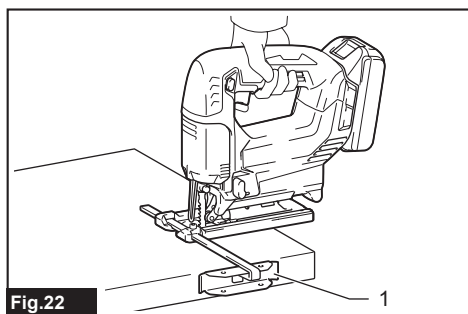

Fig.22

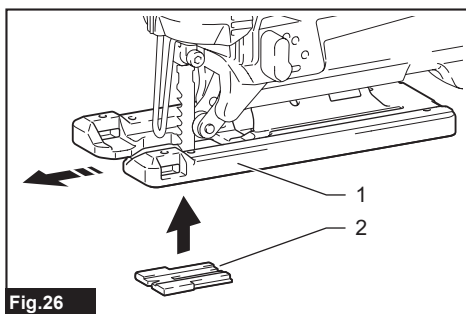

Fig.26

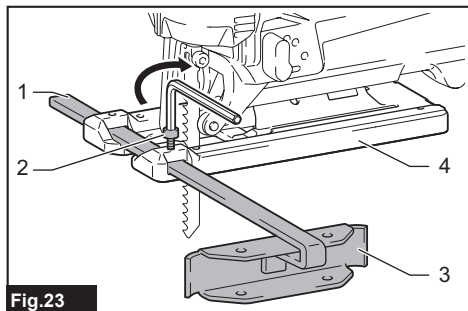

Fig.23

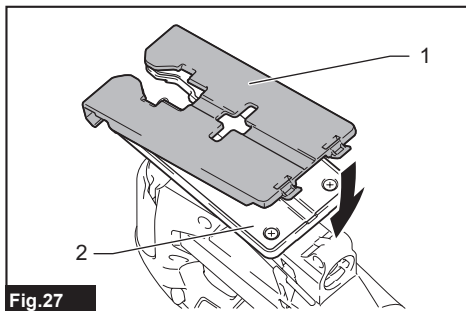

Fig.27

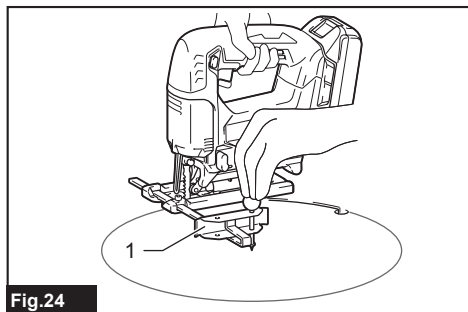

Fig.24

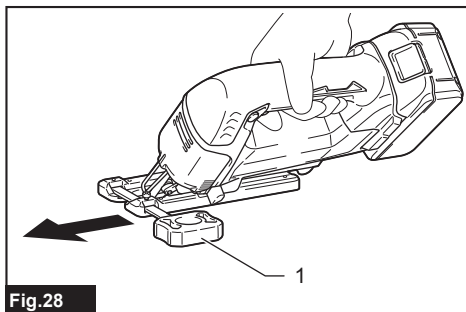

Fig.28

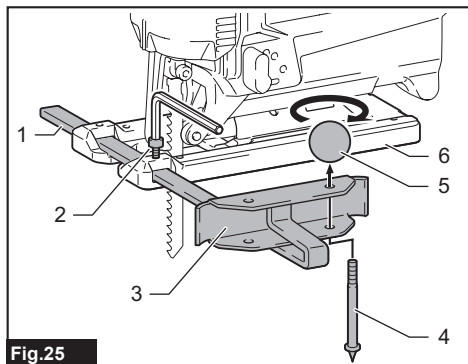

Fig.25

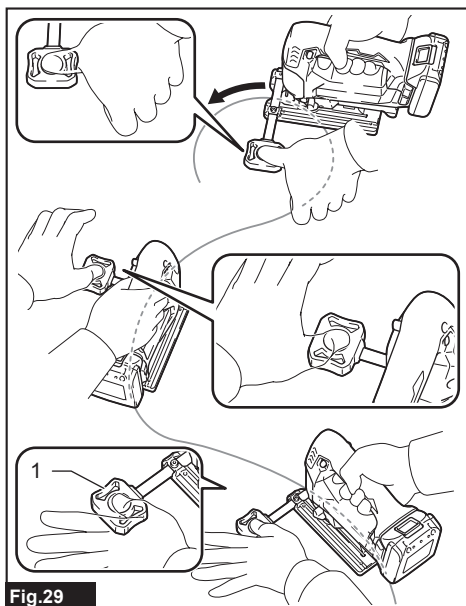

Fig.29

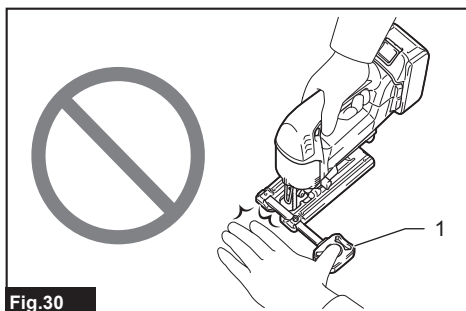

Fig.30

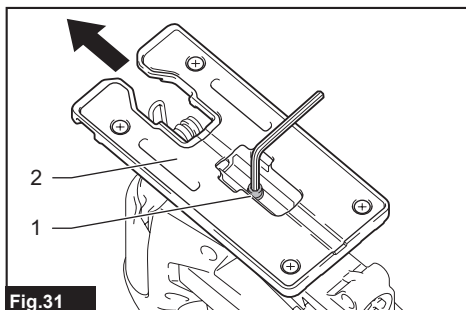

Fig.31

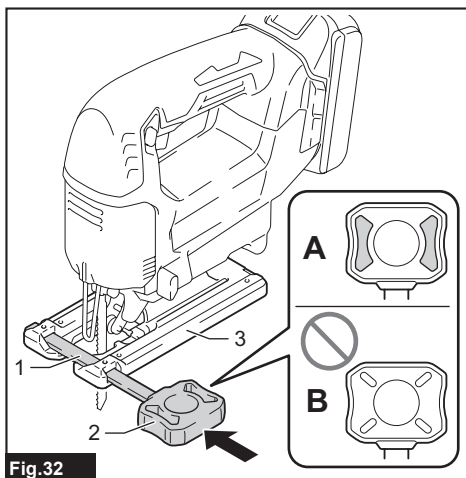

Fig.32

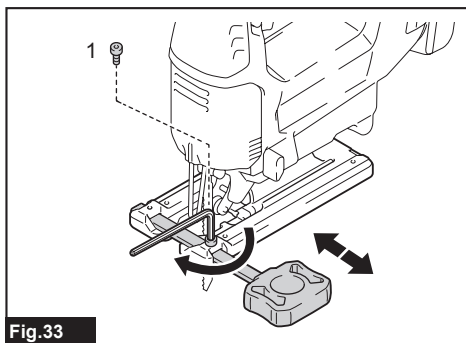

Fig.33

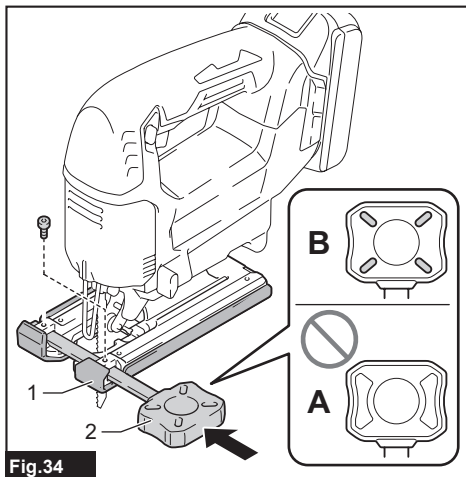
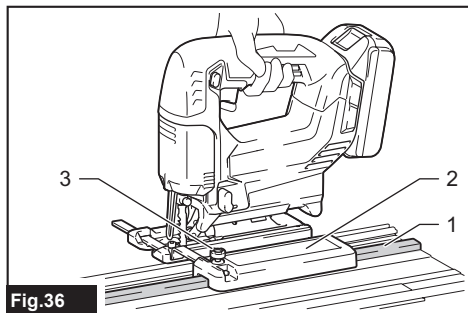
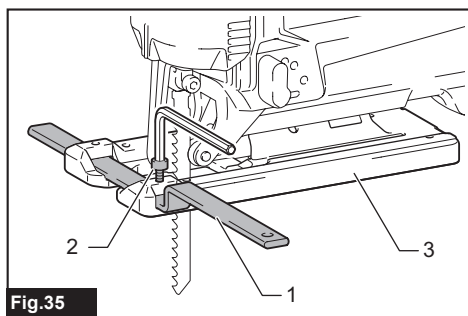

Fig.34



Tài liệu được tổng hợp bởi đội ngũ kỹ thuật của **NPOWER** Bản quyền nội dung thuộc về **MAKITA**  
**[www.npower.com.vn](http://www.npower.com.vn)** Powered by **NAVITECH** | [www.navitech.co](http://www.navitech.co)

SPECIFICATIONS

Model:		DJV186
Length of stroke		18 mm
Strokes per minute		0 - 2,900 min <sup>-1</sup>
Blade type		B type
Max. cutting capacities	Wood	65 mm
	Mild steel	6 mm
	Aluminum	10 mm
Overall length (with BL1860B)		257 mm
Rated voltage		D.C. 18 V
Net weight		1.9 - 2.2 kg

- Due to our continuing program of research and development, the specifications herein are subject to change without notice.
- Specifications may differ from country to country.
- The weight may differ depending on the attachment(s), including the battery cartridge. The lightest and heaviest combination are shown in the table.

Applicable battery cartridge and charger

Battery cartridge	BL1815N / BL1820B / BL1830B / BL1840B / BL1850B / BL1860B
Charger	DC18RC / DC18RD / DC18RE / DC18SD / DC18SE / DC18SF / DC18SH / DC18WC

- Some of the battery cartridges and chargers listed above may not be available depending on your region of residence.

**⚠WARNING:** Only use the battery cartridges and chargers listed above. Use of any other battery cartridges and chargers may cause injury and/or fire.

Symbols

The followings show the symbols which may be used for the equipment. Be sure that you understand their meaning before use.



Read instruction manual.



Wear eye protection.



Only for EU countries  
Due to the presence of hazardous components in the equipment, waste electrical and electronic equipment, accumulators and batteries may have a negative impact on the environment and human health. Do not dispose of electrical and electronic appliances or batteries with household waste!  
In accordance with the European Directive on waste electrical and electronic equipment and on accumulators and batteries and waste accumulators and batteries, as well as their adaptation to national law, waste electrical equipment, batteries and accumulators should be stored separately and delivered to a separate collection point for municipal waste, operating in accordance with the regulations on environmental protection.  
This is indicated by the symbol of the crossed-out wheeled bin placed on the equipment.

Intended use

The tool is intended for the sawing of wood, plastic and metal materials.