

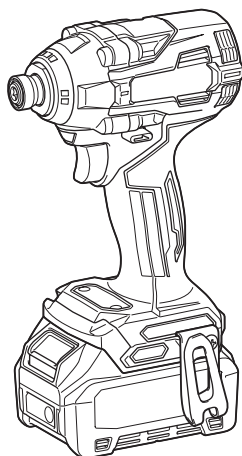

EN	Cordless Impact Driver	INSTRUCTION MANUAL	5
ZHCN	充电式冲击起子机	使用说明书	15
ID	Obeng Ketok Listrik Tanpa Kabel	PETUNJUK PENGGUNAAN	25
MS	Pemacu Impak Tanpa Kord	MANUAL ARAHAN	35
VI	Máy Bắt Vít Cầm Tay Hoạt Động Bằng Pin	TÀI LIỆU HƯỚNG DẪN	45
TH	สว่านไขควงกระแทกแบบไร้สาย	คู่มือการใช้งาน	55

TD004G



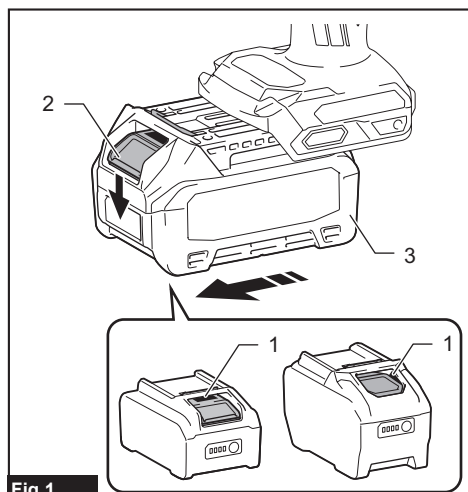

Fig.1

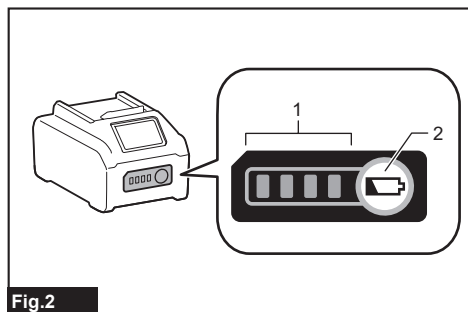

Fig.2

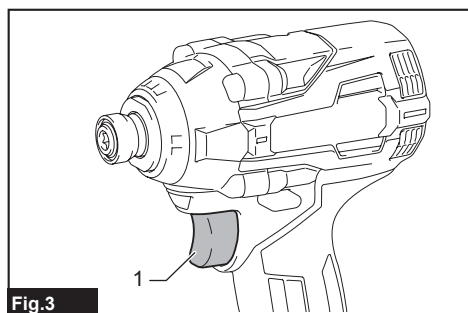

Fig.3

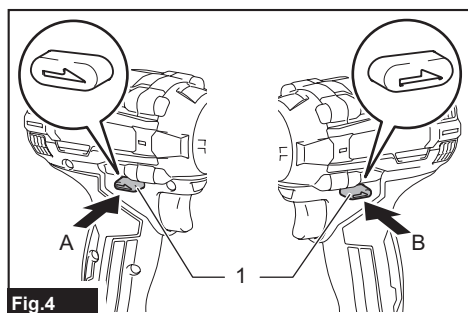

Fig.4

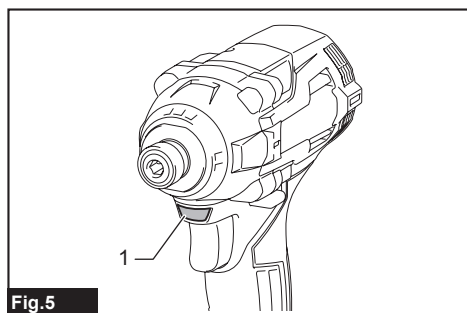

Fig.5

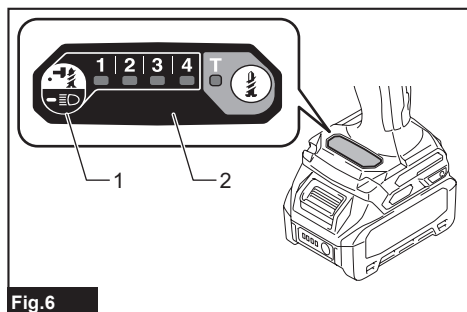

Fig.6

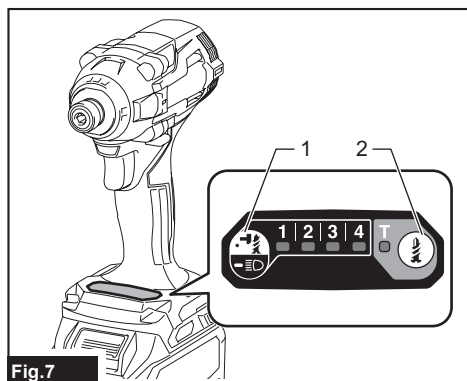

Fig.7

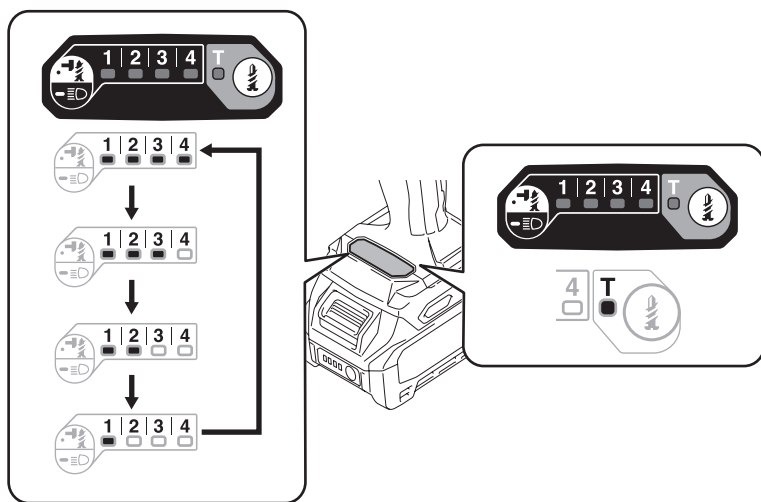

Fig.8

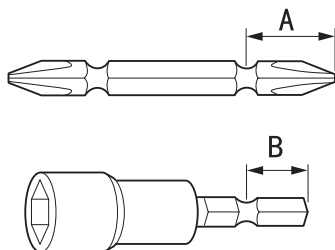

Fig.9

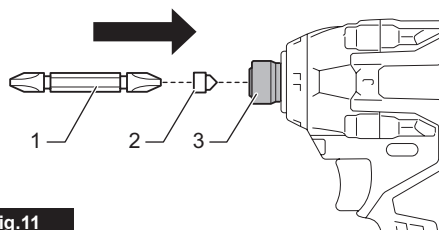

Fig.11

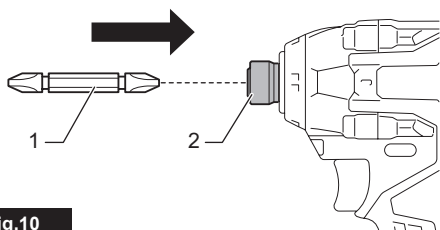

Fig.10

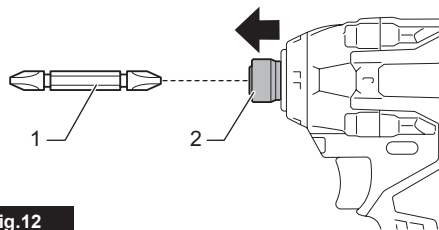
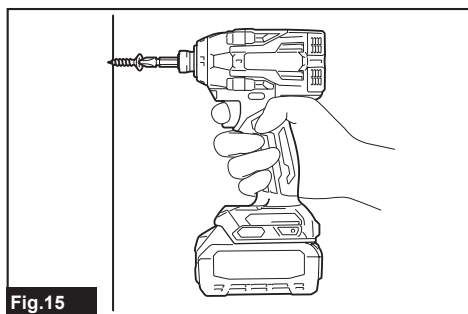
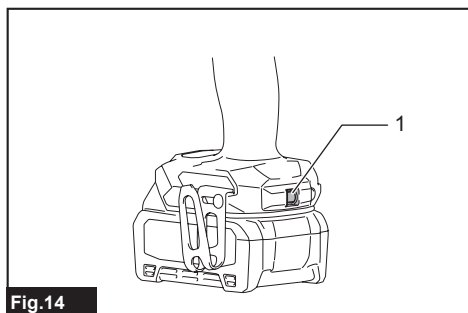
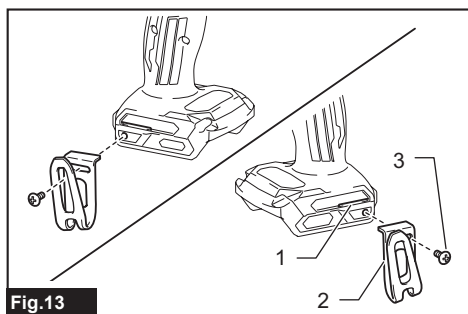

Fig.12



SPECIFICATIONS

Model:		TD004G
Fastening capacities	Machine screw	M4 - M8
	Standard bolt	M5 - M20
	High tensile bolt	M5 - M14
No load speed (RPM)	4 (Max impact mode)	0 - 3,900 min ⁻¹
	3 (Hard impact mode)	0 - 3,000 min ⁻¹
	2 (Medium impact mode)	0 - 2,100 min ⁻¹
	1 (Soft impact mode)	0 - 1,200 min ⁻¹
	T mode	0 - 2,400 min ⁻¹
Impacts per minute	4 (Max impact mode)	0 - 3,900 min ⁻¹
	3 (Hard impact mode)	0 - 3,600 min ⁻¹
	2 (Medium impact mode)	0 - 3,100 min ⁻¹
	1 (Soft impact mode)	0 - 1,900 min ⁻¹
	T mode	-
Rated voltage		D.C. 36 V - 40 V max
Overall length		136 mm
Net weight		1.8 - 3.1 kg

- Due to our continuing program of research and development, the specifications herein are subject to change without notice.
- Specifications may differ from country to country.
- The weight may differ depending on the attachment(s), including the battery cartridge. The lightest and heaviest combination are shown in the table.

Applicable battery cartridge and charger

Battery cartridge	BL4020* / BL4025* / BL4040* / BL4040F* / BL4050F / BL4080F * : Recommended battery
Charger	DC40RA / DC40RB / DC40RC / DC40WA / BCC01 / BCC02

- Some of the battery cartridges and chargers listed above may not be available depending on your region of residence.

⚠WARNING: Only use the battery cartridges and chargers listed above. Use of any other battery cartridges and chargers may cause injury and/or fire.

Symbols

The followings show the symbols which may be used for the equipment. Be sure that you understand their meaning before use.



Read instruction manual.



Ni-MH
Li-ion

Only for EU countries

Due to the presence of hazardous components in the equipment, waste electrical and electronic equipment, accumulators and batteries may have a negative impact on the environment and human health. Do not dispose of electrical and electronic appliances or batteries with household waste!

In accordance with the European Directive on waste electrical and electronic equipment and on accumulators and batteries and waste accumulators and batteries, as well as their adaptation to national law, waste electrical equipment, batteries and accumulators should be stored separately and delivered to a separate collection point for municipal waste, operating in accordance with the regulations on environmental protection.

This is indicated by the symbol of the crossed-out wheeled bin placed on the equipment.