



Nothing but **HEAVY DUTY.**™



M18 BLPDRC

- ⓔⓃ User Manual
- Ⓩⓗ 操作指南
- Ⓩⓗ 操作指南
- Ⓚⓞ 사용시 주의사항
- Ⓣⓗ คู่มือการใช้งาน
- ⓔⓓ Buku Petunjuk Pengguna
- Ⓥⓞ Cẩm nang hướng dẫn sử dụng
- ⓙⓐ 取扱説明書

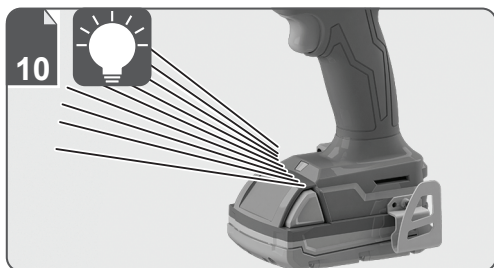
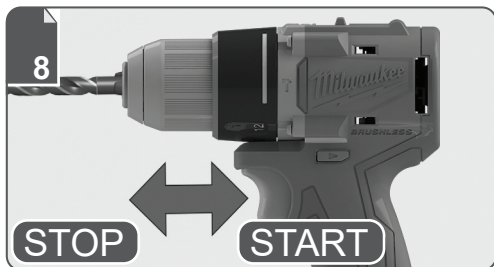
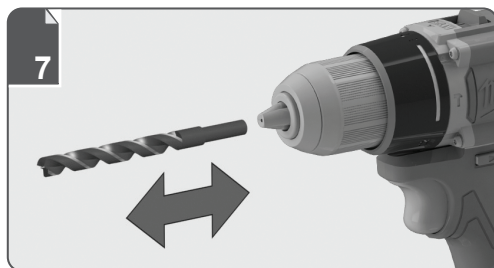
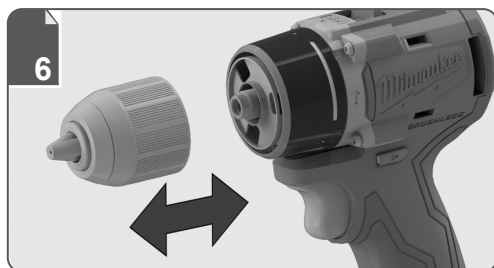

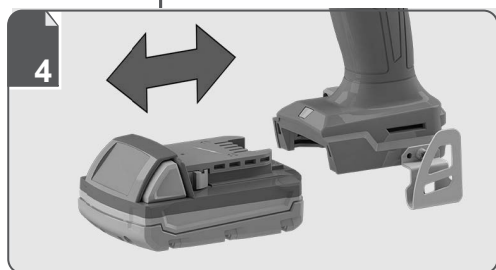
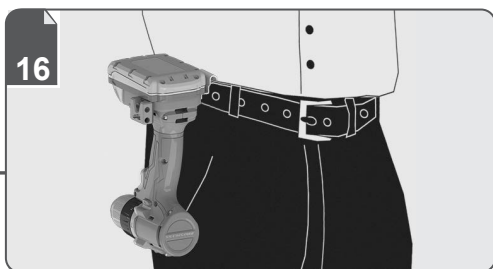
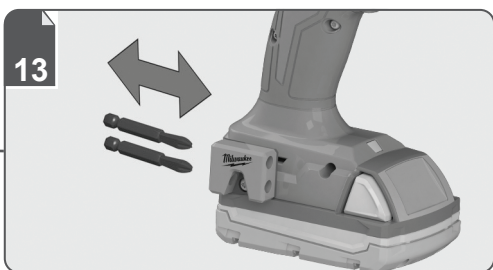
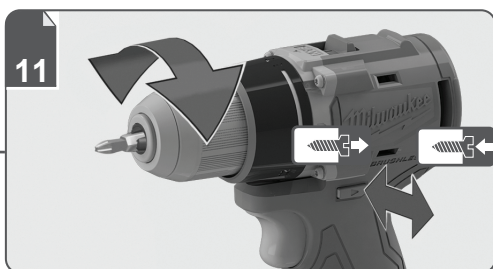
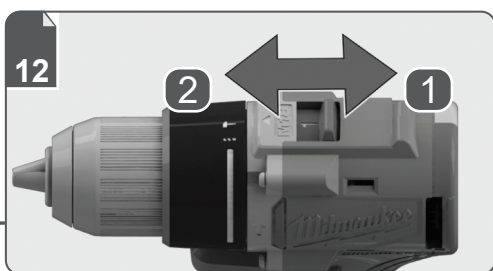

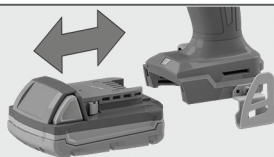

Remove the battery pack before starting any work on the product.

在產品上開始任何工作之前，請先取出電池組。

在产品上开始任何工作之前，请先取出电池组。

제품 사용 전, 배터리 팩을 제거하십시오.

ถอดชุดแบตเตอรี่ออกก่อนเริ่มการทำงานใด ๆ กับผลิตภัณฑ์

Lepaskan paket baterai sebelum memulai pekerjaan apa pun pada produk.

Tháo pin trước khi bắt đầu thao tác với sản phẩm.

製品のメンテナンス、アクセサリを交換する前に、バッテリーパックを取り外してください。

1



2

Click
啪嗒聲
啪嗒声
딸깍
คลิก
Klik
Tiếng tách
クリック



1

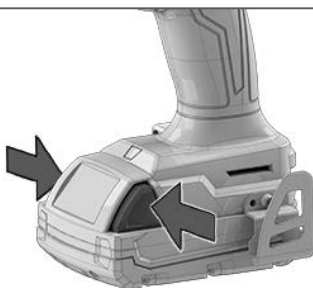

2



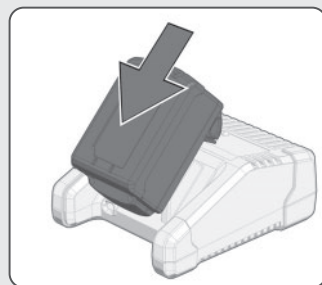
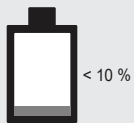
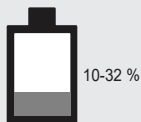
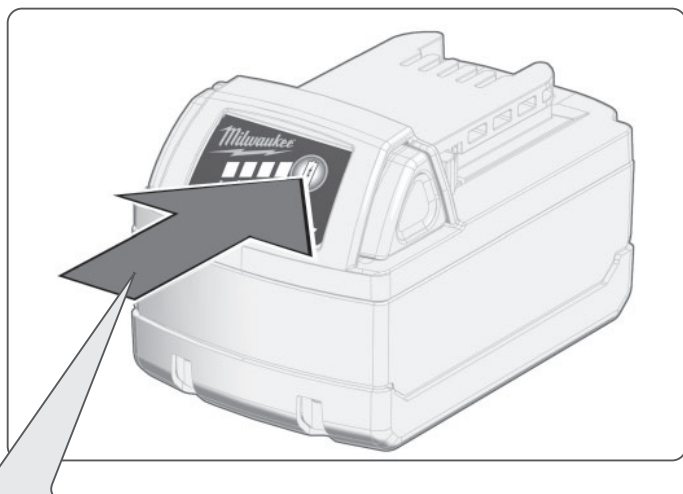

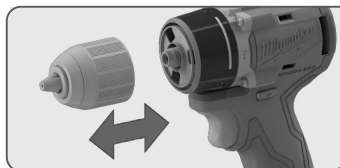

1

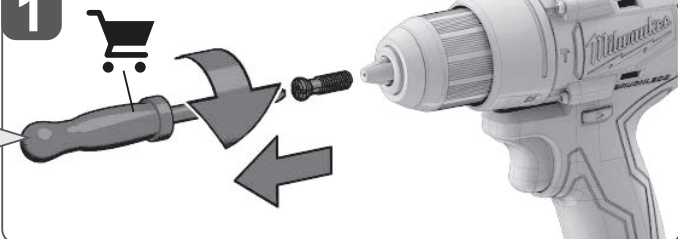

2

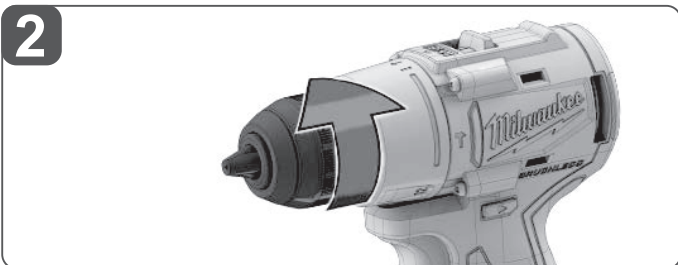

3

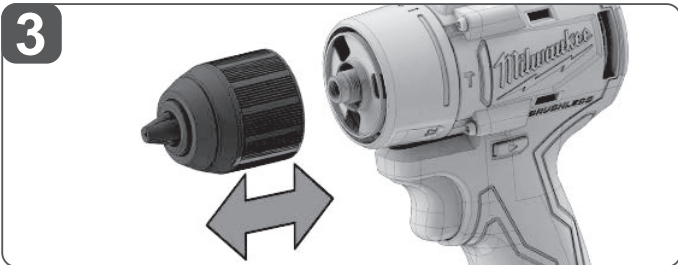

4

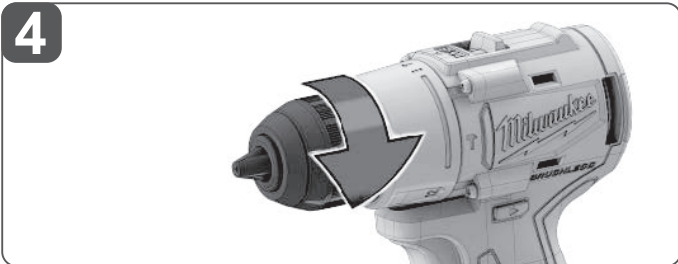

5

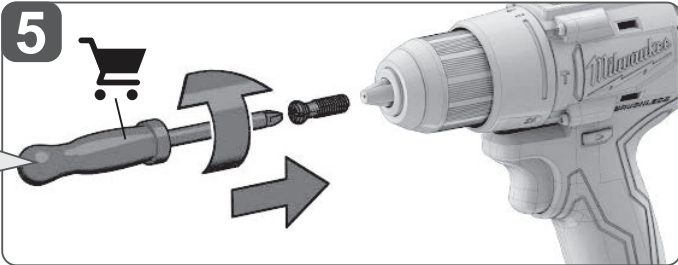

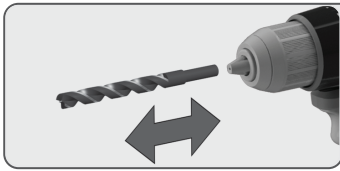

1

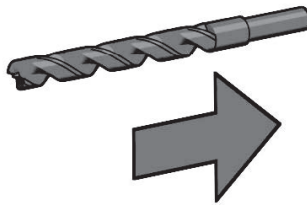

2

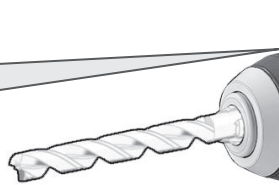
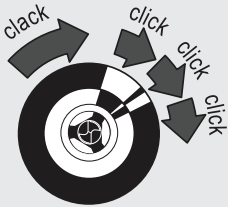

1

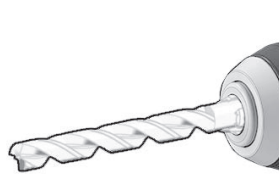

2

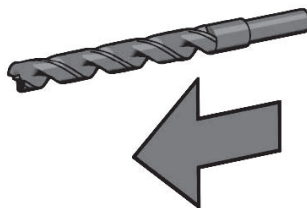



START

Start
開始
开始
시작
สตาร์ท
Mulai
Khởi động
スタート

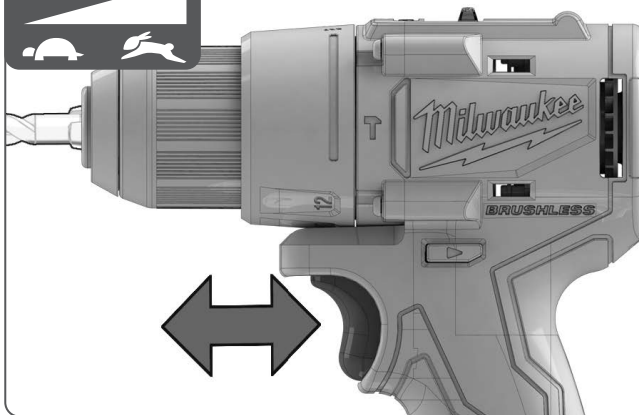
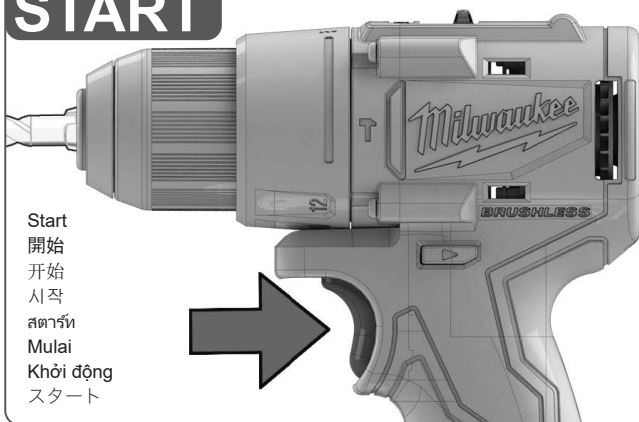

STOP

Stop
停止
停止
정지
หยุดเครื่อง
Berhenti
Dừng
ストップ





Insulated gripping surface

絕緣的把手

絶縁の把手

절연 그립 표면

พื้นผิวจับกันความร้อน

Permukaan genggam berinsulasi

Bề mặt tay cầm được cách điện

絶縁グリップ面

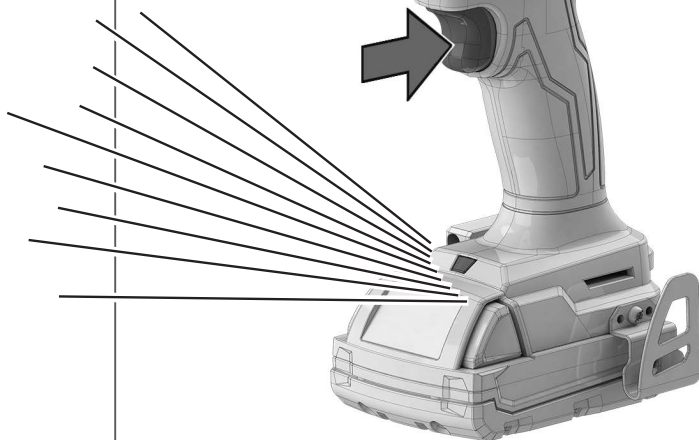

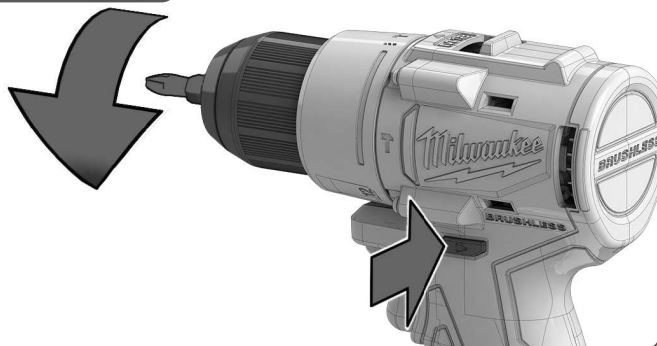
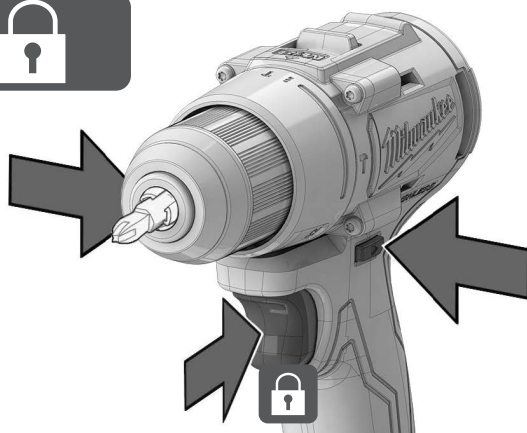
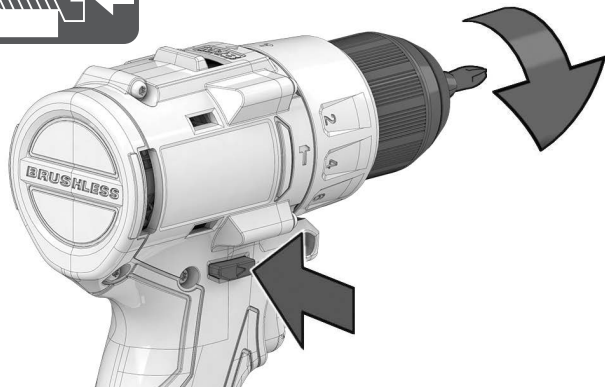

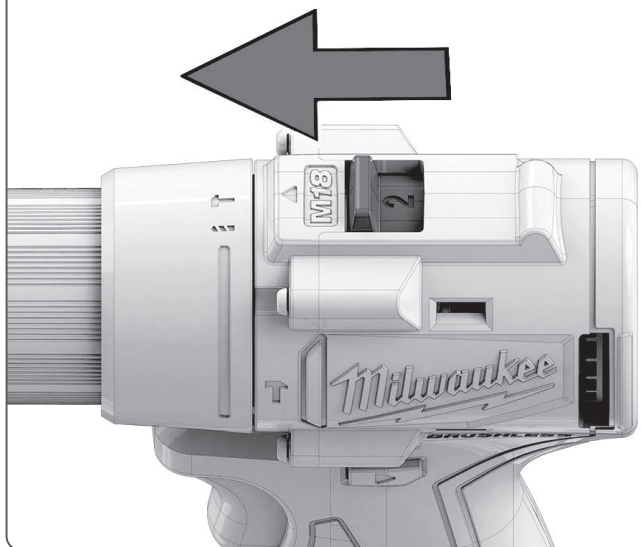
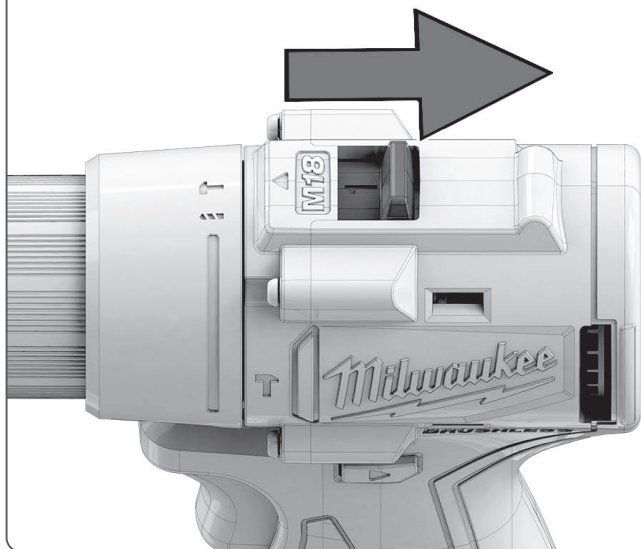
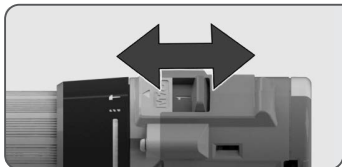

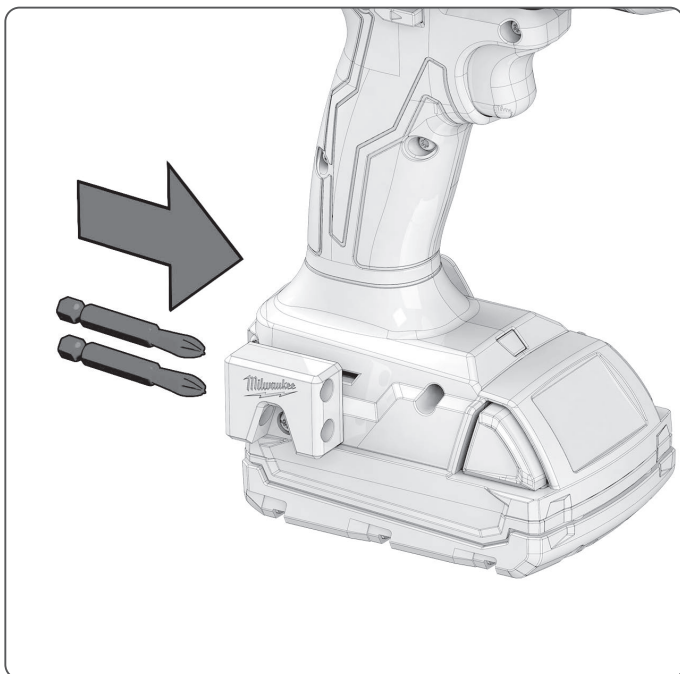
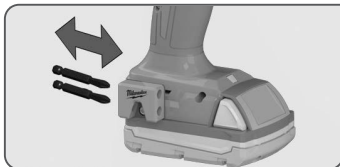

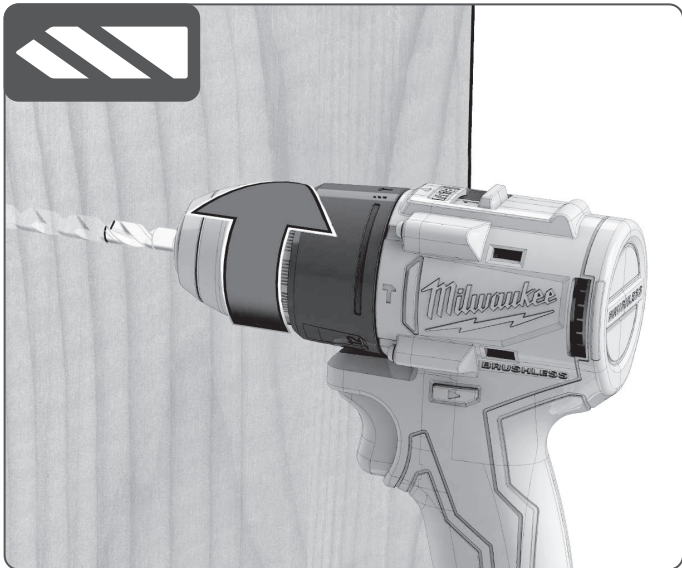
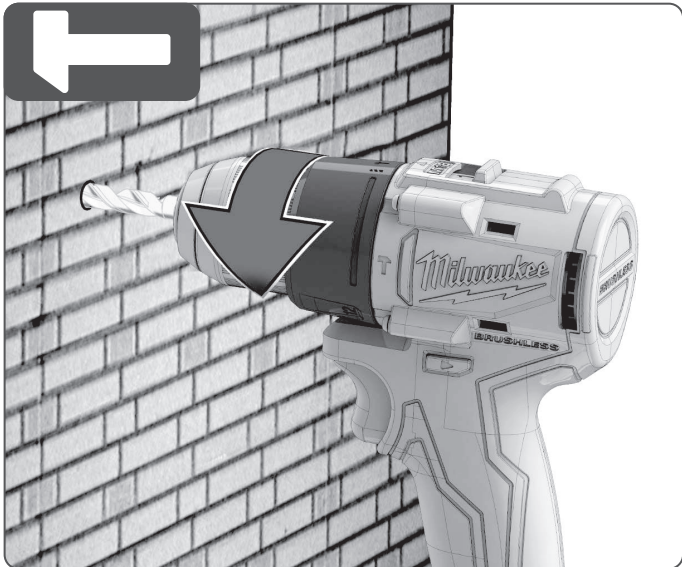



1...4...



...11...13



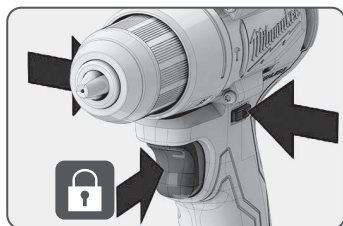
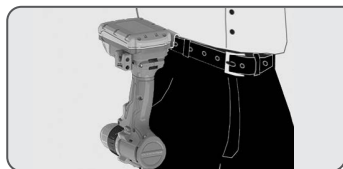

1

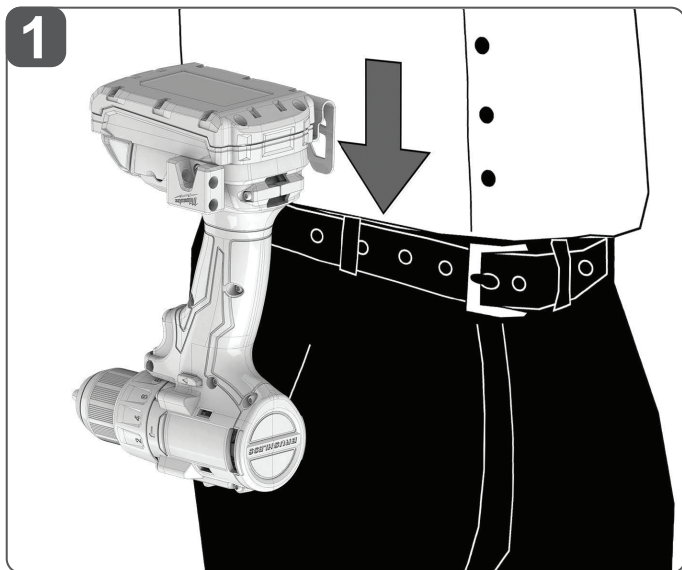

2

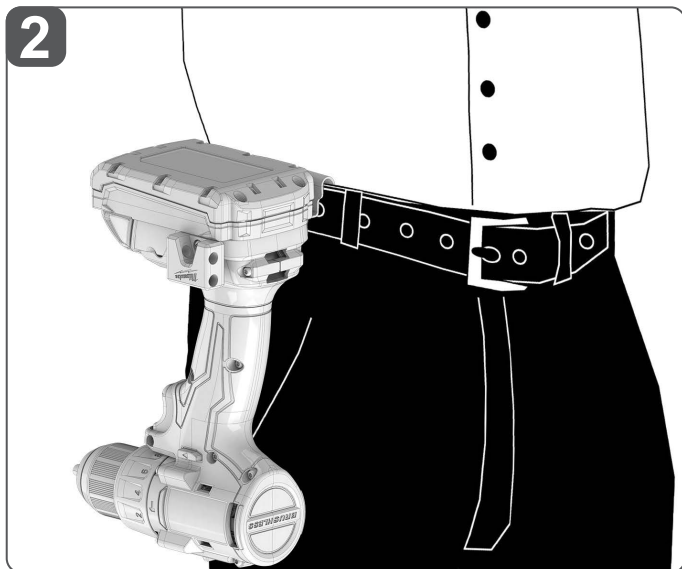

TECHNICAL DATA	M18 BLPDRC
Drilling capacity in steel	13 mm
Drilling capacity in wood	
with flat bit	32 mm
with auger bit	25 mm
with hole saw	51 mm
Drilling capacity in masonry	10 mm
Wood screws (without pre-drilling)	13 mm
No-load speed	
1st gear	0-550/min
2nd gear	0-1700/min
Impact rate	
1st gear	0-8250/min
2nd gear	0-25500/min
Max torque	60.5 Nm
Battery voltage	18 V
Weight (Li-ion 2.0 Ah - 5.0 Ah)	1.49 kg – 1.79 kg
Recommended ambient operating temperature	-18 °C – 50 °C
Recommended battery types	M18B..., M18 HB...
Recommended charger	M12-18..., M18 DFC, M18 PC6

Noise information

Noise emission values determined according to EN 62841

No-load drilling:

A-weighted sound pressure level	76.32 dB (A)
Uncertainty K	3.0 dB (A)
A-weighted sound power level	87.32 dB (A)
Uncertainty K	3.0 dB (A)

Impact drilling:

A-weighted sound pressure level	87.66 dB (A)
Uncertainty K	3.0 dB (A)
A-weighted sound power level	98.66 dB (A)
Uncertainty K	3.0 dB (A)

Always wear ear protectors.

Vibration information

Total vibration values (vector sum in the three axes) determined according to EN 62841

Vibration emission value a_h

Drilling into concrete	8.31 m/s ²
Uncertainty K	1.5 m/s ²
Drilling into metal	1.95 m/s ²
Uncertainty K	1.5 m/s ²



WARNING!

The declared vibration total values and the declared noise emission values given in this instruction manual have been measured in accordance with a standardised test and may be used to compare one tool with another. They may be used for a preliminary assessment of exposure.

The declared vibration and noise emission values represent the main applications of the tool. However, if the tool is used for different applications, used with different accessories, or poorly maintained, the vibration and noise emission may differ. These conditions may significantly increase the exposure levels over the total working period.

An estimation of the level of exposure to vibration and noise should take into account the times when the tool is turned off or when it is running idle. These conditions may significantly reduce the exposure level over the total working period.

Identify additional safety measures to protect the operator from the effects of vibration and noise, such as maintaining the tool and the accessories, keeping the hands warm (in case of vibration), and organising work patterns.