



Nothing but **HEAVY DUTY.**



## M18 FROS125

- EN User Manual
- ZH 操作指南
- ZH 操作指南
- KO 사용시 주의사항
- TH คู่มือการใช้งาน
- ID Buku Petunjuk Pengguna
- VI Cẩm nang hướng dẫn sử dụng
- JA 取扱説明書

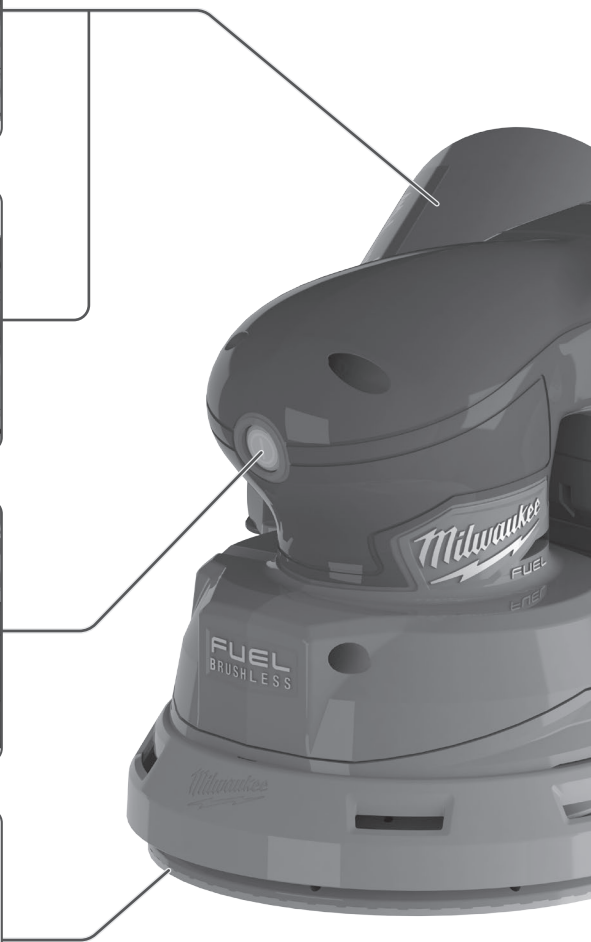
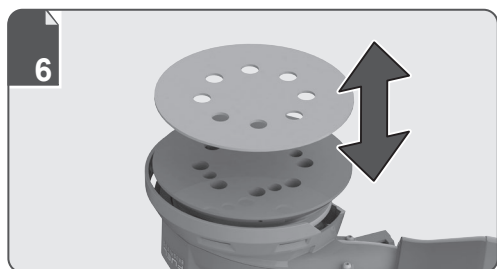
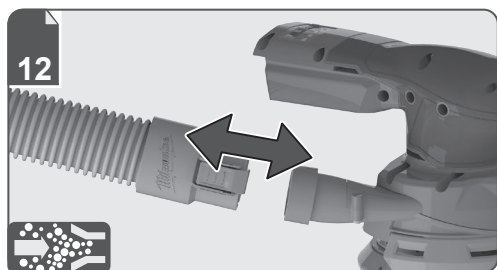
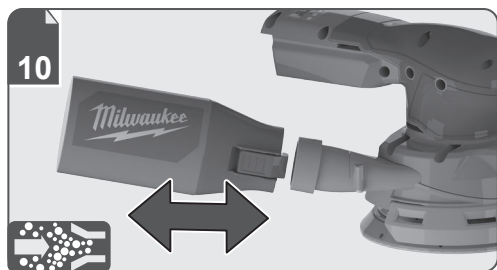

13

# VACLINK™

9



4



14

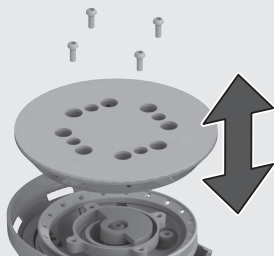

15





Remove the battery pack before starting any work on the product.

對產品進行任何工作前，先移除電池組。

在开始任何工作之前，请先取出电池。

제품을 청소하거나 분리하기 전, 배터리 팩을 제거하십시오.

ถอดแบตเตอรี่ออกก่อนเริ่มการบำรุงรักษา

Lepaskan paket baterai sebelum memulai pekerjaan apa pun pada produk.

Tháo pin trước khi bắt đầu thao tác với sản phẩm.

作業前の調整時や保守・点検時は、本体からバッテリーを取り外してください。

1

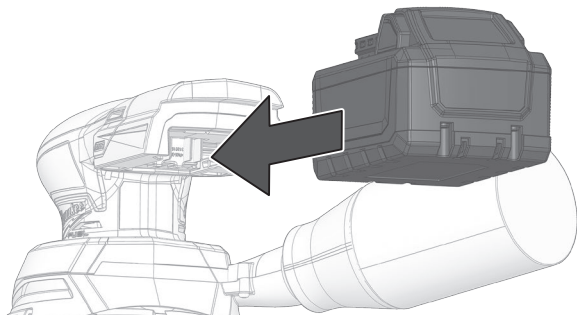

i

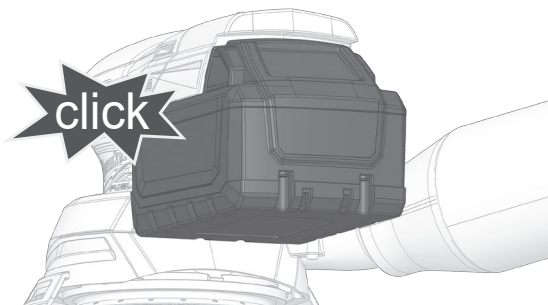

1

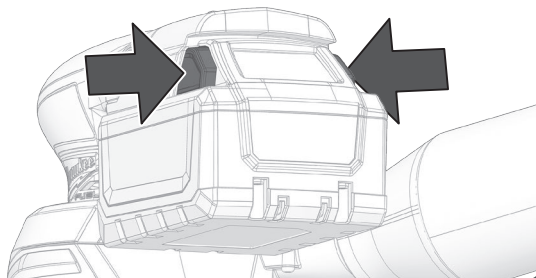

2

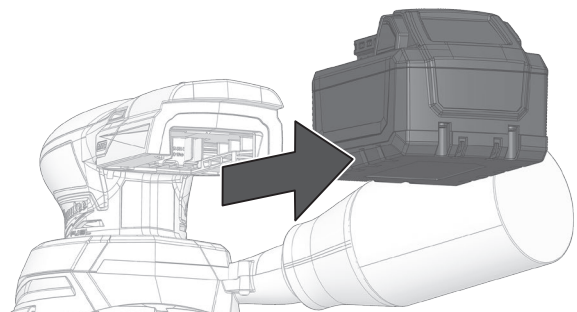

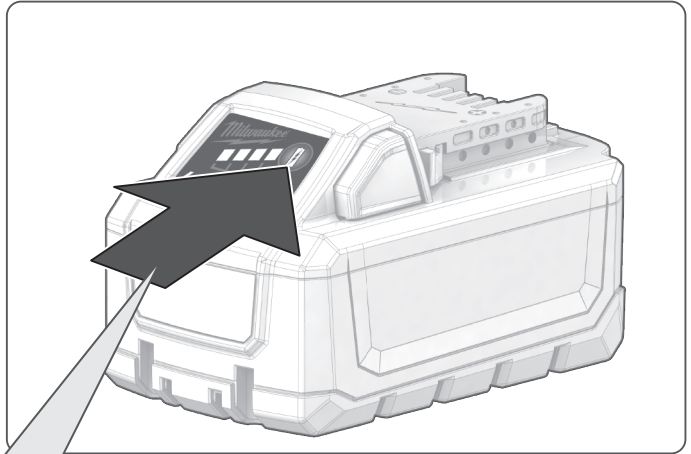

78-100 %



55-77 %



33-54 %



10-32 %



< 10 %

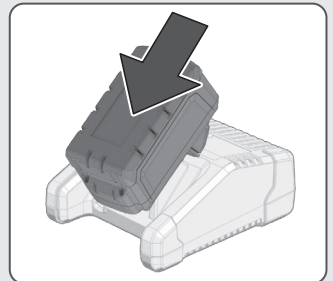
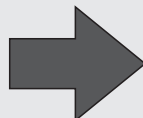

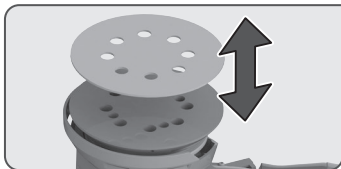

1



Hook and loop

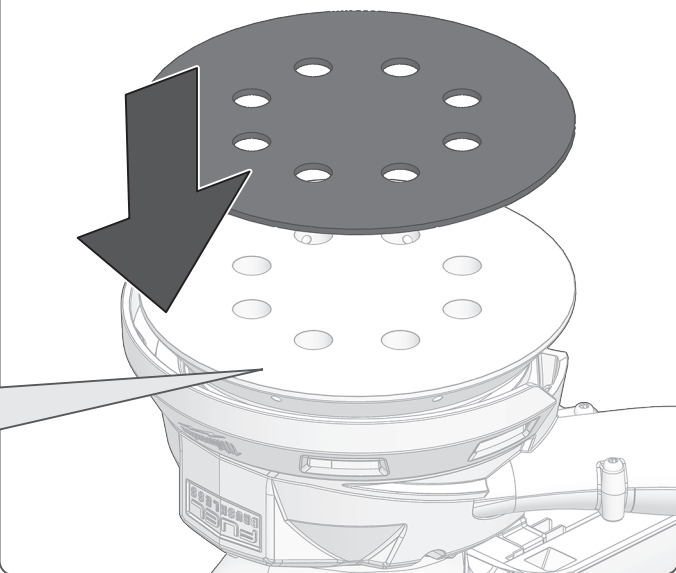

2

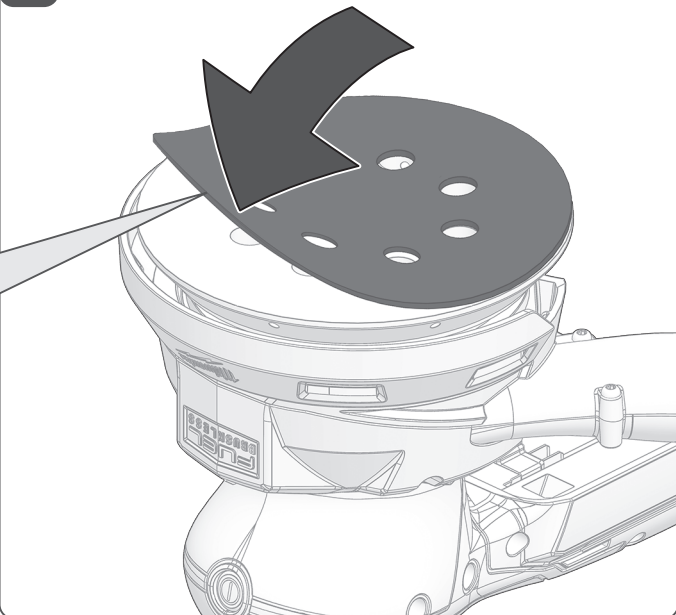
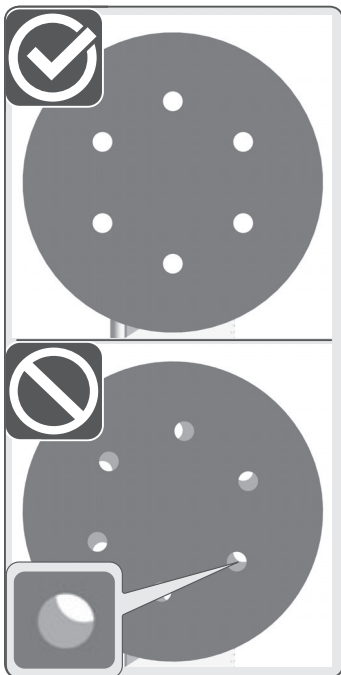

Press the fuzzy side of the sanding disc against the backing pad as carefully and firmly as possible.

盡可能穩固並小心地將磨盤的毛邊壓在墊板上。

尽可能稳固并小心地将磨盘的毛边压在包装垫上。

샌딩 디스크의 벨크로 부분을 백킹 패드에 대고 최대한 조심스럽고 단단하게 누릅니다.

กดด้านที่เป็นฝอยของแผ่นขัดเข้ากับแผ่นรองด้านหลังอย่างระมัดระวังและให้แน่นที่สุดเท่าที่จะเป็นไปได้

Tekan sisi halus disc pengamplasan ke bantalan pelapis dengan hati-hati dan sekuat mungkin.

Nhấn mặt mờ của đĩa chà nhám vào tấm lót một cách cẩn thận và chắc chắn nhất có thể.

サンディングディスクの毛羽だった取り付け面を、できるだけ丁寧にしっかりとバックングパッドに押し付けます。



# START

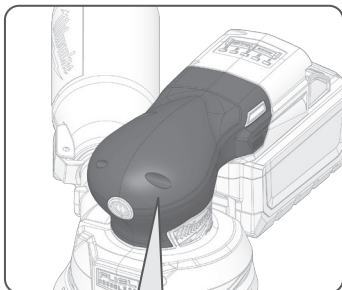

Insulated gripping surface

絶縁の把手

绝缘的把手

절연 그립 표면

พื้นผิวจับกันความร้อน

Permukaan genggam berinsulasi

Bề mặt cầm được cách điện

絶縁グリップ面

# STOP

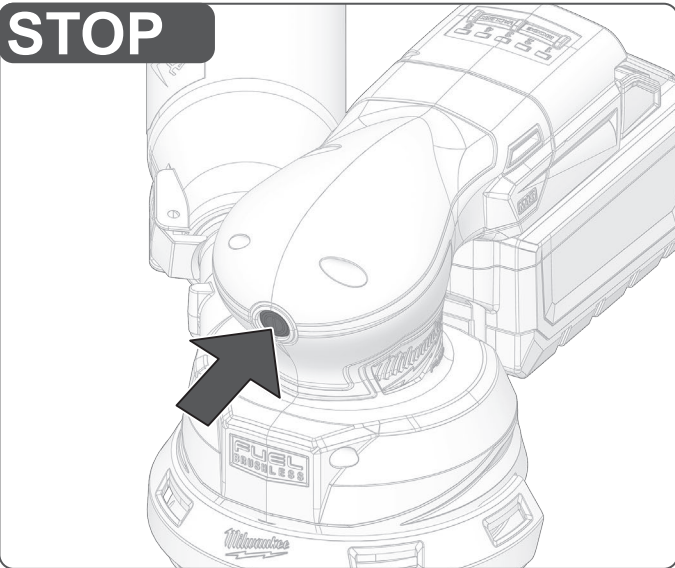



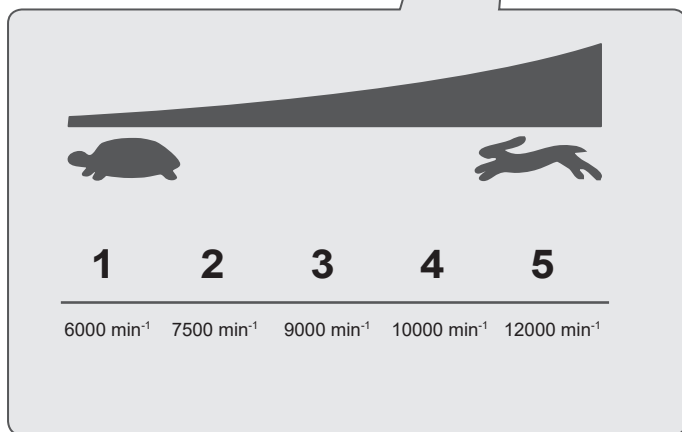
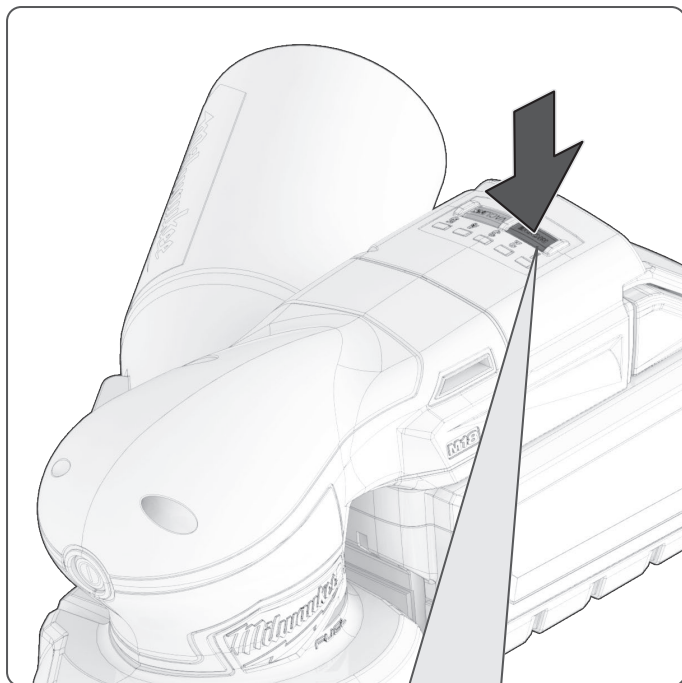

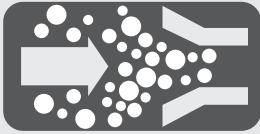

1

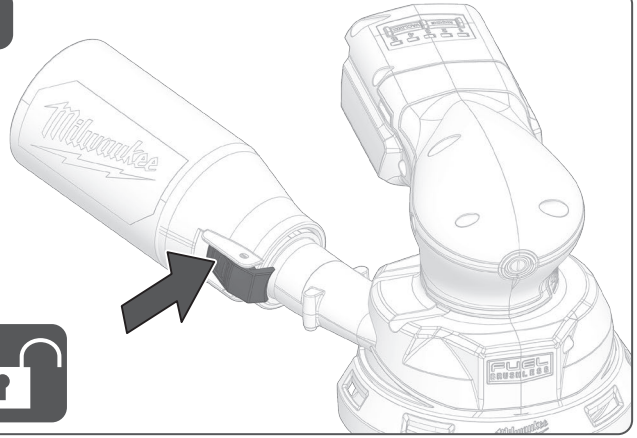

2

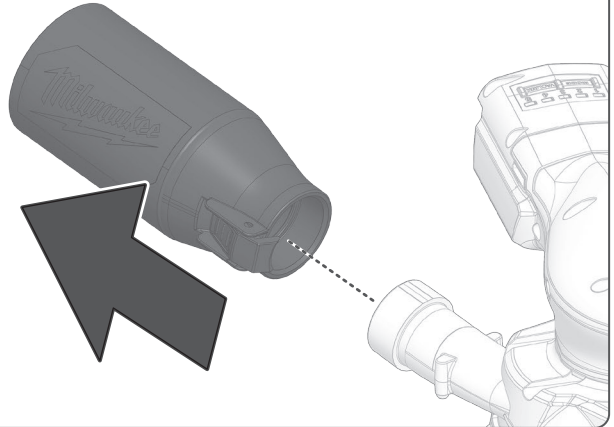

3

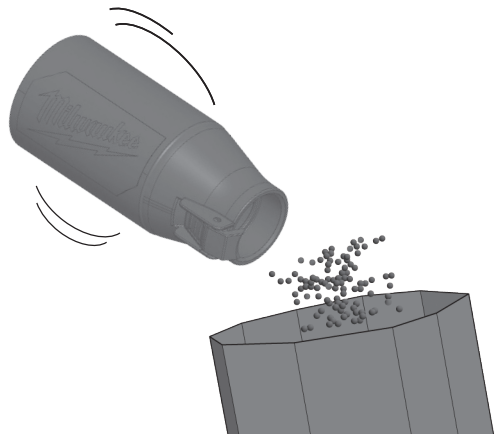

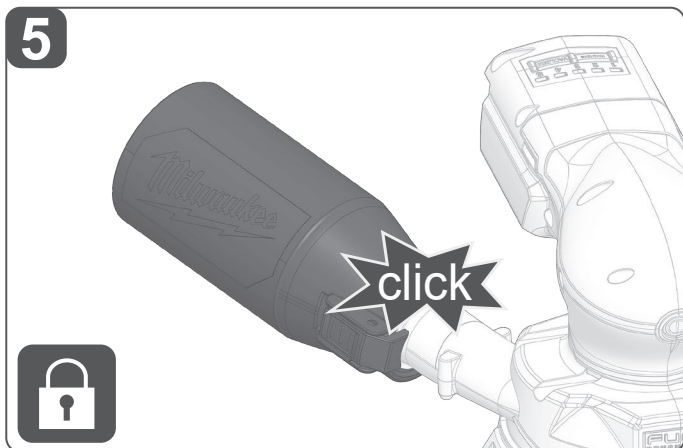
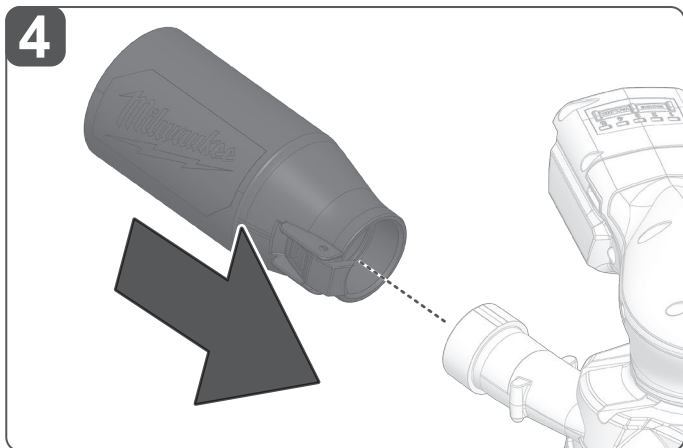

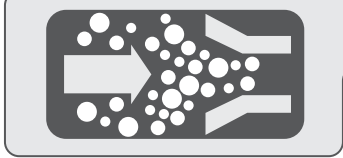

1

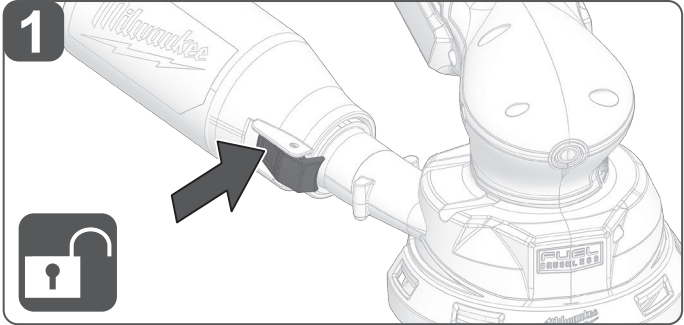

2

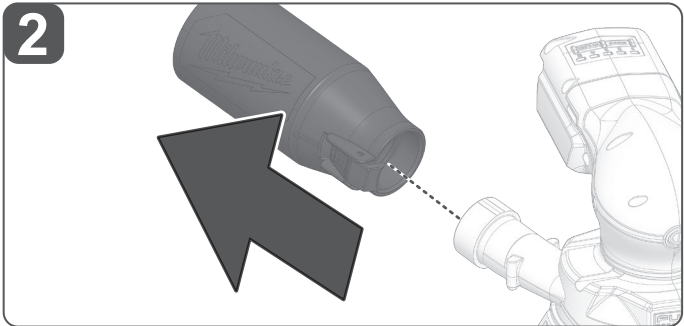

3

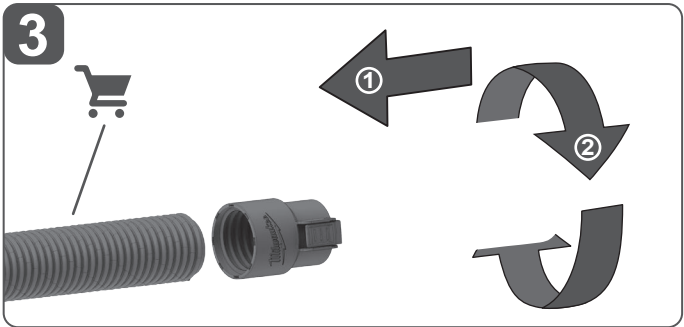

4

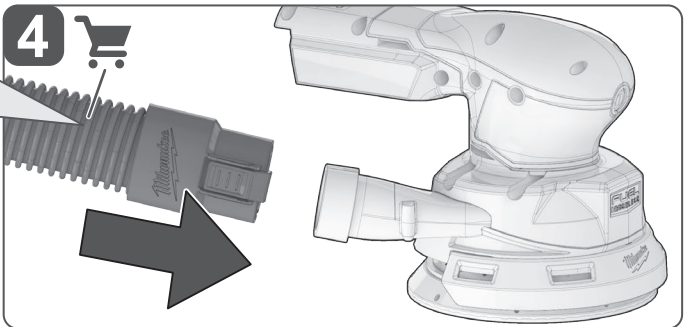

# VACLINK™



## 2

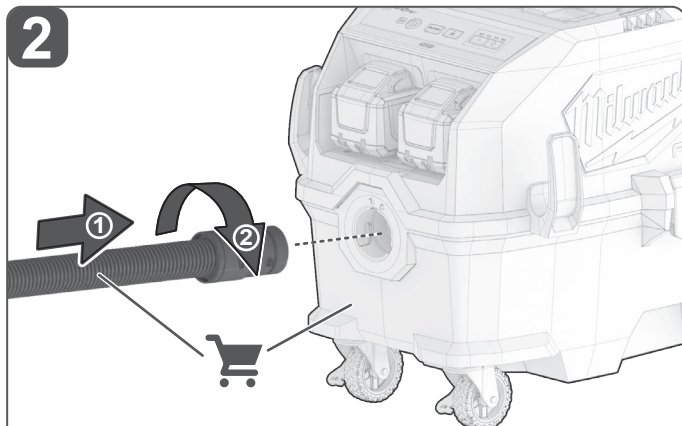

## 3

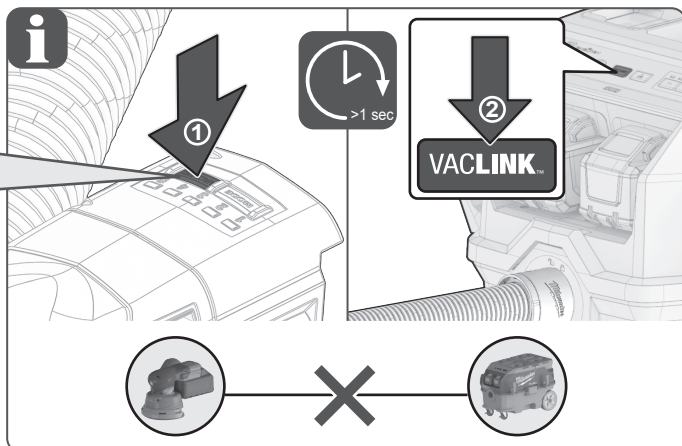
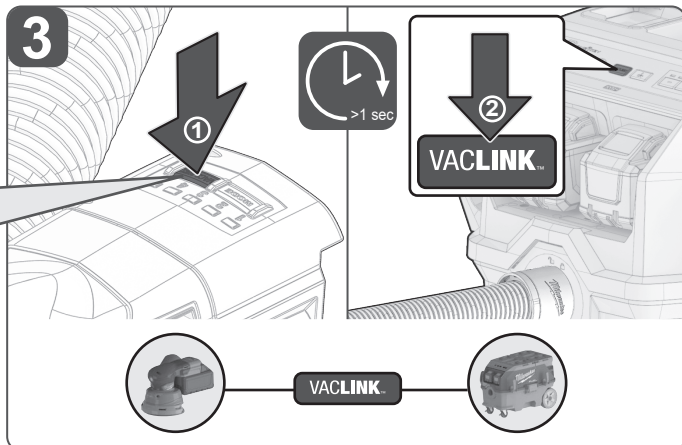

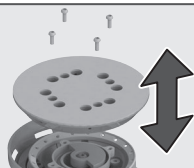

1

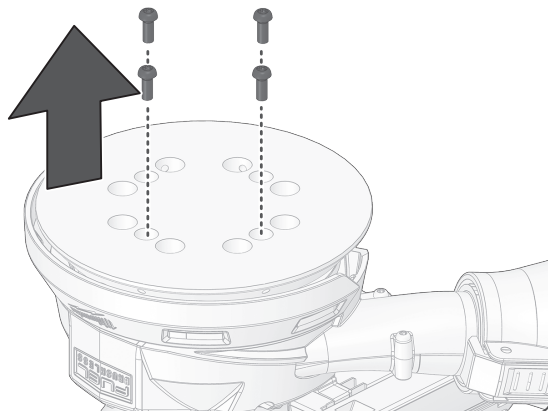

2

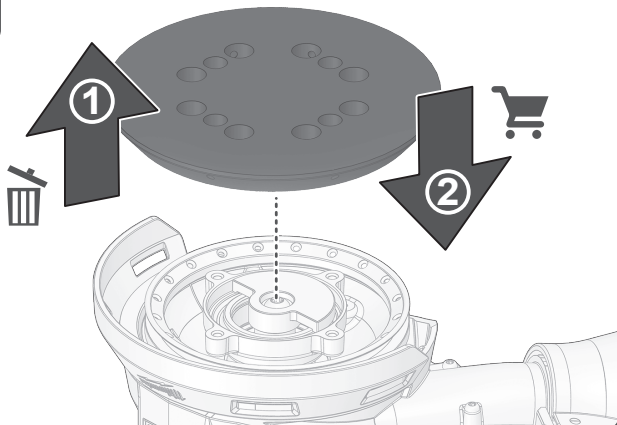

3

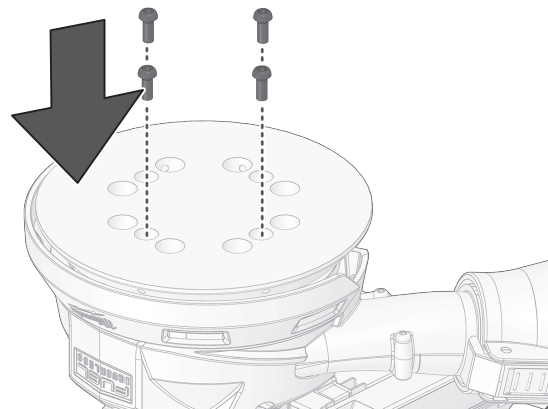

Replace the backing pad if the hook-and-loop material is worn out.

如果鉤環材料磨損，請更換墊板。

如果钩环材料磨損，請更換墊板。

훅과 루프 자재가 마모되면 백킹 패드를 교체합니다.

เปลี่ยนแผ่นรองด้านหลังหากวัสดุตะขอและห่วงสึกหรอ

Ganti bantalan pengampelasan jika material pengait dan pengikat sudah aus.

Thay tấm lót nếu vật liệu móc và vòng bị mòn.

フック面とループ面が劣化している場合は、バックングパッドを交換します。



TECHNICAL DATA	M18 FROS125
Type	Cordless random orbital sander
Battery voltage	18 V ---
Frequency band(s) of BLUETOOTH	2402-2480 MHz
No-load speed	6000–12000 min <sup>-1</sup>
No-load orbital stroke rate	12000 min <sup>-1</sup>
Orbital travel diameter	2.38 mm
Dimensions of grinding plate	125 mm
Weight without battery pack	1.45 kg
Weight according to EPTA-Procedure 01/2014 (2.0–12.0 Ah)	1.9–3.0 kg
Recommended ambient operating temperature	-18 – +50 °C
Recommended battery pack types	M18B..., M18 HB..., M18 FB...
Recommended chargers	M12-18..., M18 DFC, M18 PC6, M18 DBSC

### Noise information

Noise emission values determined according to EN 62841

A-weighted sound pressure level	81 dB(A)
Uncertainty K	3 dB(A)
A-weighted sound power level	89 dB(A)
Uncertainty K	3 dB(A)

Always wear ear protectors.

### Vibration information

Total vibration values (vector sum in the three axes) determined according to EN 62841

Vibration emission value a <sub>h</sub>	6.63 m/s <sup>2</sup>
Uncertainty K	1.5 m/s <sup>2</sup>

## WARNING!

The declared vibration total values and the declared noise emission values given in this instruction manual have been measured in accordance with a standardised test and may be used to compare one tool with another. They may be used for a preliminary assessment of exposure.

The declared vibration and noise emission values represent the main applications of the tool. However, if the tool is used for different applications, used with different accessories, or poorly maintained, the vibration and noise emission may differ. These conditions may significantly increase the exposure levels over the total working period.

An estimation of the level of exposure to vibration and noise should take into account the times when the tool is turned off or when it is running idle. These conditions may significantly reduce the exposure level over the total working period.

Identify additional safety measures to protect the operator from the effects of vibration and noise, such as maintaining the tool and the accessories, keeping the hands warm (in case of vibration), and organising work patterns.

 **WARNING! Read all safety warnings, instructions, illustrations and specifications provided with this power tool.**  
Failure to follow all instructions listed below may result in electric shock, fire, and/or serious injury.

**Save all warnings and instructions for future reference.**

### RANDOM ORBITAL SANDER SAFETY WARNINGS

Use personal protective equipment. Always wear eye protection. Protective equipment, such as a dust mask, non-skid safety shoes, hard hat or hearing protection used for appropriate conditions will reduce personal injuries.

The dust produced when using the product may be harmful to health. Do not inhale the dust. Use a dust absorption system and wear a suitable dust protection mask. Remove deposited dust thoroughly, e.g., with a dust extractor.

Remove the battery pack before starting any work on the product.

Do not use sanding paper larger than needed. Extra paper extending beyond the sanding pad can also cause serious lacerations.

Only use original MILWAUKEE sanding and polishing tools with self-adhesive hook-and-loop fastening.

Do not machine any materials that present a danger to health, such as asbestos.

Clamp the workpiece with a clamping device. Unclamped workpieces can cause severe injury and damage.

Never reach into the danger area of the product when it is running.

Do not remove chips and splinters while the product is running.

Power off the product immediately in case of considerable vibrations or if other malfunctions occur. Check the product to find out the cause.