

Calipers

ABSOLUTE Digimatic Caliper SERIES 500 — with Exclusive ABSOLUTE Encoder Technology ISO13385-1 compliant

- This is a standard digital caliper. The digital display can reduce human error by preventing incorrect reading of measurement results.
- Incorporates Mitutoyo's ABSOLUTE measurement system. No need to reset the origin after switching on. Eliminates overspeed errors.
- Carbide-tipped jaw calipers are optimal for rough finished parts, castings, grinding stones, etc.
- SPC data output models can be integrated into statistical process control and measurement systems. (Refer to page 09-3.)

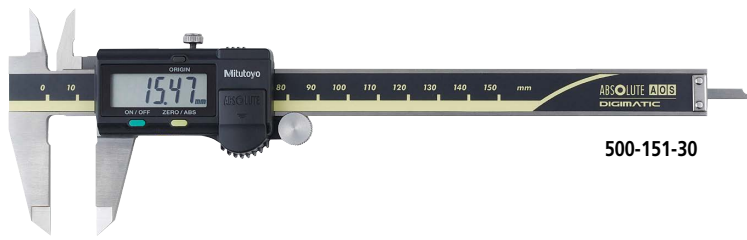

500-151-30

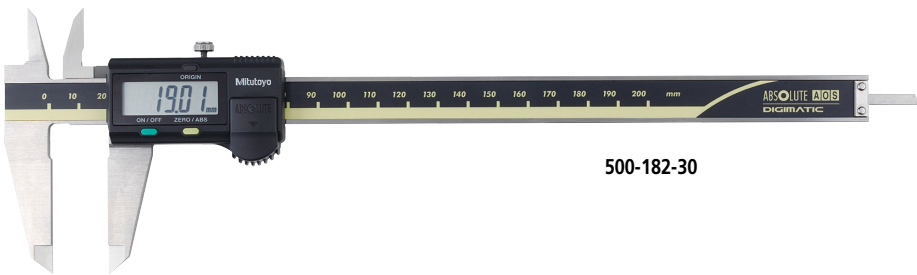

500-182-30

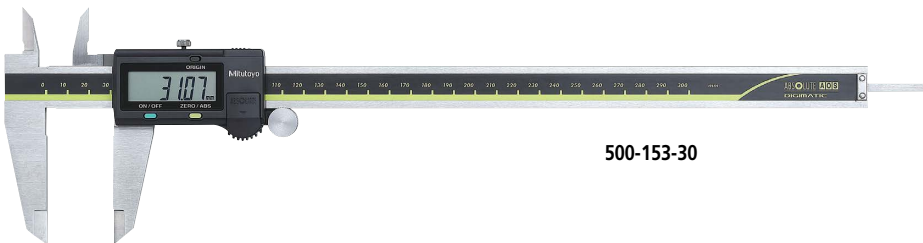

500-153-30

MeasurLink[®] ENABLED Data Management Software by Mitutoyo

U-WAVE^{fit}

ABSOLUTE[™]



Functions

- ABSOLUTE measurement: after a data is displayed, next measurement can be performed without zero-setting. Also, the ABS origin point can be changed with ORIGIN switch.
- Incremental measurement: Sets the displayed value to zero (zero-setting) at any position, making comparative measurement easier.
- Low-voltage alert: notifies that the battery is worn with "B" mark before becoming immeasurable. Thus, the timing for battery replacement can be confirmed in advance.
- Data output: Models equipped with this function have an output port for transferring measurement data to a Statistical Process Control (SPC) system.
Note: Excludes models without measurement output data port. See SPECIFICATIONS on page 04-6.
- Data hold: With the optional hold unit, the function can hold the displayed value (cannot be used with the output function).

Optional Accessories

(Note: Usable only for models with SPC data output. Refer to page 09-23 for details.)

Code No.	Type	Description
264-020	—	USB Input Tool Series USB Keyboard Signal Conversion Type IT-020U
959149	C	Connection cable for IT/DP/MUX (1 m)
959150	C	Connection cable for IT/DP/MUX (2 m)
06AFM380C	C	USB Input Tool Direct (2 m)
02AZD730G	IP67*	U-WAVE-T
02AZD880G	Buzzer	U-WAVE-T
02AZE200	—	U-WAVE-T mounting bracket
02AZD790C	C	Connection cable for U-WAVE-T (160 mm)
02AZE140C	C	Connection cable for U-WAVE-T For foot switch
264-620	IP67*	U-WAVE-TC
264-621	Buzzer	U-WAVE-TC
264-624	IP67*	U-WAVE-TCB
264-625	Buzzer	U-WAVE-TCB
02AZF300	Buzzer	Connecting unit for U-WAVE-TC/TCB

* IP67 is applied to these **U-WAVE-T/-TC/-TCB**, but not to the calipers on page 04-6 to 04-7.

Data hold unit

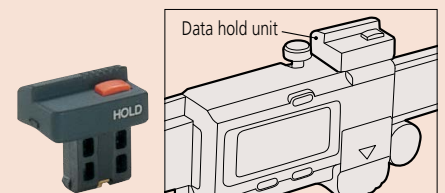

959143

NPOWER
Powered by NaviTech

Tài liệu được tổng hợp bởi đội ngũ kỹ thuật của **NPOWER**
Bản quyền nội dung thuộc về **Mitutoyo**

Powered by **NAVITECH** | www.navitech.co
www.npower.com.vn

SPECIFICATIONS

Metric										
Code No.	Range (mm)	Resolution (mm)	Maximum permissible error (mm)*		Measurement data output port	Mass (g)	Depth bar	Fine adjustment	Remarks	
			E_{MPE}	S_{MPE}						
500-150-30	0 - 100	0.01	±0.02	±0.04	✓	143	ø1.9 mm rod	with thumb roller	—	
500-180-30					—			—		
500-151-30					—			—		
500-154-30	0 - 150	0.01	±0.02	±0.04	✓	168	Blade	with thumb roller	Carbide-tipped jaws for outside measurement	
500-155-30									—	Carbide-tipped jaws for outside and inside measurement
500-158-30									—	—
500-181-30									—	—
500-152-30									—	—
500-156-30	0 - 200	0.01	±0.02	±0.04	✓	198	Blade	with thumb roller	Carbide-tipped jaws for outside measurement	
500-157-30									—	Carbide-tipped jaws for outside and inside measurement
500-182-30									—	—
500-153-30	0 - 300	0.01	±0.03	±0.05	—	350	—	with thumb roller	—	
500-161-30	0 - 150	0.01	±0.02	±0.04	✓	168	ø1.9 mm rod	—	—	
500-162-30	0 - 200	198								
500-184-30	0 - 150	—								
500-201-30	0 - 100	143								
500-203-30	0 - 150	168								
500-205-30	0 - 300	0.01	±0.03	±0.05	—	345	—	—	—	
500-233-30	0 - 150	0.01	±0.02	±0.04	✓	168	Blade	—	Carbide-tipped jaws for outside measurement	
500-234-30									—	Carbide-tipped jaws for outside and inside measurement
500-235-30									—	Carbide-tipped jaws for outside measurement
500-236-30	0 - 200	0.01	±0.02	±0.04	—	198	—	—	Carbide-tipped jaws for outside and inside measurement	

- Power source: SR44 battery (1 pc.), **938882** included as standard (for operational checks)
 - Position detection method: ABSOLUTE electromagnetic induction linear encoder
 - Battery life: Approx. 5 years under normal use
 - Response speed: Unlimited
- * The Partial Surface Contact Error (E_{MPE}) and Shift Error (S_{MPE}) are terms defined by ISO 13385-1:2019.



Tài liệu được tổng hợp bởi đội ngũ kỹ thuật của **NPOWER**
Bản quyền nội dung thuộc về **Mitutoyo**

Powered by **NAVITECH** | www.navitech.co
www.npower.com.vn

Calipers

ABSOLUTE Digimatic Caliper SERIES 500 — with Exclusive ABSOLUTE Encoder Technology

04

Calipers

Inch / Metric		Resolution	Maximum permissible error*		Measurement data output port	Mass (g)	Depth bar	Fine adjustment	Remarks
Code No.	Range		EMPE	SMPE					
500-170-30	0 - 4 in/ 0 - 100 mm	0.0005 in/ 0.01 mm	±0.001 in/ ±0.02 mm	±0.002 in/ ±0.04 mm	✓	143	ø0.075 inch rod	—	
500-195-30									—
500-171-30	0 - 6 in/ 0 - 150 mm	0.0005 in/ 0.01 mm	±0.001 in/ ±0.02 mm	±0.002 in/ ±0.04 mm	✓	168	Blade	with thumb roller	Carbide-tipped jaws for outside measurement
500-174-30									Carbide-tipped jaws for outside and inside measurement
500-175-30									—
500-178-30									—
500-196-30									Carbide-tipped jaws for outside measurement
500-159-30									Carbide-tipped jaws for outside and inside measurement
500-160-30									—
500-191-30									—
500-202-30									—
500-172-30									0 - 8 in/ 0 - 200 mm
500-176-30	Carbide-tipped jaws for outside and inside measurement								
500-177-30	—								
500-197-30	Carbide-tipped jaws for outside measurement								
500-163-30	Carbide-tipped jaws for outside and inside measurement								
500-164-30	—								
500-204-30	—								
500-173-30	Carbide-tipped jaws for outside measurement								
500-167-30	Carbide-tipped jaws for outside and inside measurement								
500-168-30	—								
500-193-30	0 - 12 in/ 0 - 300 mm	0.0005 in/ 0.01 mm	±0.0015 in/ ±0.03 mm	±0.0025 in/ ±0.05 mm	✓	350	with thumb roller	with thumb roller	Carbide-tipped jaws for outside measurement
500-165-30									Carbide-tipped jaws for outside and inside measurement
500-165-30									—
500-166-30									Carbide-tipped jaws for outside and inside measurement

- Power source: SR44 battery (1 pc.), **938882** included as standard (for operational checks)
- Position detection method: ABSOLUTE electromagnetic induction linear encoder
- Battery life: Approx. 5 years under normal use
- Response speed: Unlimited
- * The Partial Surface Contact Error (EMPE) and Shift Error (SMPE) are terms defined by ISO 13385-1:2019.



Tài liệu được tổng hợp bởi đội ngũ kỹ thuật của **NPOWER**
Bản quyền nội dung thuộc về **Mitutoyo**

Powered by **NAVITECH** | www.navitech.co
www.npower.com.vn

DIMENSIONS

Unit: mm

With thumb roller

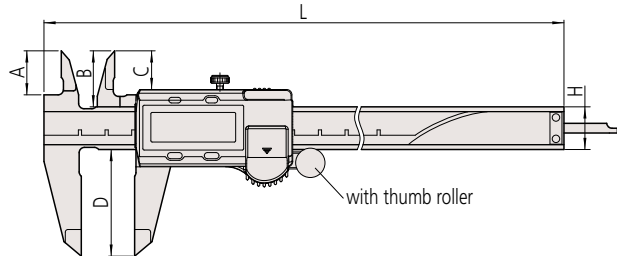

Without thumb roller

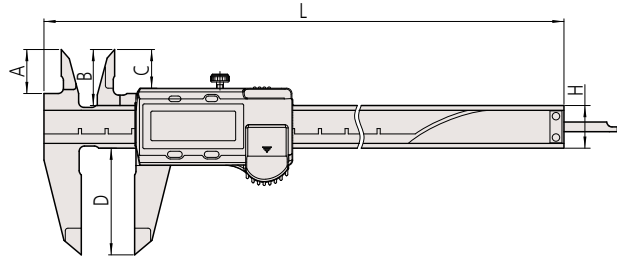

Range (mm)	A	B	C	D	H	L
0 - 100	16.5	21	14.5	40	16	182
0 - 150						233
0 - 200	20	24.5	18	50		290
0 - 300	22	27.5	19.8	64	20	404

Jaw thickness: 3.5 mm for 0 to 100 mm/0 to 150 mm/0 to 200 mm models and 3.8 mm for 0 to 300 mm model



Tài liệu được tổng hợp bởi đội ngũ kỹ thuật của **NPOWER**
Bản quyền nội dung thuộc về **Mitutoyo**

Powered by **NAVITECH** | www.navitech.co

www.npower.com.vn