

CIRCUIT BEVELER

Model **CBR-03**

For Bridge and Shipbuilding Applications



Bridge

- Radius chamfering on the scallop parts or holes of bridge members

Shipbuilding

- Meets or exceeds PSPC* requirements on surface preparation of steel materials prior to coating
- Radius chamfering on steel materials used in seawater ballast tanks and double-side skin bulk carrier production
- Dual cutting head with 4 radius surfaces per tip and a quick-change base
- Lightweight and compact weighing only 2.2 kg
- Designed to increase tool life with easier operation

* PSPC stands for Performance Standard for Protective Coatings regulated by International Marine Organization.



Three handle position options

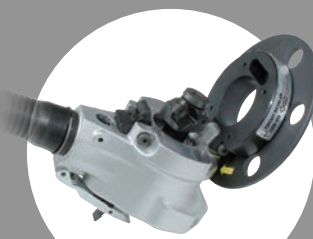

Quick and easy insert change

Specifications

| | | |
|---|---------------------|--|
| Model | | CBR-03 |
| Air Pressure | MPa | 0.6 |
| Air Consumption (No load) | m ³ /min | 0.65 |
| Free Speed | min ⁻¹ | 12,000 |
| Chamfering Capacity | mm | 3R |
| Minimum Hole Required | mm | 22 |
| Minimum Radius | mm | 12.5R |
| Minimum Depth (When a steel material is placed horizontally) | mm | 9 |
| Number of Dedicated Insert | | 2 pcs |
| Mass (Weight) | kg | 2.2 (including hose) |
| Standard Accessories | | 3R Insert: 2 pcs. (Installed) Torx Driver: 1 pc. Insert Setscrew: 1 pc. Handle: 1 pc. |
| Optional Accessory | | Plate ass'y for straight line use |

Dimensions

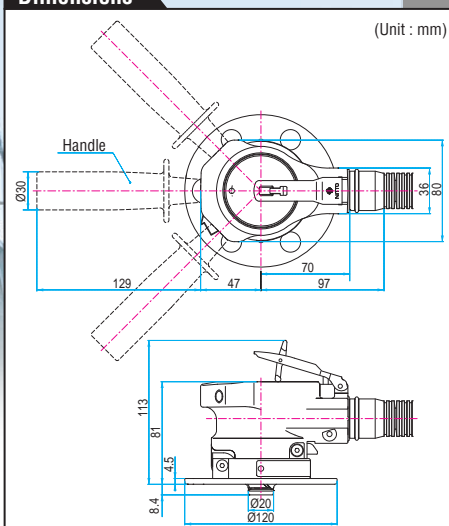

For sharp edge removal

★ Specifications and designs are subject to change at any time without notice.



Head Office
9-4, Nakaikegami 2-chome,
Ohta-ku, Tokyo 146-8555 Japan
Phone : +81-3-3755-1111 Fax : +81-3-3753-8791

▶ URL : www.nitto-kohki.co.jp/e
▶ E-mail : overseas@nitto-kohki.co.jp

DISTRIBUTED BY

www.npower.com.vn

Tài liệu được tổng hợp bởi đội ngũ kỹ thuật của **NPOWER**
Bản quyền nội dung thuộc về **NITTO KOHKI**

