

PJA-75

PNAJA-75

Size 	Model Number	Wheel	Bearing	Load Capacity		Tire Width R	Shaft Diameter D	Overall Height H1	Plate Size F1/F2	Mounting Hole Spacing P1/P2	Plate Hole d	Offset E	Weight (g)	
				(daN)	(kgf)									
75	■Nylon													
	PJA-75	Nylon		100	102.0									420
	PBJA-75	Nylon	B/B	120	122.4	32	10	101	82/82	63/63	9.5	22	480	
	PBDJA-75	Nylon	SUS										480	
	■Nylon Rim · Rubber Wheel													
	PNJA-75	Rubber	B/B											510
	PNDJA-75	Rubber	SUS	70	71.4	32	10	101	82/82	63/63	9.5	22	510	
	PNAJA-75	Rubber												470
	■Nylon Rim · Urethane Rubber Wheel													
	PNUJA-75	Urethane	B/B											500
	PNUDJA-75	Urethane	SUS	100	102.0	32	10	101	82/82	63/63	9.5	22	500	
	PNUAJA-75	Urethane		70	71.4									450
	■Monomer Cast Nylon													
	UWBJA-75	MC Nylon	B/B											520
	UWBDJA-75	MC Nylon	SUS			24								520
	UWAJA-75	MC Nylon		150	153.0	10	101	82/82	63/63	9.5	22			480
	UWBSJA-75	MC Nylon	B/B											500
	UWBSDJA-75	MC Nylon	SUS			26								500
	■Steel Rim · Rubber Wheel <i>Wheel rim is not stainless steel.</i>													
	SJA-75	Rubber	B/B		80	81.6								530
	SRJA-75	Red Rubber	B/B		60	61.2	32	10	101	82/82	63/63	9.5	22	530
	CRJA-75	Heat-resistance	B/B		80	81.6								550
	■Steel Rim · Urethane Rubber Wheel <i>Wheel rim is not stainless steel.</i>													
SUIJA-75	Urethane	B/B											610	
SUIEJA-75	Anti-Static	B/B	120	122.4	32	10	101	82/82	63/63	9.5	22		610	

Bearing: No mark -- Spindle sleeve, B/B -- Steel bearing, SUS -- Stainless steel bearing

Build-to-order manufacturing

●The materials of JA Type bracket are all stainless steel (SUS 304 / 18-8 stainless).

JA Type

Size: 100mm

Stainless Steel Swivel Bracket



PJA-100

PNAJA-100

Unit: mm

Size 	Model Number	Wheel	Bearing	Load Capacity		Tire Width R	Shaft Diameter D	Overall Height H1	Plate Size F1/F2	Mounting Hole Spacing P1/P2	Plate Hole d	Offset E	Weight (g)	
				(daN)	(kgf)									
100	■ Nylon													
	PJA-100	Nylon		120	122.4									870
	PBJA-100	Nylon	B/B	180	183.6	35	12	144	95/95	71/71	11	35	930	
	PBDJA-100	Nylon	SUS										930	
	■ Nylon Rim · Rubber Wheel													
	PNJA-100	Rubber	B/B											970
	PNDJA-100	Rubber	SUS	100	102.0	32	12	144	95/95	71/71	11	35	970	
	PNAJA-100	Rubber												910
	■ Nylon Rim · Urethane Rubber Wheel													
	PNUJA-100	Urethane	B/B	150	153.0	32	12	144	95/95	71/71	11	35	950	
	PNUDJA-100	Urethane	SUS											950
	PNUAJA-100	Urethane		100	102.0									890
	■ Monomer Cast Nylon													
	UWBJA-100	MC Nylon	B/B											1,080
	UWBDJA-100	MC Nylon	SUS			29								1,080
	UWAJA-100	MC Nylon		200	204.0		12	144	95/95	71/71	11	35	1,030	
	UWBSJA-100	MC Nylon	B/B											1,030
	UWBSDJA-100	MC Nylon	SUS			30								1,030
	■ Steel Rim · Rubber Wheel Wheel rim is not stainless steel.													
	SJA-100	Rubber	B/B	130	132.6									1,070
	SRJA-100	Red Rubber	B/B	100	102.0	35	12	144	95/95	71/71	11	35	1,070	
CRJA-100	Heat-resistance	B/B	130	132.6									1,100	
■ Steel Rim · Urethane Rubber Wheel Wheel rim is not stainless steel.														
SUIJA-100	Urethane	B/B											1,140	
SUIEJA-100	Anti-Static	B/B	180	183.6	32	12	144	95/95	71/71	11	35	1,140		

Bearing: No mark -- Spindle sleeve, B/B -- Steel bearing, SUS -- Stainless steel bearing

Build-to-order manufacturing

● The materials of JA Type bracket are all stainless steel (SUS 304 / 18-8 stainless).

Stainless Steel Caster Series

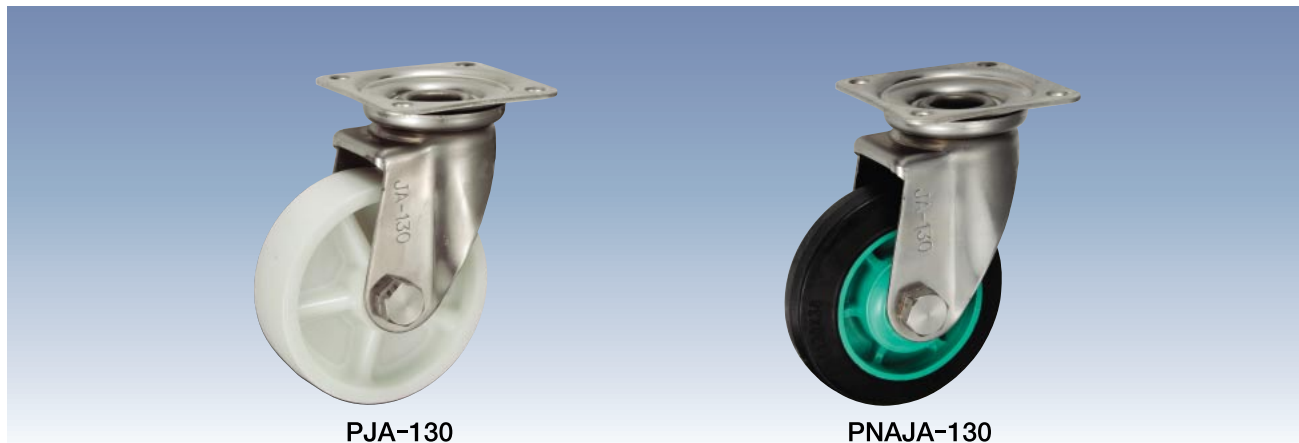

PJA-130

PNAJA-130

Size 	Model Number	Wheel	Bearing	Load Capacity		Tire Width R	Shaft Diameter D	Overall Height H1	Plate Size F1/F2	Mounting Hole Spacing P1/P2	Plate Hole d	Offset E	Weight (g)	
				(daN)	(kgf)									
130	■ Nylon													
	PJA-130	Nylon		150	153.0	42	20	177	108/108	80/80	11	40	1,400	
	PBJA-130	Nylon	B/B	250	255.0								1,600	
	PBDJA-130	Nylon	SUS										1,600	
	■ Nylon Rim-Rubber Wheel													
	PNJA-130	Rubber	B/B	145	147.9	38	20	177	108/108	80/80	11	40	1,660	
	PNDJA-130	Rubber	SUS										1,660	
	PNAJA-130	Rubber		120	122.4								1,470	
	■ Nylon Rim-Urethane Rubber Wheel													
	PNUJA-130	Urethane	B/B	200	204.0	35	20	177	108/108	80/80	11	40	1,600	
	PNUDJA-130	Urethane	SUS										1,600	
	PNUAJA-130	Urethane		120	122.4								1,410	
	■ Monomer Cast Nylon													
	UWBJA-130	MC Nylon	B/B	300	306.0	36	20	177	108/108	80/80	11	40	1,880	
	UWBDJA-130	MC Nylon	SUS										1,880	
	UWAJA-130	MC Nylon											1,730	
	UWBSJA-130	MC Nylon	B/B			30							1,620	
	UWBSDJA-130	MC Nylon	SUS										1,620	
	■ Steel Rim-Rubber Wheel Wheel rim is not stainless steel.													
	SJA-130	Rubber	B/B	180	183.6	42	20	177	108/108	80/80	11	40	1,860	
SRJA-130	Red Rubber	B/B	140	142.8	1,860									
CRJA-130	Heat-resistance	B/B	180	183.6	1,890									
■ Steel Rim-Urethane Rubber Wheel Wheel rim is not stainless steel.														
SUIJA-130	Urethane	B/B	250	255.0	35	20	177	108/108	80/80	11	40	1,990		
SUIEJA-130	Anti-Static	B/B										1,990		

Unit: mm

Bearing: No mark -- Spindle sleeve, B/B -- Steel bearing, SUS -- Stainless steel bearing

 Build-to-order manufacturing

● The materials of JA Type bracket are all stainless steel (SUS 304 / 18-8 stainless).

JA Type

Size: 150mm

Stainless Steel Swivel Bracket



PJA-150



PNAJA-150

Stainless Steel Caster Series

Unit: mm

Size 	Model Number	Wheel	Bearing	Load Capacity		Tire Width R	Shaft Diameter D	Overall Height H1	Plate Size F1/F2	Mounting Hole Spacing P1/P2	Plate Hole d	Offset E	Weight (g)	
				(daN)	(kgf)									
150	■ Nylon													
	PJA-150	Nylon		180	183.6									1,880
	PBJA-150	Nylon	B/B	300	306.0	45	20	198	120/120	90/90	11	45	2,120	
	PBDJA-150	Nylon	SUS										2,120	
	■ Nylon Rim · Rubber Wheel													
	PNJA-150	Rubber	B/B											2,140
	PNDJA-150	Rubber	SUS			38	20	198	120/120	90/90	11	45	2,140	
	PNAJA-150	Rubber		140	142.8									1,980
	■ Nylon Rim · Urethane Rubber Wheel													
	PNUJA-150	Urethane	B/B											2,100
	PNUDJA-150	Urethane	SUS	250	255.0	38	20	198	120/120	90/90	11	45	2,100	
	PNUAJA-150	Urethane		150	153.0									1,910
	■ Monomer Cast Nylon													
	UWBJA-150	MC Nylon	B/B											2,560
	UWBDJA-150	MC Nylon	SUS			40								2,560
	UWAJA-150	MC Nylon		350	357.0		20	198	120/120	90/90	11	45	2,410	
	UWBSJA-150	MC Nylon	B/B											2,160
	UWBSDJA-150	MC Nylon	SUS			30								2,160
	■ Steel Rim · Rubber Wheel Wheel rim is not stainless steel.													
	SJA-150	Rubber	B/B	200	204.0									2,430
	SRJA-150	Red Rubber	B/B	160	163.2	45	20	198	120/120	90/90	11	45	2,430	
CRJA-150	Heat-resistance	B/B	200	204.0									2,470	
■ Steel Rim · Urethane Rubber Wheel Wheel rim is not stainless steel.														
SUIJA-150	Urethane	B/B											2,620	
SUIEJA-150	Anti-Static	B/B	300	306.0	38	20	198	120/120	90/90	11	45	2,620		

Bearing: No mark -- Spindle sleeve, B/B -- Steel bearing, SUS -- Stainless steel bearing









Build-to-order manufacturing

● The materials of JA Type bracket are all stainless steel (SUS 304 / 18-8 stainless).

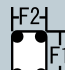
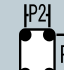

PJA-200

PNAJA-200

Size 	Model Number	Wheel	Bearing	Load Capacity		Tire Width R 	Shaft Diameter D 	Overall Height H1 	Plate Size F1/F2 	Mounting Hole Spacing P1/P2 	Plate Hole d 	Offset E 	Weight (g) 	
				(daN)	(kgf)									
200	■ Nylon													
	PJA-200	Nylon		250	255.0	45	20	250	140/140	112/112	11	58	2,910	
	PBJA-200	Nylon	B/B	400	408.0								3,120	
	PBDJA-200	Nylon	SUS										3,120	
	■ Nylon Rim · Rubber Wheel													
	PNJA-200	Rubber	B/B	220	224.4	42	20	250	140/140	112/112	11	58	3,190	
	PNDJA-200	Rubber	SUS										3,190	
	PNAJA-200	Rubber											160	163.2
	■ Nylon Rim · Urethane Rubber Wheel													
	PNUJA-200	Urethane	B/B	350	357.0	42	20	250	140/140	112/112	11	58	3,060	
	PNUDJA-200	Urethane	SUS										3,060	
	PNUAJA-200	Urethane											250	255.0
	■ Monomer Cast Nylon													
	UWBJA-200	MC Nylon	B/B	500	510.0	42	20	250	140/140	112/112	11	58	4,070	
	UWBDA-200	MC Nylon	SUS										4,070	
	UWAJA-200	MC Nylon											3,920	
	UWBSJA-200	MC Nylon	B/B										3,530	
	UWBSDJA-200	MC Nylon	SUS			34	3,530							
	■ Steel Rim · Rubber Wheel <i>Wheel rim is not stainless steel.</i>													
	SJA-200	Rubber	B/B	250	255.0	45	20	250	140/140	112/112	11	58	3,840	
SRJA-200	Red Rubber	B/B	200	204.0	3,840									
SHJA-200	High-Rebound	B/B	250	255.0	3,840									
CRJA-200	Heat-resistance	B/B			3,920									
■ Steel Rim · Urethane Rubber Wheel <i>Wheel rim is not stainless steel.</i>														
SUIJA-200	Urethane	B/B	400	408.0	42	20	250	140/140	112/112	11	58	4,010		
SUIEJA-200	Anti-Static	B/B										4,010		

Unit: mm

Bearing: No mark -- Spindle sleeve, B/B -- Steel bearing, SUS -- Stainless steel bearing

 Build-to-order manufacturing

● The materials of JA Type bracket are all stainless steel (SUS 304 / 18-8 stainless).

JA Type



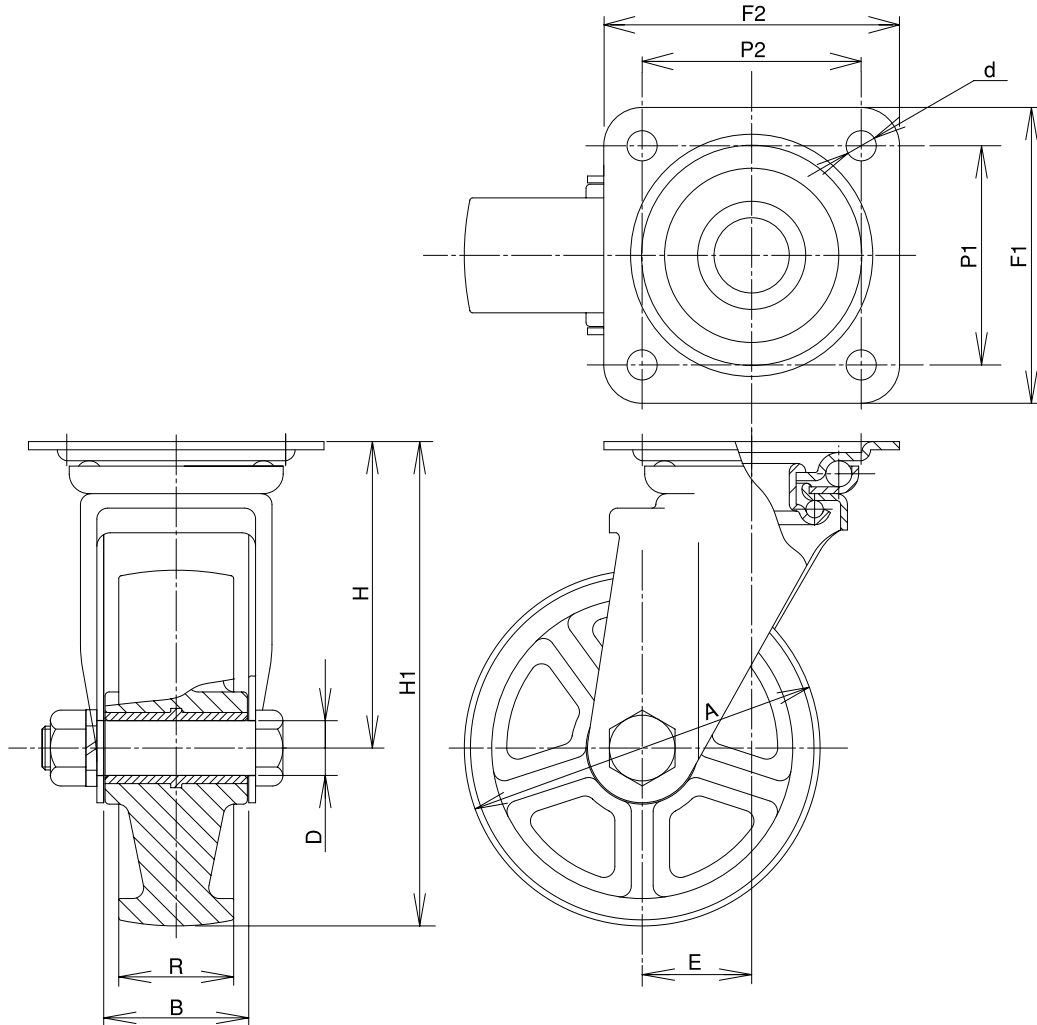

Stainless Steel Swivel Bracket



Stainless Steel Caster Series

【Bracket Dimensions】

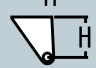
Unit: mm

Size 	Load Capacity 		Bracket Height H 	Bracket Width B 	Weight (g) 
	(daN)	(kgf)			
75	150	153.0	63	40	330
100	200	204.0	94	43	710
130	300	306.0	112	53	1,080
150	350	357.0	123	56	1,470
200	500	510.0	150	56	2,170

* The shaft set is included in the bracket.

Notice

The materials of JA Type bracket are all stainless steel, but the following wheels are not stainless steel. In addition, stainless steel bearings cannot be set.

Please be careful when selecting a caster.

Steel Rim • Rubber Wheel (S, SR, SH, CR Type)

Steel Rim • Urethane Wheel (SUI, SUIE Type)